

P.C. LAYOUT

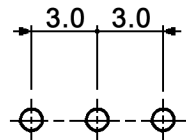

Specifications:

- Contact rating: 0.3A, 125V AC
- Contact resistance: 20mOhm max.
- Insulation resistance: 100MOhm min. at 500V DC
- Dielectric strength: 500V AC for 1 minute
- Mechanical life: 10 000 cycles
- Operating force: 350 +/-200gf
- Soldering conditions: 260 +/-5°C, 5sec.
- Timing: non-shorting
- Material:
 - Frame: SPCC-SD (t=0.5), zinc plated
 - Slider: PBT
 - Stator: XPC 94HB (t=1.2)
 - Terminal: BSR-EH (t=0.5), silver plated
 - Contact: BSR, silver plated
 - Spring: SWC, tempering
 - Leaf spring: PBS



Tolerances: ±0.3mm	Date	Name
	07/08	dr
Revised	02/11	dr
Modifications	Date	Name

MFP 191 D

knitter-switch

30 15 49

Page

1/1