

# 8800 Thinline Rocker Switches 10A 250Vac



- ▶ Ultra thin rocker switch
- ▶ Ratings up to 15A, 250Vac
- ▶ Single and twin gang
- ▶ Panel cut out:  
Single 17.4 x 6.8  
Twin 17.4 x 13.4



10(6)A 250Vac T100  
6(2)A 250Vac T100 5E4 (50,000 Operations)  
Inrush 50A to EN60065:1998



UL CSA 15A 250Vac (Twin unit is 10A 250Vac)  
UL CSA 125Vac 1/2hp  
UL 100°C, file E45221, CSA file LR10990



RoHS compliant

3mm contact gap.  
Technical data on pages 4 & 5.

rocker switches

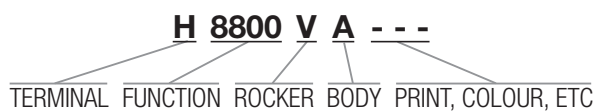

▶ TERMINAL	▶ FUNCTION		▶ ROCKER
<p><b>H</b></p> <p>4.8 x 0.8</p>		<p>Switches are ON when pressed over terminal 1</p>	<p><b>V</b> Curved</p>
	<b>8800</b>	<p>ON - OFF Single pole</p>	
<p><b>T</b></p> <p>3.5 x 0.8 Solder</p>		<p>Switches are ON when pressed over terminals 1 or 3</p>	
	<b>8800/8800</b>	<p>ON - OFF Twin (Single pole)</p>	
<p><b>X</b></p> <p>0.8Sq Solder *</p> <p>*Available for single switch only, not twin</p>			



X8800VA ---



H8800VA ---  
T8800VA ---



H8800VA ---  
T8800VA ---



H8800V/H8800VA  
T8800V/T8800VA



H8800V/H8800VA  
T8800V/T8800VA

**BODY**

**A Single pole**

Panel cut-out      Bezel

\*Optional profile for orientation

**A Single pole - Twin**

Panel cut-out      Bezel

\*Optional profile for orientation

Panel thickness	Dim X
0.75-1.24	19.1/19.2
1.25-1.99	19.3/19.4
2.00-3.00	19.7/19.8

Cut-outs must be punched in the direction of insertion

**OPTIONS**

**Finish**  
Matt finish only.

**Colour**  
Call sales for custom colours.  
A full range is available for large orders.

**Legend printing**  
Select from the examples or call sales for custom legends.

**Dimensions (mm)**

**8800VA** (H terminals shown)

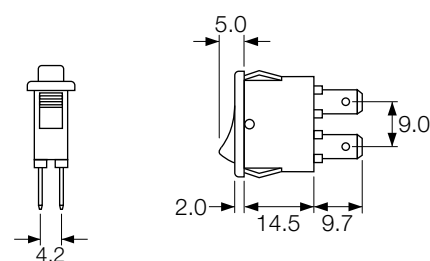

**8800V/8800VA** (H terminals shown)

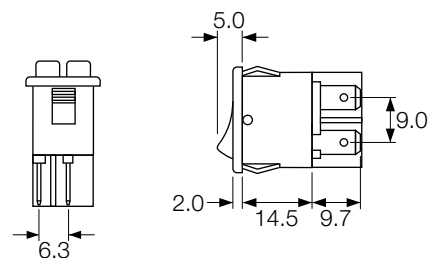

**Examples of printing**



CL132



CL133