

# 2: Assembly Material



## 2.1 Front Panel Screws M2.5

E | 2\_3

---

---

---

---



## 2.2 Miscellaneous Screws

E | 2\_5

---

---

---

---



## 2.3 Earthing Screws

E | 2\_7

---

---

---

---



## 2.4 Self-Tapping Screws

E | 2\_8

---

---

---

---



## 2.5 PT Screws

E | 2\_8

---

---

---

---

---



## 2.6 Sheet Metal Screws

E | 2\_8

---

---

---

---



## 2.7 Threaded Bolts

E | 2\_8

---

---

---

---



## 2.8 Set Screws

E | 2\_8

---

---

---

---

---

---

---

---

E



# 2: Assembly Material



## 2.1 Front Panel Screws M2.5

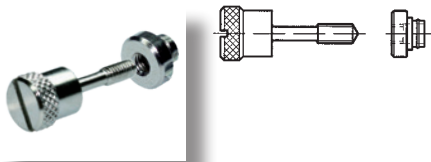

### 2.1.1 Milled Edge Screw Slotted, Head Ø 7, Press-Fit Bush

Description	Material	Part-No.
M2.5 x 11.3	Steel, nickel-plated	10 pcs. 63-443

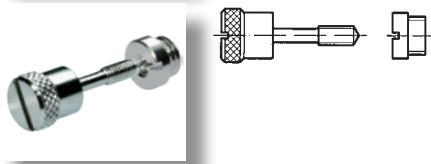

### 2.1.2 Milled Edge Screw Slotted, Head Ø 7, Threaded Bush

Description	Material	Part-No.
M2.5 x 11.3; M2.5/M5 x 0.5	Steel/brass, nickel-plated	10 pcs. 63-130

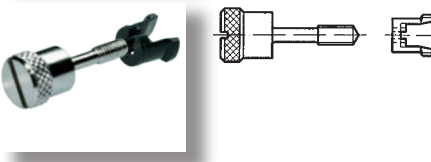

### 2.1.3 Milled Edge Screw Slotted, Head Ø 7, Retainer

Description	Material	Part-No.
M2.5 x 11.3	Steel, nickel-plated / plastic	10 pcs. 63-157

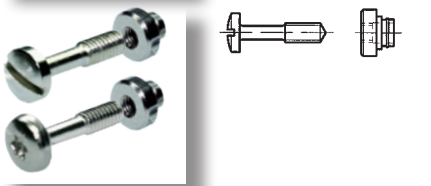

### 2.1.4 Round Head Screw, Head Ø 5 (Torx Ø 6), Press-Fit Bush

Description	Material	Part-No.
Slotted, M2.5 x 11.3	Steel, nickel-plated	10 pcs. 63-444
Torx, M2.5 x 11.3, size T8	Steel, nickel-plated	63K480

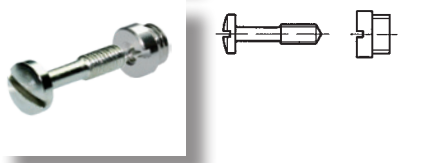

### 2.1.5 Round Head Screw Slotted, Head Ø 5, Threaded Bush

Description	Material	Part-No.
M2.5 x 11.3; M2.5/M5 x 0.5	Steel/brass, nickel-plated	10 pcs. 63-129

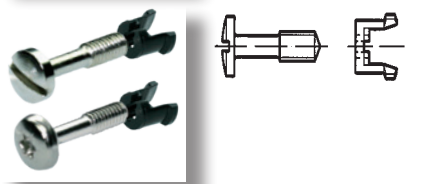

### 2.1.6 Round Head Screw, Head Ø 5 (Torx Ø 6), Retainer

Description	Material	Part-No.
Slotted M2.5 x 11.3	Steel, nickel-plated / plastic	10 pcs. 63-159
Torx, M2.5 x 11.3, size T8	Steel, nickel-plated / plastic	63K159

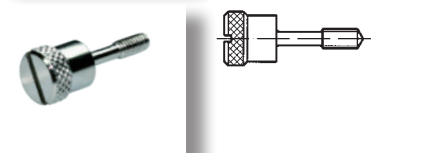

### 2.1.7 Milled Edge Screw Slotted, Head Ø 7

Description	Material	Part-No.
M2.5 x 11.3	Steel, nickel-plated	61-267
M2.5 x 11.3	Steel, nickel-plated, black	61-267-01

## 2: Assembly Material

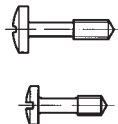

### 2.1.8 Round Head Screw Slotted, Head Ø 5

Description	Material	Part-No.
M2.5 x 9	Steel, nickel-plated	61-252
M2.5 x 11.3	Steel, nickel-plated	61-256

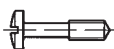

### 2.1.9 Round Head Screw, Head Ø 6

Description	Material	Part-No.
Philips M2.5 x 12.7	Steel, nickel-plated	61-287
Philips M2.5 x 12.7	Steel, nickel-plated, black	61-294
Torx M2.5 x 11.3, size T8	Steel, nickel-plated	5443-08
Freedrive M2.5 x 11.3	Steel, nickel-plated	61-295
Freedrive M2.5 x 11.3	Steel, nickel-plated, black	61-295-01



### 2.1.10 Press-Fit Bush, Drilling Ø 3.7<sup>+0.11</sup> 0

Description	Material	Part-No.
M2.5 Mat. ≥ 2.5 mm	Steel, nickel-plated	61-201
M2.5 Mat. ≥ 2.5 mm	Steel, nickel-plated, black	61-207
M2.5 Mat. ≥ 1 mm	Steel, nickel-plated	61-225
M2.5 Mat. ≥ 1 mm	Steel, nickel-plated, black	61-223

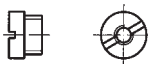

### 2.1.11 Threaded Bush

Description	Material	Part-No.
M2.5/M5 x 0.5	Brass, nickel-plated	61-200



### 2.1.12 Screw Retainer

Description	Material	Part-No.
M2.5 + M3	Plastic	61-008

# 2: Assembly Material



## 2.2 Miscellaneous Screws

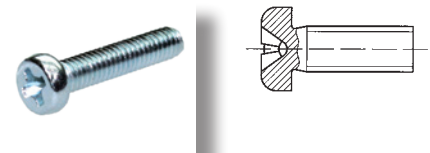

### 2.2.1 Philips Cylindrical Screw, ~DIN 84A

Description	Material	Part-No.
M2.5 x 4	Steel, zinc-plated	5325-04
M2.5 x 4, Torx T8	Stainless steel	5470-07
M2.5 x 5, Torx T8	Stainless steel	5470-07
M2.5 x 6	Steel, zinc-plated	5325-06
M2.5 x 6, Torx T8	Stainless steel	5470-04
M2.5 x 8	Steel, zinc-plated	5325-08
M2.5 x 8, Torx T8	Stainless steel	5470-10
M2.5 x 10	Steel, zinc-plated	5325-10
M2.5 x 10, Torx T8	Stainless steel	5470-09
M2.5 x 12	Steel, zinc-plated	5325-12
M2.5 x 12, Torx T8	Rostfreier Stahl	5470-12
M3 x 4, Torx T10	Steel, zinc-plated	5470-01
M3 x 6, Torx T10	Steel, zinc-plated	5470-02
M3 x 8	Steel, zinc-plated	5338-08
M3 x 8, Torx T10	Steel, zinc-plated	5470-03
M3 x 12	Steel, zinc-plated	5330-12
M3 x 12, Torx T10	Steel, zinc-plated	5470-05
M4 x 8	Steel, zinc-plated	5348-08
M4 x 8, Torx T10	Steel, zinc-plated	5470-06
M4 x 12	Steel, zinc-plated	5348-12

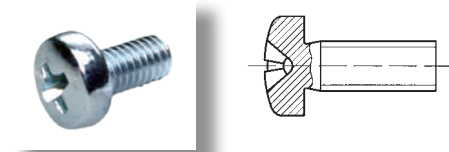

### 2.2.2 Philips Round Head Screw, DIN 7985A

Description	Material	Part-No.
M3 x 4	Steel, zinc-plated	5331-04
M3 x 6	Steel, zinc-plated	5330-06
M3 x 8	Steel, zinc-plated	5330-08
M3 x 10	Steel, zinc-plated	5330-10
M4 x 6	Steel, zinc-plated	5340-06
M4 x 8	Steel, zinc-plated	5340-08
M6 x 8	Steel, zinc-plated	5360-08

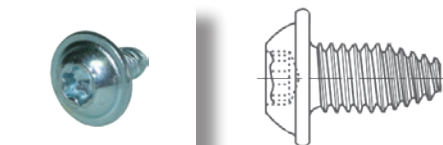

### 2.2.3 SHEETtracs® Screw

Description	Material	Part-No.
3 x 6, Torx T10	Steel, zinc-plated	5477-01

## 2: Assembly Material

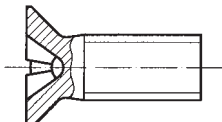

### 2.2.4 Philips Countersunk Screw, DIN 965A

Description	Material	Part-No.
M2.5 x 4	Steel, zinc-plated	5322-04
M2.5 x 4, Torx T8	Stainless steel	5470-25
M2.5 x 6	Steel, zinc-plated	5322-06
M2.5 x 6, Torx T8	Stainless steel	5470-20
M2.5 x 8	Steel, zinc-plated	5322-08
M2.5 x 8, Torx T8	Stainless steel	5470-21
M2.5 x 16, Torx T8	Stainless steel	5470-30
M3 x 6	Steel, zinc-plated	5332-06
M3 x 6, Torx T10	Steel, zinc-plated	5470-22
M3 x 8	Steel, zinc-plated	5332-08
M3 x 8, Torx T10	Steel, zinc-plated	5470-28
M3 x 10	Steel, zinc-plated	5332-10
M3 x 10, Torx T10	Steel, zinc-plated	5470-23
M4 x 6, Torx T20	Steel, zinc-plated	5470-27
M4 x 8, Torx T20	Steel, zinc-plated	5470-29
M4 x 10	Steel, zinc-plated	5342-08
M4 x 10, Torx T20	Steel, zinc-plated	5470-26
M4 x 10	Steel, zinc-plated	5342-10

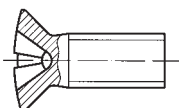

### 2.2.5 Philips Countersunk Round Head Screw, DIN 966A

Description	Material	Part-No.
M3 x 6	Steel, nickel-plated	5333-06
M3 x 8	Steel, nickel-plated	5333-08

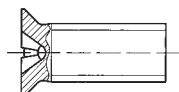

### 2.2.6 Philips Countersunk Screw with Small Head Ø 6

Description	Material	Part-No.
M4 x 5	Steel, zinc-plated	5441-50
M4 x 5	Steel, zinc-plated, black	5441-53
M4 x 5, Torx T10	Steel, zinc-plated	5441-58
M4 x 5, Torx T10	Steel, zinc-plated, black	5441-59
M4 x 10	Steel, zinc-plated	5441-51
M4 x 10	Steel, zinc-plated, black	5441-52
M4 x 10, Torx T10	Steel, zinc-plated	5441-54
M4 x 10, Torx T10	Steel, zinc-plated, black	5441-57

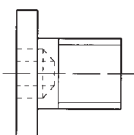

### 2.2.7 Cylindrical Allen Screw with Extremely Low Head

Description	Material	Part-No.
M5 x 6	Steel, zinc-plated	5441-22

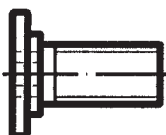

### 2.2.8 Special Low-Head Allen Screw with Collar

- Ø 8.2 x 1.3 for 19" perforation in cabinets

Description	Material	Part-No.
M6 x 15	Steel, zinc-plated	5441-15

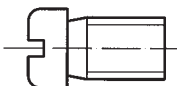

### 2.2.9 Slotted Cylindrical Screw with Small Head Ø 3.2 / Ø 3.8 (M3)

Description	Material	Part-No.
M2.5 x 4	Steel, zinc-plated	5526-04
M3 x 6	Steel, zinc-plated	5536-06

## 2: Assembly Material

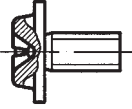

### 2.2.10 Philips Round Head Screw with Integrated Washer

Description	Material	Part-No.
M2.5 x 10, Torx 8	Steel, zinc-plated	5473-04
M3 x 4, Torx T10	Steel, zinc-plated	5473-02
M3 x 6	Steel, zinc-plated	5335-06
M3 x 6, Torx T10	Steel, zinc-plated	5473-01
M3 x 8, Torx T10	Steel, zinc-plated	5473-05
M4 x 12, Torx T20	Stainless steel	5473-03
M4 x 16, Torx T20	Steel, zinc-plated	5473-06
M5 x 16, Torx T25	Steel, zinc-plated	5473-07

### 2.2.11 Philips Round Head Screw with Integrated Washer, Tuflock-Coated

Description	Material	Part-No.
M2.5 x 10	Steel, zinc-plated	5336-10

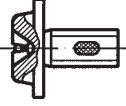

## 2.3 Earthing Screws

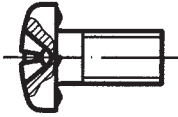

### 2.3.1 Special Philips Round Head Earthing Screw

Description	Material	Part-No.
M3 x 6	Steel, zinc-plated	61-283
M3 x 6	Steel, zinc-plated, black	61-293

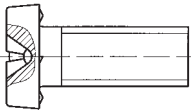

### 2.3.2 Special Philips Cylindrical Earthing Screw

Description	Material	Part-No.
M3 x 6, Torx T10	Steel, zinc-plated	5443-04
M4 x 6		61-279
M4 x 6, Torx T20	Steel, zinc-plated	5443-06
M4 x 10	Steel, zinc-plated	61-260
M4 x 10, Torx T20	Steel, zinc-plated	5443-01
M4 x 16, Torx T20	Steel, zinc-plated	5443-07

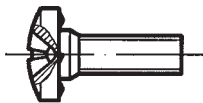

### 2.3.3 Special Philips Round Head Earthing Screw

- With collar  $\varnothing$  3.2 x 0.9 for front panels

Description	Material	Part-No.
M2.5 x 8	Steel, nickel-plated	61-286
M2.5 x 8, Torx T8	Steel, nickel-plated	61-298

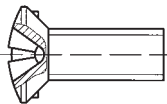

### 2.3.4 Philips Countersunk Round Head Earthing Screw

Description	Material	Part-No.
M3 x 8	Steel, zinc-plated	61-270
M3 x 8	Steel, zinc-plated, black	61-292
M4 x 12	Steel, zinc-plated	63-271

# 2: Assembly Material

## 2.4 Self-Tapping Screws

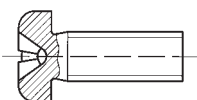

### 2.4.1 Self-Tapping Philips Round Head Screw

Description	Material	Part-No.
M3 x 5	Steel, zinc-plated	5338-05
M4 x 6, Torx T20	Steel, zinc-plated	5471-01
M4 x 8, Torx T20	Steel, zinc-plated	5471-02

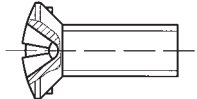

### 2.4.2 Self-Tapping Philips Countersunk Earthing Screw

Description	Material	Part-No.
M3 x 8.8	Steel, zinc-plated	61-272

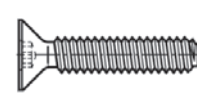

### 2.4.3 Self-Tapping Countersunk Screw

Description	Material	Part-No.
M4 x 12, Torx T20	Steel, zinc-plated	5472-01

## 2.5 PT Screws

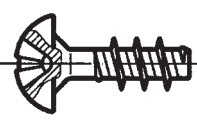

### 2.5.1 Philips PT Round Head Screw

Description	Material	Part-No.
Ø 2.2 x 8	Steel, zinc-plated	5535-13
Ø 2.2 x 12	Steel, zinc-plated	5535-12
Ø 2.5 x 8	Steel, zinc-plated	5588-08
Ø 3 x 8	Steel, zinc-plated	61-276

## 2.6 Sheet Metal Screws

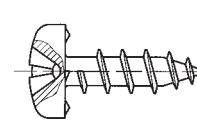

### 2.6.1 Special Philips Round Head Sheet Metal Earthing Screw

Description	Material	Part-No.
Ø 2.9 x 6.5, Torx T10	Steel, zinc-plated	5443-09
Ø 2.9 x 9.5	Steel, zinc-plated	5441-33
Ø 4.8 x 9.5, Torx T25	Steel, zinc-plated	5575-40

## 2.7 Threaded Bolts

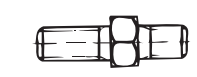

### 2.7.1 Threaded Earthing Bolt

Description	Material	Part-No.
M4 x 9/6	Steel, zinc-plated	61-096

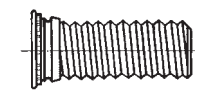

### 2.7.2 Press-in Threaded Stud for Earth Connector

Description	Material	Part-No.
M3 x 8	Steel, zinc-plated	5815-32
M4 x 8	Steel, zinc-plated	5815-41
M4 x 10	Steel, zinc-plated	5815-42
M4 x 12	Steel, zinc-plated	5815-43

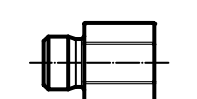

### 2.7.3 ESD Snap-faster Hook-up

Description	Material	Part-No.
M3 / 4.5 mm, L= 9.5 mm	Brass	61-001

## 2.8 Set Screws



### 2.8.1 Set Screws for Fixing of Tapped Strips

Description	Material	Part-No.
M2.5 x 8	Steel, zinc-plated	5412-08
M3 x 6	Steel, zinc-plated	5413-06



# 2: Assembly Material

## 2.9 Nuts and Lock Nuts



### 2.9.1 Hexagonal Nut

Description	Material	Part-No.
M2 x 0.8d	Stainless steel	5620-12
M2.5 x 0.8d	Steel, zinc-plated	5620-31
M3 x 0.5d	Steel, zinc-plated	5620-40
M3 x 0.8d	Steel, zinc-plated	5620-41
M4 x 0.5d	Steel, zinc-plated	5620-50
M4 x 0.8d	Steel, zinc-plated	5620-51
M5 x 0.8d	Steel, zinc-plated	5620-61
M6 x 0.8d	Steel, zinc-plated	5620-71



### 2.9.2 Hexagonal Lock Nut

Description	Material	Part-No.
M2.5	Steel, zinc-plated	5627-00
M5	Steel, zinc-plated	5627-02



### 2.9.3 Inset Nut

Description	Material	Part-No.
M6	Steel, zinc-plated	1925-65



### 2.9.4 Retainer For Inset Nut

Description	Material	Part-No.
M6	POM	61-030



### 2.9.5 Square Nut

Description	Material	Part-No.
M2.5 SW5.5	Steel, zinc-plated	61-249
M3 SW5.5	Steel, zinc-plated	5621-40
M4 SW7	Steel, zinc-plated	5621-50



### 2.9.6 Square Earthing Nut

Description	Material	Part-No.
M4 SW7	Steel, tempered	61-095



### 2.9.7 Holder For Square Nut

Description	Material	Part-No.
SW7	POM	61-073



### 2.9.6 Nut Positioning Ring for Nut in Profile Slot

Description	Material	Part-No.
M3 (8.2 / 6.2)	PE	61-015
M4 (8.2 / 6.2)	PE	61-016



### 2.9.6 Oblique Nut

Description	Material	Part-No.
M6	Steel, zinc-plated	61-839

# 2: Assembly Material

## 2.10 Washers

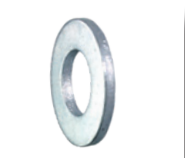

### 2.10.1 Washer

Description	Material	Part-No.
Ø 2.8 / 7.0 (M2.5)	Steel, zinc-plated	5630-01
Ø 3.2 / 7.0 (M3)	Steel, zinc-plated	5630-02
Ø 4.3 / 9.0 (M4)	Steel, zinc-plated	5630-03
Ø 4.3 / 12.0 (M4)	Steel, zinc-plated	5630-06



### 2.10.2 Lock Washer

Description	Material	Part-No.
Ø 3.2 (M3)	Spring steel, black	5706-04
Ø 4.3 (M4)	Spring steel, black	5706-06



### 2.10.3 Plastic Washer

Description	Material	Part-No.
M6	POM, black	61-007



### 2.10.5 Washers for Unibox 14

Description	Material	Part-No.
Washer for Unibox 14	Aluminium, raw	61-427

# 2: Assembly Material

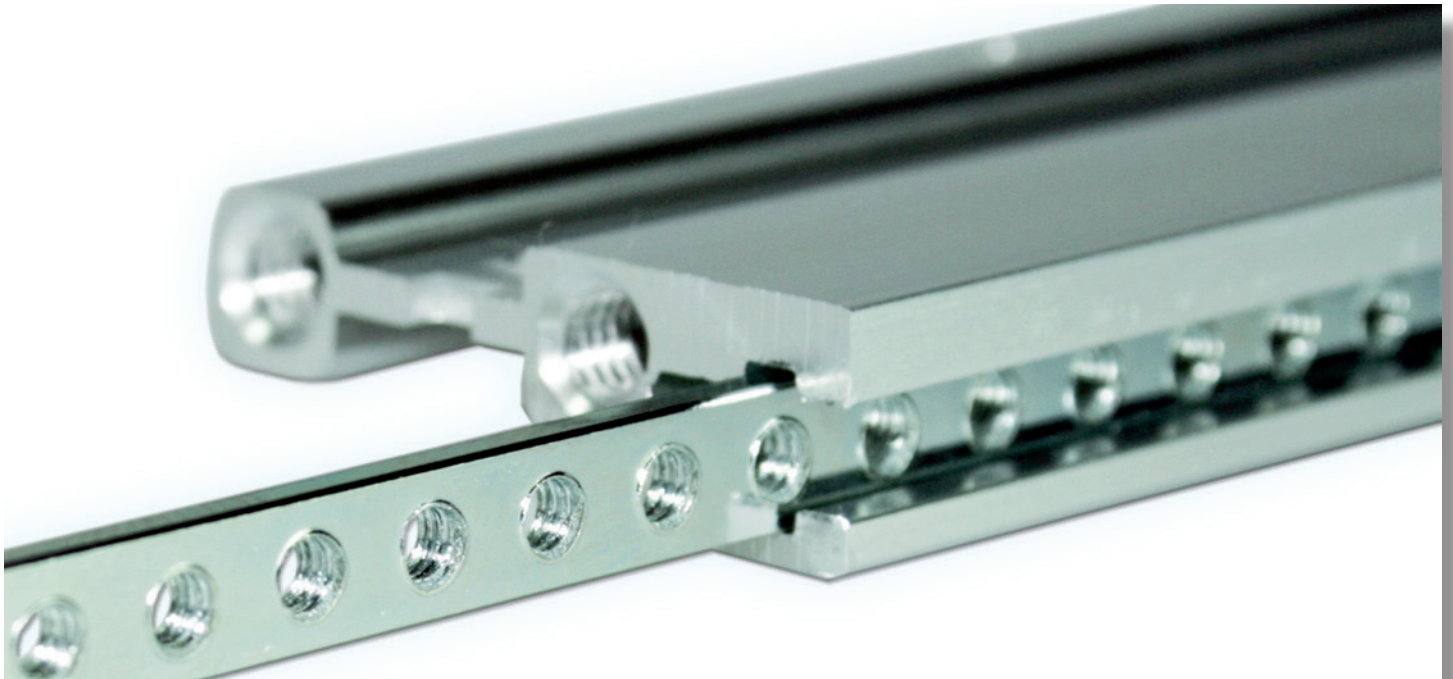

## 2.11 Tapped Strips

### 2.11.1 Tapped Strips M2.5

- 2 x 6 mm M2.5
- Steel, galvanised, passivated

Description	Material	Part-No.
M2.5 4 HP	Steel, zinc-plated	61-483
M2.5 8 HP	Steel, zinc-plated	61-475
M2.5 10 HP	Steel, zinc-plated	61-436
M2.5 15 HP	Steel, zinc-plated	61-476
M2.5 18 HP	Steel, zinc-plated	61-477
M2.5 21 HP	Steel, zinc-plated	61-459
M2.5 27 HP	Steel, zinc-plated	61-486
M2.5 28 HP	Steel, zinc-plated	61-458
M2.5 32 HP	Steel, zinc-plated	61-463
M2.5 40 HP	Steel, zinc-plated	61-465
M2.5 42 HP	Steel, zinc-plated	61-464
M2.5 47 HP	Steel, zinc-plated	61-461
M2.5 60 HP	Steel, zinc-plated	61-466
M2.5 63 HP	Steel, zinc-plated	61-469
M2.5 81 HP	Steel, zinc-plated	61-467
M2.5 84 HP	Steel, zinc-plated	61-468
M2.5 2200 mm	Steel, zinc-plated	61-532

Description	Material	Part-No.
M2.5 43 HP	Steel, zinc-plated	61-588
M2.5 64 HP	Steel, zinc-plated	61-587
M2.5 85 HP	Steel, zinc-plated	61-568

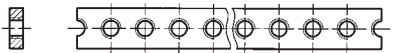

## 2: Assembly Material

### 2.11.2 Tapped Strips M2.5 1.8 x 5 mm

- 1.8 x 5 mm, M2.5
- Steel, galvanised, passivated

Description	Material	Part-No.
M2.5 10 HP	Steel, zinc-plated	61-470
M2.5 18 HP	Steel, zinc-plated	61-478
M2.5 27 HP	Steel, zinc-plated	61-479
M2.5 42 HP	Steel, zinc-plated	61-471
M2.5 46 HP	Steel, zinc-plated	61-460
M2.5 63 HP	Steel, zinc-plated	61-472
M2.5 81 HP	Steel, zinc-plated	61-473
M2.5 84 HP	Steel, zinc-plated	61-474
M2.5 2200 mm	Steel, zinc-plated	61-534

Description	Material	Part-No.
M2.5 43 HP	Steel, zinc-plated	61-584
M2.5 64 HP	Steel, zinc-plated	61-585
M2.5 85 HP	Steel, zinc-plated	61-586

### 2.11.3 Tapped Strips M3

- 2 x 6 mm M3
- Steel, galvanised, passivated

Description	Material	Part-No.
M3 10 HP	Steel, zinc-plated	61-435
M3 28 HP	Steel, zinc-plated	61-456
M3 42 HP	Steel, zinc-plated	61-454
M3 63 HP	Steel, zinc-plated	61-455
M3 81 HP	Steel, zinc-plated	61-450
M3 84 HP	Steel, zinc-plated	61-453
M3 L = 427.78 mm	Steel, zinc-plated	61-242-443
M3 L = 443.02 mm	Steel, zinc-plated	61-242-428

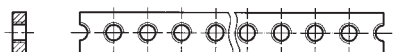

### 2.12 Label Strips

- Numbering of HP-steps
- Mounting onto front extrusions
- Black plastic, PVC
- Numbering white
- Self-adhesive
- **Scope of delivery:**
  - 1 label strip, consisting of 4 single tapes

#### 2.12.1 Label Strips

Numbering	Length		Scope of Delivery	Part-No.
	mm	inch		
01-42/42-01	218.1	8.58	2 pcs. each (up and down)	63-142
01-63/63-01	324.8	12.78	2 pcs. each (up and down)	63-143
01-81/81-01	416.4	16.39	2 pcs. each (up and down)	63-043
01-84/84-01	431.6	16.99	2 pcs. each (up and down)	63-046

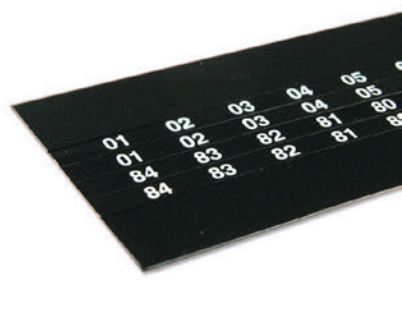

# 2: Assembly Material

## 2.13 Insulation

### 2.13.1 Backplane Insulating Spacer

Description	Material	Part-No.
Ø 7 (M2.5)	POM	61-088

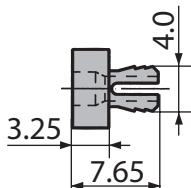

### 2.13.2 Insulating Strips

Description	Material	Part-No.
28 HP	ABS	66-901-25
42 HP	ABS	66-901-20
63 HP	ABS	66-901-21
81 HP	ABS	66-901-22
84 HP	ABS	66-901-23

