

Overview .....	0
Cabinets .....	1
Wall mounted cases .....	2
Accessories for cabinets and wall mounted cases ....	3
Climate control ....	4
<b>Desk-top cases ....</b>	<b>5</b>
Subracks/ 19" chassis .....	6
Front panels, plug-in units .....	7
Systems .....	8
Power supply units .....	9
Backplanes .....	10
Connectors, front panel component system .....	11
Appendix .....	12

## Desk-top cases - *compacPRO*

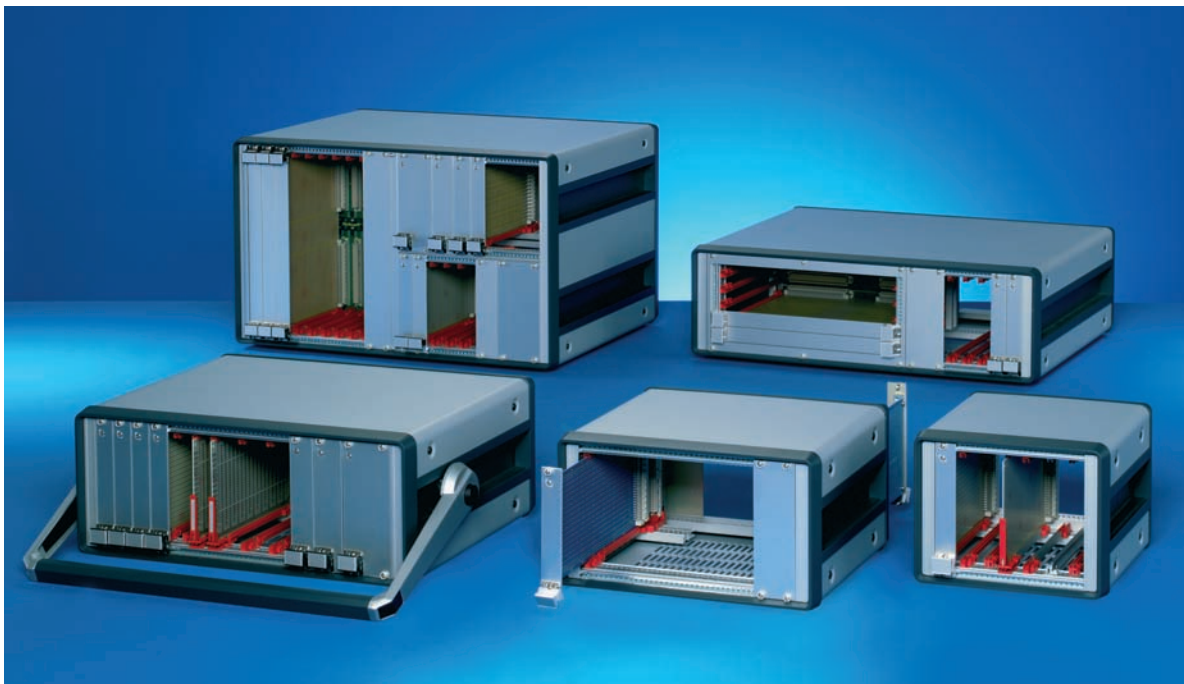

02004009

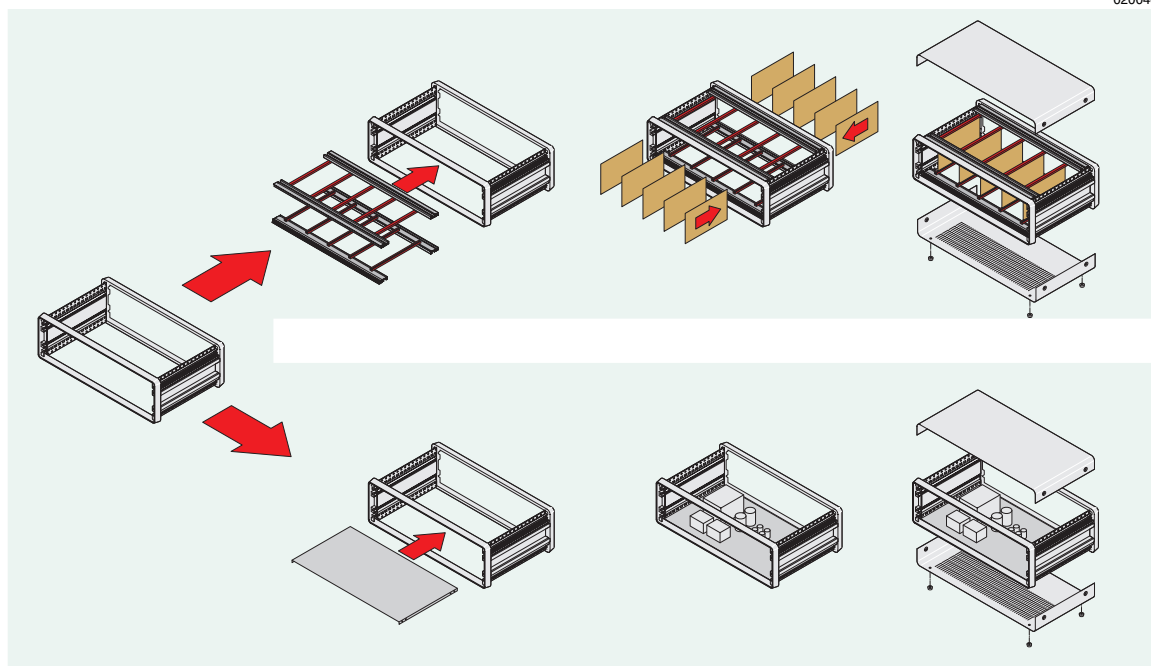

Flexible expansion options, for 19" components e.g. plug-in unit units, or for individual expansion

02004079

### Standards

- Interior dimensions in accordance with: IEC 60297-3-101
- Type of protection IP 20 in accordance with IEC 60529
- Earth connections in accordance with:
  - DIN EN 50178 / VDE 0160
  - DIN EN 60950 / VDE 0805
  - DIN EN 61010-1 / VDE 0411 part 1
  - DIN EN 61010-1A2 / VDE 0411 part 1/A12



Downloads and further important information can be found on the Internet under [www.schroff.biz](http://www.schroff.biz)



## Desk-top cases - *compacPRO*

Overview . . . . 5.72

The robust desk-top enclosure for 19" components or individual electronics assemblies

- Front and rear identical, depth-symmetrical construction
- Wide range of versions and extensive accessory programme focussed on mobile applications
- Simple fitting and flexible assembly options



### Desk-top enclosures

- **Complete case**
  - Prefitted cases, prepared for 19" systems
  - Case heights 3 U and 6 U

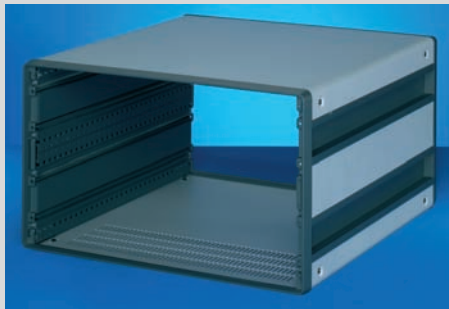

02004005 02004006

- **Cases**
  - Case heights 2 U, 3 U, 4 U and 6 U



02004002

### Extensive accessory range

### compacPRO

<b>Complete cases</b>	
3, 6 U . . . . .	5.74
Cases 2, 3, 4 U . . . . .	5.75
Case 6 U . . . . .	5.76

### Accessories

Filler angle . . . . .	5.77
Cable holder . . . . .	5.77
Front panels/ rear panels . . . . .	5.78
Rear feet . . . . .	5.79
Tip-up protection . . . . .	5.79
Hoods . . . . .	5.80
Front doors . . . . .	5.81
Handles . . . . .	5.82
GND/earthing . . . . .	5.82
Feet . . . . .	5.83
Horizontal rails . . . . .	5.84
Threaded inserts . . . . .	5.86
Guide rails and ESD clips . . . . .	5.88
Mounting plates . . . . .	5.90
Dimensions . . . . .	5.91

### ServicePLUS from page 5.110

e.g. modifications (special colours, special depths, cut-outs in top cover, base plate or side panels)  
e.g. assembly service from 1 piece

[www.schroff.biz/serviceplus/](http://www.schroff.biz/serviceplus/)



30407004

ServicePLUS . 5.110



# Desk-top cases - *compacPRO*

## Case 2, 3 and 4 U

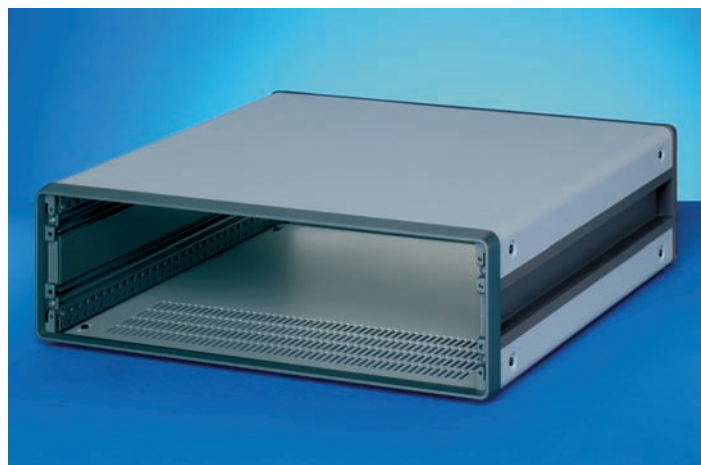

02004005

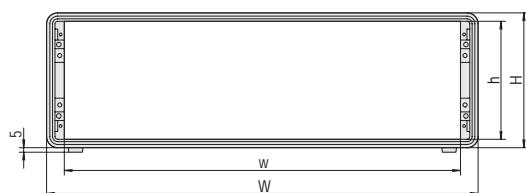
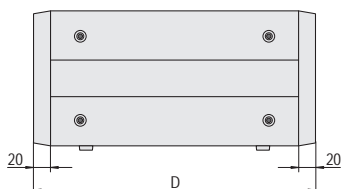

02004054

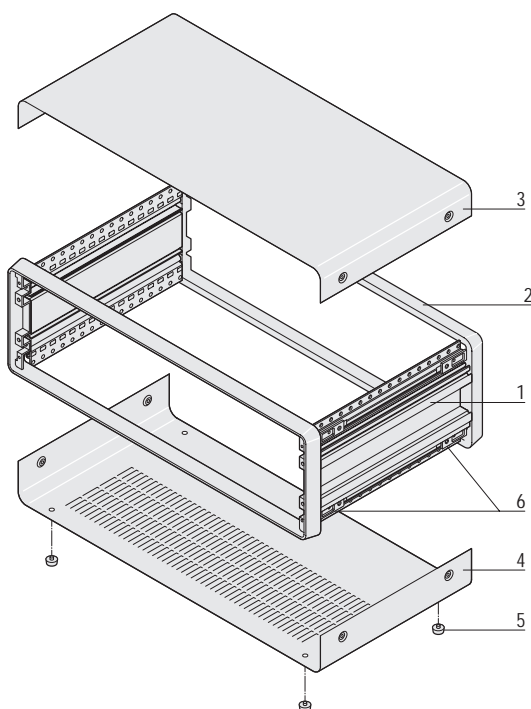

02004053

- Desk-top enclosure, prefitted, for individual assembly
- For backplane mounting with insulation strips
- Ventilation slots in base plate

### Delivery comprises (kit, item 1 and 2 assembled)

Item	Qty	Description
1	2	Side panel, Al extrusion, powder-coated, RAL 7016
2	2	Frame, Al die-cast, powder-coated, RAL 7016
3	1	Cover plate, Al, 1.5 mm, powder-coated, RAL 9006, with earthing connection
4	1	Base plate with 4 rows of ventilation slots, Al, 1.5 mm, powder-coated RAL 9006, with earthing connection
5	4	Case foot with anti-slip protection, PC, black
6	8	Cover plate fixing adapter, prefitted
7	1	Assembly kit, additionally allows mounting of a full-width front panel, two cover brackets or a rear panel

### Order Information

Height U	Usable width HP	Width W mm	Width w mm	Height H mm	Height h mm	Depth D mm	Part no.
2	42	257	219	102.6	84.4	271	<b>14575-023</b>
2	42	257	219	102.6	84.4	331	<b>14575-025</b>
2	42	257	219	102.6	84.4	391	<b>14575-027</b>
2	84	471	432	102.6	84.4	271	<b>14575-063</b>
2	84	471	432	102.6	84.4	331	<b>14575-065</b>
2	84	471	432	102.6	84.4	391	<b>14575-067</b>
3	28	186	148	147.1	129.3	271	<b>14575-103</b>
3	28	186	148	147.1	129.3	331	<b>14575-105</b>
3	42	257	219	147.1	129.3	271	<b>14575-123</b>
3	42	257	219	147.1	129.3	331	<b>14575-125</b>
3	42	257	219	147.1	129.3	391	<b>14575-127</b>
3	63	364	326	147.1	129.3	271	<b>14575-143</b>
3	63	364	326	147.1	129.3	331	<b>14575-145</b>
3	63	364	326	147.1	129.3	391	<b>14575-147</b>
3	84	471	432	147.1	129.3	271	<b>14575-163</b>
3	84	471	432	147.1	129.3	331	<b>14575-165</b>
3	84	471	432	147.1	129.3	391	<b>14575-167</b>
3	84	471	432	147.1	129.3	451	<b>14575-169</b>
3	84	471	432	147.1	129.3	511	<b>14575-171</b>
4	42	257	219	191.6	173.8	271	<b>14575-223</b>
4	42	257	219	191.6	173.8	331	<b>14575-225</b>
4	63	364	326	191.6	173.8	271	<b>14575-243</b>
4	63	364	326	191.6	173.8	331	<b>14575-245</b>
4	63	364	326	191.6	173.8	391	<b>14575-247</b>
4	84	471	432	191.6	173.8	331	<b>14575-265</b>
4	84	471	432	191.6	173.8	391	<b>14575-267</b>
4	84	471	432	191.6	173.8	451	<b>14575-269</b>
4	84	471	432	191.6	173.8	511	<b>14575-271</b>



For further information [www.schroff.biz/oneclick](http://www.schroff.biz/oneclick)  
oneClick search code = Part no.



ServicePLUS see page 5.110

## Desk-top cases - *compacPRO*

### Filler angle



02005002

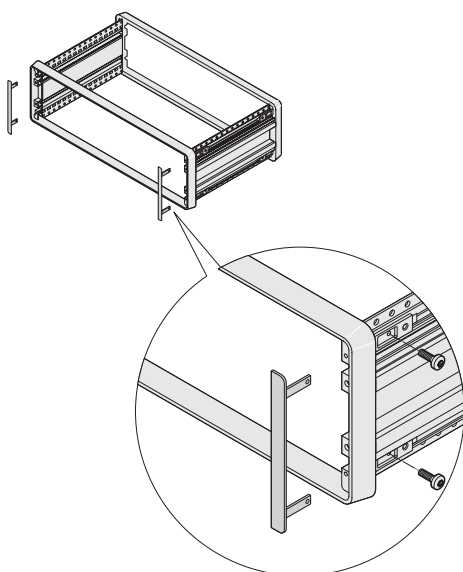

02004062

- For lateral covering of the frame and to set up a consistent front level with front panels and plug-in units

### Delivery comprises

Item	Qty	Description
1	2	Filler angle, Al extrusion, anodised, plain cut edges

### Order Information

Height	Part no.
<b>U</b>	
2	<b>24575-019</b>
3	<b>24575-119</b>
4	<b>24575-219</b>
6	<b>24575-419</b>

### Note

- The delivery of the cases is inclusive of an assembly kit



For further information [www.schroff.biz/oneclick](http://www.schroff.biz/oneclick)  
oneClick search code = Part no.

### Cable holder

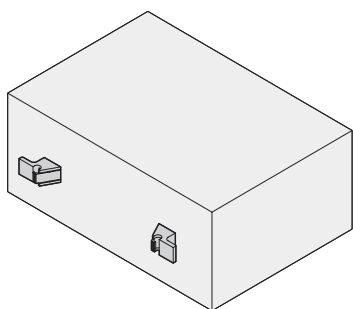

02908053

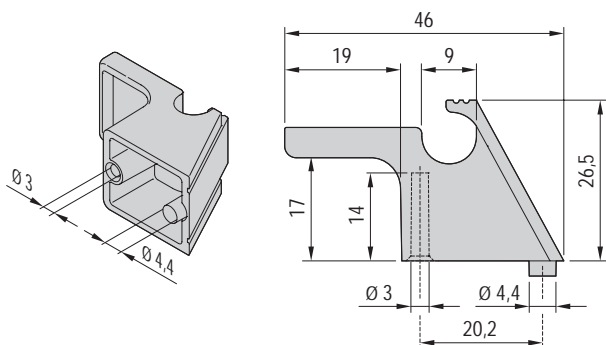

02908052

### Delivery comprises (kit)

Item	Qty	Description
1	2	Cable bracket, ABS UL V-94 0, coloured RAL 7016, detent for cables between 8 mm and 12 mm
2	1	Drilling template, two drill holes each per bracket are needed in the rear panel
3	1	Assembly kit

### Order Information

Description	Part no.
Cable holder	<b>24575-800</b>



For further information [www.schroff.biz/oneclick](http://www.schroff.biz/oneclick)  
oneClick search code = Part no.

## Desk-top cases - *compacPRO*

### Front panel and rear panel



- Front panels and rear panels are screwed on front or backframe of case

#### Delivery comprises (kit)

Item	Qty	Description
1	1	Rear panel with 4 rows of vent slots, Al, anodised, cut edges plain; 28, 42, 63 HP = 2 mm thick; 84 HP = 2.5 mm thick
2	1	Front panel, Al, anodised, cut edges plain, 3 mm thick

#### Order Information

Height U	Width HP	Height H mm	Height h mm	Width B mm	Width b mm	Rear panel Part no.	Front panel Part no.
2	42	84	66	238.7	226.3	<b>30823-015</b>	<b>30823-209</b>
2	84	84	66	452.1	439.7	<b>30823-512</b>	<b>30823-215</b>
3	28	128.4	100	167.5	155.1	<b>30823-021</b>	<b>30823-254</b>
3	42	128.4	100	238.7	226.3	<b>30823-024</b>	<b>30823-257</b>
3	63	128.4	100	345.4	333.1	<b>30823-027</b>	<b>30823-224</b>
3	84	128.4	100	452.1	439.7	<b>30823-515</b>	<b>30823-260</b>
4	42	172.9	144.5	238.7	226.3	<b>30823-033</b>	<b>30823-269</b>
4	63	172.9	144.5	345.4	333.1	<b>30823-036</b>	<b>30823-227</b>
4	84	172.9	144.5	452.1	439.7	<b>30823-518</b>	<b>30823-272</b>
6	63	261.8	233.4	345.4	333.1	<b>30823-045</b>	<b>30823-230</b>
6	84	261.8	233.4	452.1	439.7	<b>30823-521</b>	<b>30823-284</b>

#### Note

- Assembly kit for mounting one rear and one front panel is included with the case
- Cable holder and rear feet see from page 5.77

Rear panel/front panel

0200501

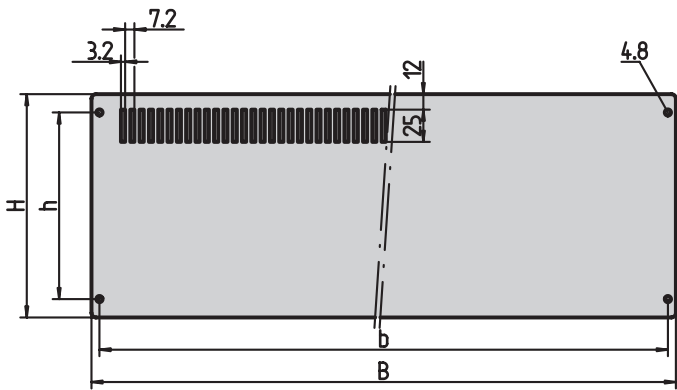

CPA30656

### Front panel/rear panel, assembly parts not visible

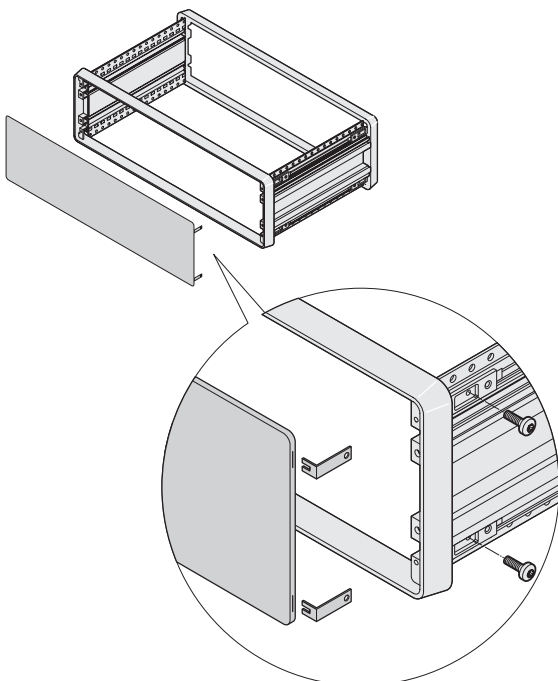

02004061

#### Delivery comprises (kit)

Item	Qty	Description
1	1	Front panel, Al, anodised, cut edges plain, 2.5 mm
2	4	Mounting bracket

#### Order Information

Height U	Width HP	Height H mm	Height h mm	Width B mm	Width b mm	Part no.
2	42	84.0	66.0	238.7	226.3	<b>24575-035</b>
2	84	84.0	66.0	452.1	439.7	<b>24575-075</b>
3	28	128.4	100.0	167.5	155.1	<b>24575-115</b>
3	42	128.4	100.0	238.7	226.3	<b>24575-135</b>
3	63	128.4	100.0	345.4	333.1	<b>24575-155</b>
3	84	128.4	100.0	452.1	439.7	<b>24575-175</b>
4	42	172.9	144.5	238.7	226.3	<b>24575-235</b>
4	63	172.9	144.5	345.4	333.1	<b>24575-255</b>
4	84	172.9	144.5	452.1	439.7	<b>24575-275</b>
6	63	261.8	233.4	345.4	333.1	<b>24575-455</b>
6	84	261.8	233.4	452.1	439.7	<b>24575-475</b>

#### Note

- Assembly kit is included with case

## Desk-top cases - *compacPRO*

### Tip-up carrying handle



02004002

- With powder-coated handle bar
- Handle bar adjustable in 30 degree increments by pressing button
- Load-carrying capacity 20 kg

### Delivery comprises (kit)

Item	Qty	Description
1	1	Carrying bar, Al profile, painted RAL 7016
2	2	Handle side section, Zn die-cast, powder coated, length 180 mm
3	2	Safety insert, St, 1.5 mm, black
4	1	Assembly kit incl. drilling template for side panel

### Order Information

For case height	Width	Part no.
<b>U</b>	<b>HP</b>	
2	42	<b>24575-038</b>
2	84	<b>24575-078</b>
3, 4	28	<b>24575-118</b>
3, 4	42	<b>24575-138</b>
3, 4	63	<b>24575-158</b>
3, 4	84	<b>24575-178</b>

### Dimensions

Case width	a	b	c
<b>HP</b>	<b>mm</b>	<b>mm</b>	<b>mm</b>
28	249.32	180.32	202.72
42	320.44	251.44	273.84
63	427.12	358.12	380.52
84	533.80	464.80	487,20

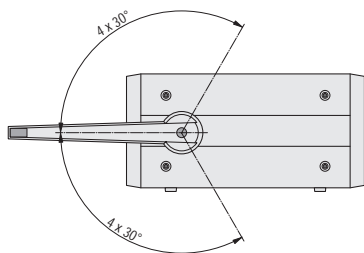
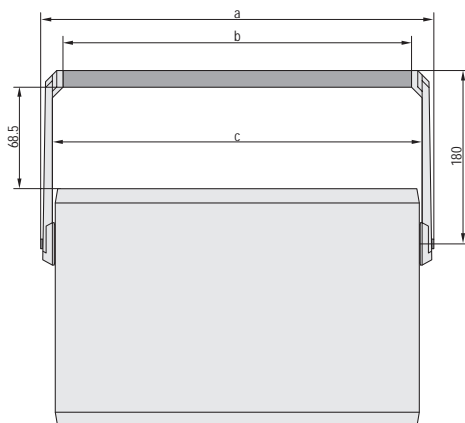

02004080



For further information [www.schroff.biz/oneclick](http://www.schroff.biz/oneclick)  
oneClick search code = Part no.

### Earthing kit

- Protective GND/earth connections in accordance with  
DIN EN 50178/VDE 0160  
DIN EN 60950/VDE 0805  
DIN EN 61010-1/VDE 0411 part 1  
DIN EN 61010-1A2 /VDE 0411 part 1/A1

### Order Information

Description	Qty/PU	Part no.
GND/earthing kit, CU wire 1.5 mm <sup>2</sup> , PVC covered, green/yellow, for the connection of side panel, base, cover and rear panel	1	<b>24575-801</b>

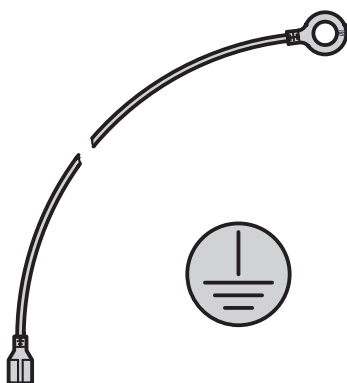

aza43284

## Desk-top cases - *compacPRO*

### Plastic tip-up foot

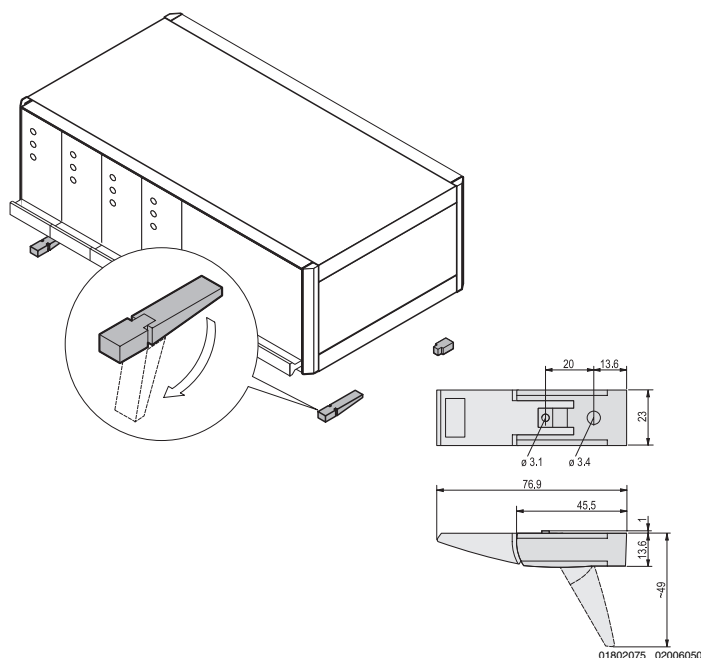

- Tip-up feet can be used instead of the pre-mounted case feet
- Load-carrying capacity 25 kg per foot
- Mounting holes in bottom of case

### Delivery comprises (kit)

Item	Qty	Description
1	4	Foot, PA, UL 94 V-0
2	4	Anti-slip protection, TPE
3	2	Tip-up device, PA ,UL 94 V-0
4	1	Assembly kit

### Order Information

Description	RAL 7016	RAL 9006
	anthracite	silver
	Part no.	Part no.
Plastic tip-up foot	<b>20603-002</b>	<b>20603-001</b>

### Al die-cast foot with/without tip-up

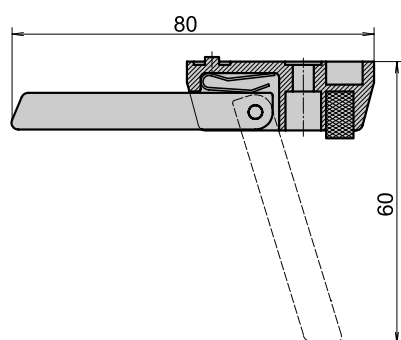

AZA43836

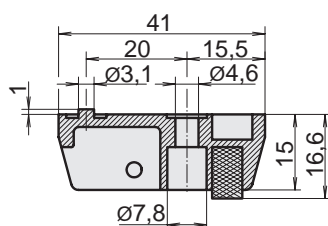

02908051

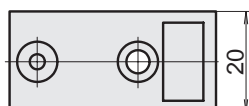

- Tip-up feet can be used instead of the pre-mounted case feet
- Load-carrying capacity: 50 kg per foot
- Mounting holes in bottom of case

### Order Information

Description	Qty/PU	Part no.
Foot with tip-up, Al die-cast, silver	1	<b>10603-002</b>
Foot without tip-up, Al die-cast, silver	1	<b>10603-001</b>
<b>Cheesehead screw with slot</b> M4 × 12, St, zinc-plated, PU 100 pieces		<b>21101-211</b>
<b>Hexagon nut M4</b> , St, zinc-plated, PU 100 pieces		<b>21100-211</b>
<b>Spring washer A4</b> , St, zinc-plated, PU 100 pieces		<b>21100-207</b>

Delivery is exclusively in Standard Pack Quantity (SPQ): Please order at least 10 pieces or a multiple. Pricing is per individual item.

# Desk-top cases - *compacPRO*

## Mounting position horizontal/central rail

Case, 2 U

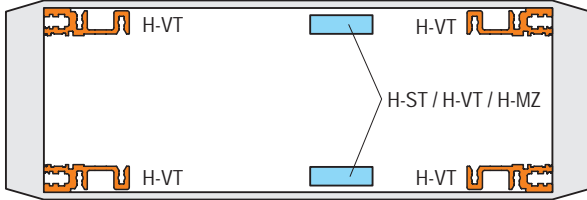

02004073

Case, 3 U + 4 U

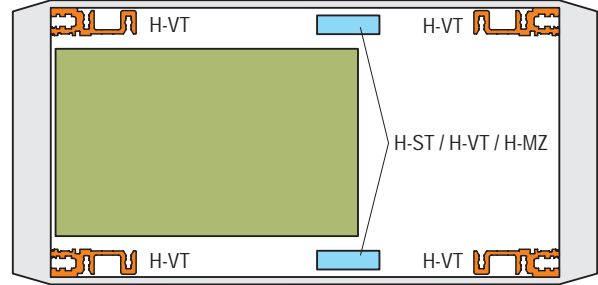

02004074

Case, 6 U

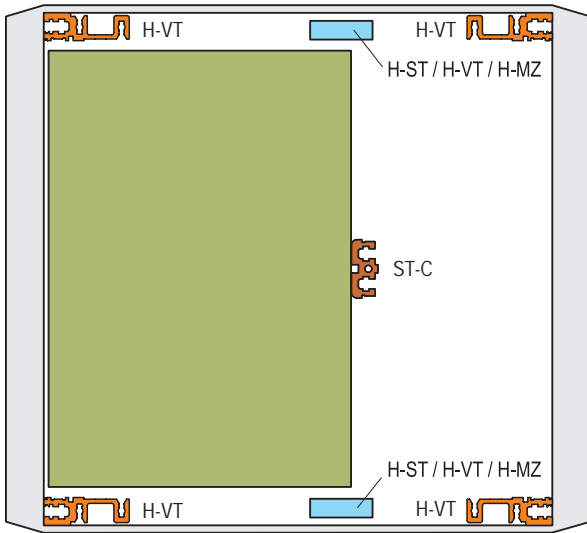

02004076

Case 2 x 3 U (6 U)

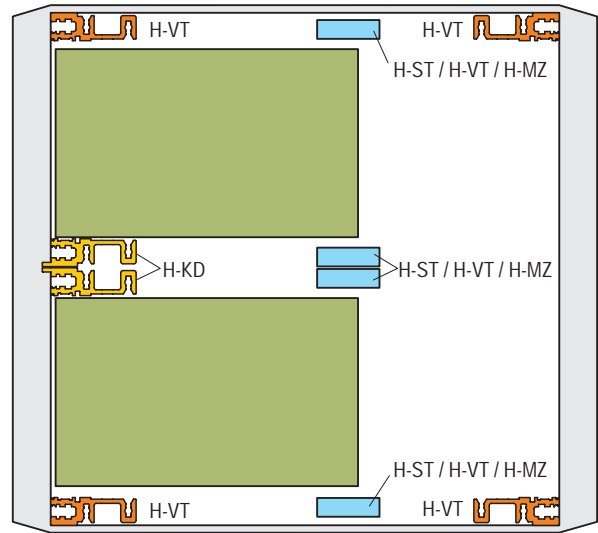

02004077

### Horizontal rail

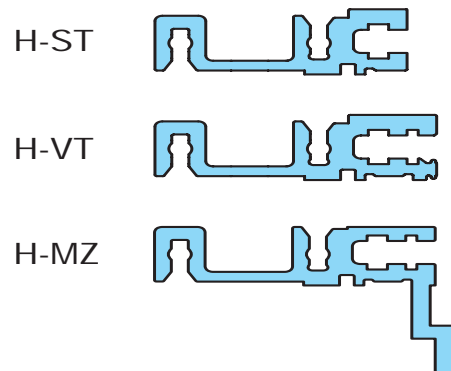







02004078



# Desk-top cases - *compacPRO*

## Horizontal rails, front/centre/rear

### Order Information

		For indirect backplane fixing with insulation strip	For direct backplane fixing	For direct mounting of connectors to EN 60603-2 (DIN 41612)	Front horizontal rail
		 06197011 <b>"heavy" Type H-ST standard</b>  06197011 Al extrusion, surface anodised, conductive contact surface	 06197011 <b>"heavy" Type H-VT long lip</b>  06197009 Al extrusion, surface anodised, conductive contact surface	 06197011 <b>"heavy" Type H-MZ with Z-rail</b>  06197015 Al extrusion, surface anodised, conductive contact surface	<b>"heavy" Type H-KD short lip</b>  06197008 Al extrusion, anodised finish, contact surface conducting, with printed HP markings
Usable length HP	Length mm	1 piece (SPQ 10) <sup>1)</sup>	1 piece (SPQ 10) <sup>1)</sup>	1 piece (SPQ 10) <sup>1)</sup>	1 piece (SPQ 10) <sup>1)</sup>
28	147.32	<b>34560-528</b>	<b>34560-728</b>	<b>34560-928</b>	<b>34560-228</b>
42	218.44	<b>34560-542</b>	<b>34560-742</b>	<b>34560-942</b>	<b>34560-242</b>
63	325.12	<b>34560-563</b>	<b>34560-763</b>	<b>34560-963</b>	<b>34560-263</b>
84	431.80	<b>34560-584</b>	<b>34560-784</b>	<b>34560-984</b>	<b>34560-284</b>
Torx countersunk screw, M4 × 14, St, zinc-plated, PU 100 pieces		<b>24571-371</b>	<b>24571-371</b>	<b>24571-371</b>	<b>24571-371</b>
Torx countersunk screw, M4 × 10, St, zinc-plated, PU 100 pieces		-	-	<b>24571-372</b>	<b>24571-372</b>
Z-rail for connector mounting without insulation strip see page		5.87	-	-	-
Insulation strips see page		-	5.86	-	-
Threaded inserts see page		5.86	5.86	5.86	5.86

1) SPQ (standard pack quantity): Order number includes 1 piece, but delivery is exclusively made in standard pack quantity (SPQ); please order at least the SPQ quantity or a multiple thereof

#### Note

- Further horizontal rails, see from page 6.26
- Fitting options, see page 5.84

# Desk-top cases - *compacPRO*

## Horizontal rail centre, type ST-C

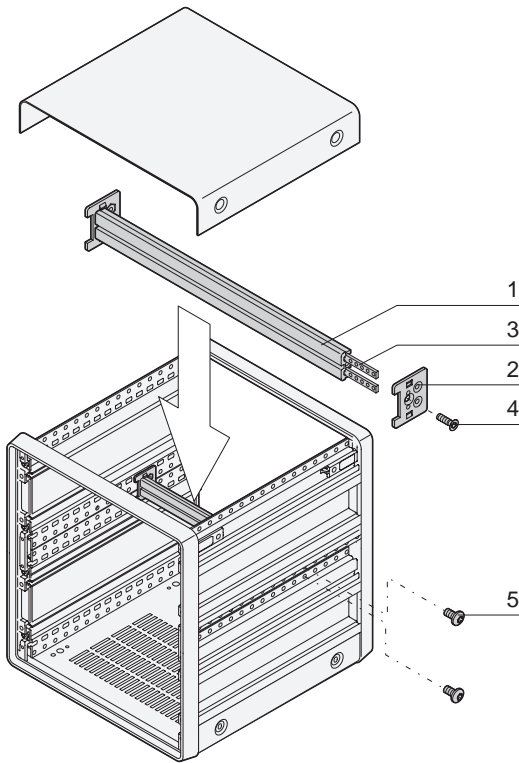

- For indirect backplane mounting (with insulation strip)
- For 6 U compacPRO case

**Delivery comprises** (kit, item 1 up to 4 pre-mounted)

Item	Qty	Description
1	1	Horizontal rail, Al extrusion, anodised, conductive contact surfaces
2	2	Adaptor plates, Al
3	2	Threaded inserts M 2.5 , St, zinc-plated
4	2	Countersunk screw, M4 x 14
5	4	Panhead screw M4 x 6

### Order Information

Usable width HP	Length mm	Part no.
63	325.1	<b>24575-454</b>
84	431.8	<b>24575-474</b>
<b>Insulation strip</b> 63 HP, PBT UL 94 V-0, grey, SPQ 10 pieces		<b>30894-444</b>
<b>Insulation strip</b> 84 HP, PBT UL 94 V-0, grey, SPQ 10 pieces		<b>60817-061</b>

## Threaded inserts, perforated strips, insulation strips

### Order Information

Usable length HP	Threaded insert		Insulation strip		
	Length mm	1 piece (SPQ 10) <sup>1)</sup>	1 piece (SPQ 10) <sup>1)</sup>	Length mm	PU 10 pieces
28	147.32	<b>34561-328</b>	—	144.20	<b>24560-828</b>
42	218.44	<b>34561-342</b>	—	210.40	<b>24560-842</b>
63	325.12	<b>34561-363</b>	—	316.88	<b>24560-863</b>
84	431.80	<b>34561-384</b>	<b>34561-484</b>	428.64	<b>24560-884</b>
Item		<b>21100-276</b>	—		—
Grub screw M2.5 x 8, PU 100 pieces		—	—		—
Grub screw M2.5 x 9, PU 100 pieces		—	—		—
Grub screw M3 x 8, PU 100 pieces		—	<b>21100-646</b>		—

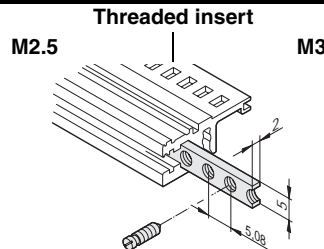

required for assembly of front panel on horizontal rail;  
please use collar screw 12.3 mm,  
see page 6.68

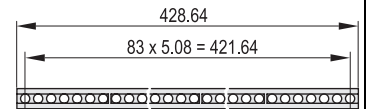

for insulated backplane mounting

<sup>1)</sup> SPQ (standard pack quantity): Order number includes 1 piece, but delivery is exclusively made in standard pack quantity (SPQ); please order at least the SPQ quantity or a multiple thereof

# Desk-top cases - *compactPRO*

## Z-rails, perforated rails

### Order Information

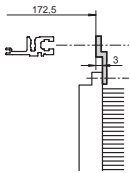
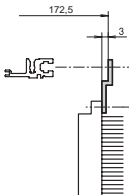
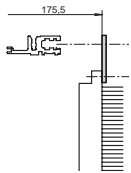
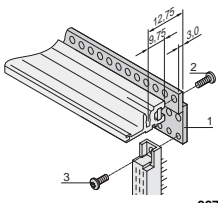
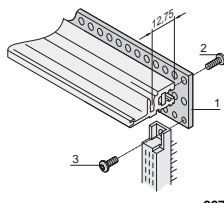
		Z-rail for connectors		Perforated rail
		for connector, IEC 60603-2, DIN EN 41612 Item 1	31-pin, DIN 41617	EN 60603-2, DIN 41612 Item 1
				
		BZA45849	BZA45850	BZA45848
				
		06708063		06708051
		for connector mounting with ST horizontal rails, please order threaded insert and screw separately	for connector mounting with ST horizontal rails, please order threaded insert and screw separately	for connector mounting with VT horizontal rails, please order threaded insert and screw separately
<b>Usable length</b>	<b>Length</b>	<b>1 piece</b>	<b>1 piece</b>	<b>PU 4 pieces</b>
<b>HP</b>	<b>mm</b>			
20	106.68	<b>30822-025</b>	—	<b>20822-051</b>
28	142.24	<b>30822-033</b>	—	<b>20822-049</b>
40	203.20	<b>30822-045</b>	<b>30819-763</b>	<b>20822-046</b>
42	213.36	<b>30822-047</b>	—	<b>20822-050</b>
60	304.80	<b>30822-065</b>	<b>30819-783</b>	<b>20822-047</b>
84	426.70	<b>30822-089</b>	<b>30819-808</b>	<b>20822-048</b>
Item 3, Torx countersunk screw to fix connector to perforated rail, M2.5 × 7, PU 100 pieces		<b>24560-147</b>	<b>24560-147</b>	<b>24560-147</b>
Item 2, Torx countersunk screw, to fix perforated rail to horizontal rail, M2.5 × 10, PU 100 pieces		<b>24560-148</b>	<b>24560-148</b>	<b>24560-148</b>

## Desk-top cases - *compacPRO*

### Guide rails for plug-in units and modules, one-piece, groove width 2 mm and 2.5 mm

#### Order Information

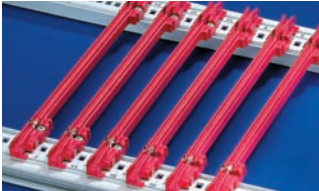
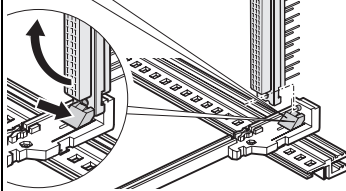
<b>Assembly</b> - can be clipped into Al extruded horizontal rails - can be clipped into 1.5 mm thick plates  <b>Storage temperature</b> from -40 °C ... 130 °C			<b>For plug-in units and frame-type plug-in units</b> <b>"Standard"</b>    up to 220 mm length, PBT, UL 94 V-0; from 280 mm length, multi-piece, end piece PBT, UL 94 V-0, middle section Al extrusion		PBT, UL 94 V-0	<b>With DIN connector fixing as standard</b>    PBT, UL 94 V-0; connector is clipped directly on the guide rail, only for Euroboards 100 x160 mm or 100 x 220 mm
<b>Board lengths mm</b>	<b>Groove width mm</b>	<b>Colour</b>	<b>PU 10 pieces</b>	<b>1 piece (SPQ 50)</b>	<b>PU 10 pairs</b>	
70	2	red	-	<b>34579-230</b>	-	
70	2	grey	-	<b>34579-231</b>	-	
160	2	red	<b>24560-351</b>	<b>64560-001</b>	<b>64560-074</b>	
220	2	red	<b>24560-353</b>	<b>64560-002</b>	<b>64560-075</b>	
280	2	red	<b>24560-379</b>	-	-	
340	2	red	<b>24560-380</b>	-	-	
160	2.5	red	-	<b>64560-096</b>	-	
220	2.5	red	-	<b>64560-098</b>	-	
Dimension drawings see page			6.39	6.39	6.39	

#### Accessories

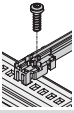
Retention screw, PU 100 pieces		<b>24560-141</b>
ESD clip, PU 50 pieces		<b>24560-255</b>

1) SPQ (standard pack quantity): Order number includes 1 piece, but delivery is exclusively made in standard pack quantity (SPQ); please order at least the SPQ quantity or a multiple thereof

2) Part no. includes one packing unit (PU); delivery is exclusively made in PU

**Description of accessories see from page 6.41**

## Desk-top cases - *compacPRO*

### Guide rails type "accessories", one-piece, groove width 2 mm and 2.5 mm

#### Order Information

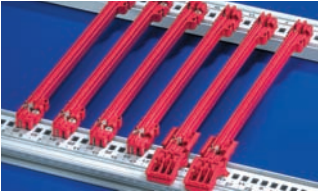
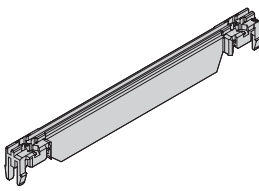
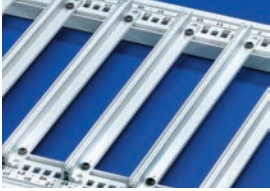
<b>Assembly</b> - can be clipped into Al extruded horizontal rails - can be clipped into 1.5 mm thick plates  <b>Storage temperature</b> from -40 °C ... 130 °C			<b>Guide rails type</b>			
			<b>"Accessories"</b>   <p style="font-size: small;">up to 220 mm length PBT, UL 94 V-0; from 280 mm length, multi-piece, end piece PBT, UL 94 V-0, middle section Al extrusion</p>	<b>"Accessories", strengthened</b>   <p style="font-size: small;">PBT, UL 94 V-0; support beam of guide rails adds to strengthening</p>	<b>For heavy modules, Al extrusion, silver, robust version</b>   <p style="font-size: small;">Al extrusion; is screwed to horizontal rail "heavy" with retention screws</p>	
<b>Board lengths mm</b>	<b>Groove width mm</b>	<b>Colour</b>	<b>PU 10 pieces</b>	<b>1 piece (SPQ 50)</b>	<b>1 piece (SPQ 50)</b>	<b>1 piece (SPQ 10)<sup>1)</sup></b>
100	2	red	–	<b>64560-082</b>	–	–
160	2	red	<b>24560-373</b>	<b>64560-005</b>	<b>64560-076</b>	–
160	2	grey	–	<b>64560-055</b>	–	<b>34562-881</b>
220	2	red	<b>24560-374</b>	<b>64560-006</b>	<b>64560-078</b>	–
220	2	grey	–	<b>64560-166</b>	–	<b>34562-882</b>
280	2	red/silver	<b>24560-375</b>	–	<b>64560-080</b>	<b>34562-883</b>
340	2	red/silver	<b>24560-376</b>	–	–	<b>34562-884</b>
400	2	red/silver	–	–	–	<b>34562-885</b>
160	2.5	silver	–	–	–	<b>34564-881</b>
220	2.5	silver	–	–	–	<b>34564-882</b>
280	2.5	silver	–	–	–	<b>34564-883</b>
340	2.5	silver	–	–	–	<b>34564-884</b>
400	2.5	silver	–	–	–	<b>34564-885</b>
Dimension drawings see page			6.39	6.39	6.39	6.39

#### Accessories

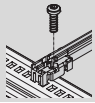
Retention screw, PU 100 pieces 	<b>24560-141</b>	<b>24560-141</b>	<b>24560-141</b>	<b>24560-157</b>
ESD clip, PU 50 pieces	<b>24560-255</b>	<b>24560-255</b>	<b>24560-255</b>	–
Board locking, red, PU 10 pieces	<b>24560-377</b>	<b>24560-377</b>	<b>24560-377</b>	–
Board handle, red, PU 10 pieces	<b>24560-378</b>	<b>24560-378</b>	<b>24560-378</b>	–
Identification strips for board handle, red, PU 1 sheet = 438 pieces	<b>60817-228</b>	<b>60817-228</b>	<b>60817-228</b>	–
Coding see page	see page 6.40			–

1) SPQ (standard pack quantity): Order number includes 1 piece, but delivery is exclusively made in standard pack quantity (SPQ); please order at least the SPQ quantity or a multiple thereof

2) Part no. includes one packing unit (PU); delivery is exclusively made in PU

Further guide rails see page 6.34

# Desk-top cases - *compacPRO*

## Mounting plates

### Order Information

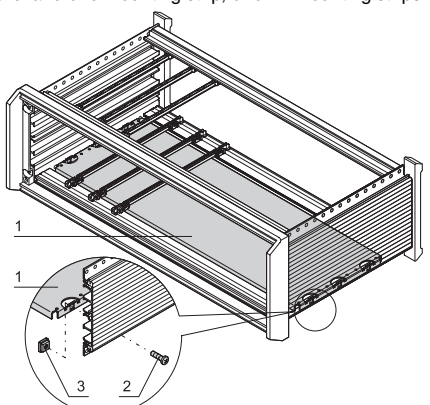
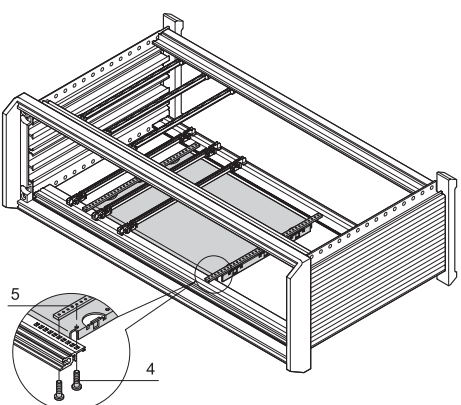
			<b>Mounting plate for fixing of heavy components</b>	
			<p>Mounting plate over entire width: mounting is on the side panels Mounting plate over partial width: mounting is on one side panel and one mounting strip, or on 2 mounting strips</p>  <p style="text-align: right; font-size: small;">06102501</p>	<p style="text-align: center;"><b>Assembly strip for partial widths</b></p>  <p style="text-align: right; font-size: small;">05806100</p>
			<p>Al, 1.5 mm; for mounting over partial width, please order fixing strips separately</p>	<p>St, 2 mm, zinc-plated; is bolted from front to rear onto the horizontal rails; to fix mounting plates</p>
<b>Width W</b>	<b>W</b>	<b>Board lengths</b>		
28	146.88	160	<b>34562-745</b>	<b>30840-021</b>
28	146.88	220	<b>34562-749</b>	<b>30840-033</b>
28	146.88	160	<b>34562-753</b>	30840-045
28	146.88	220	<b>34562-757</b>	<b>30840-057</b>
42	217.99	160	<b>34562-746</b>	<b>30840-021</b>
42	217.99	220	<b>34562-750</b>	<b>30840-033</b>
42	217.99	160	<b>34562-754</b>	30840-045
42	217.99	220	<b>34562-758</b>	<b>30840-057</b>
63	324.67	160	<b>34562-747</b>	<b>30840-021</b>
63	324.67	220	<b>34562-751</b>	<b>30840-033</b>
63	324.67	160	<b>34562-755</b>	30840-045
63	324.67	220	<b>34562-759</b>	<b>30840-057</b>
84	431.35	160	<b>34562-748</b>	<b>30840-021</b>
84	431.35	220	<b>34562-752</b>	<b>30840-033</b>
84	431.35	160	<b>34562-756</b>	30840-045
84	431.35	220	<b>34562-760</b>	<b>30840-057</b>
Assembly material for mounting plate, PU 1 kit (Torx countersunk screw M4 x 5, St, zinc-plated, 12 pieces; screw M4 x 6, St, zinc-plated 10 pieces; M4 square nut, St, zinc-plated, 10 pieces)			<b>24560-184</b>	-
Assembly kit for assembly strips of mounting plate, Torx screw M2.5 x 5, St, zinc-plated, PU 100 pieces			-	<b>24560-146</b>

### Note

- For installation and assembly of heavier components
- The mounting plate is as wide as the case and is fixed to the side panels
- A guide rail can be mounted on the first and last slot positions
- 4.4" and "strengthened" guide rails cannot be used

# Desk-top cases - *compact PRO*

## Dimensions

Extruded side panel 2 U

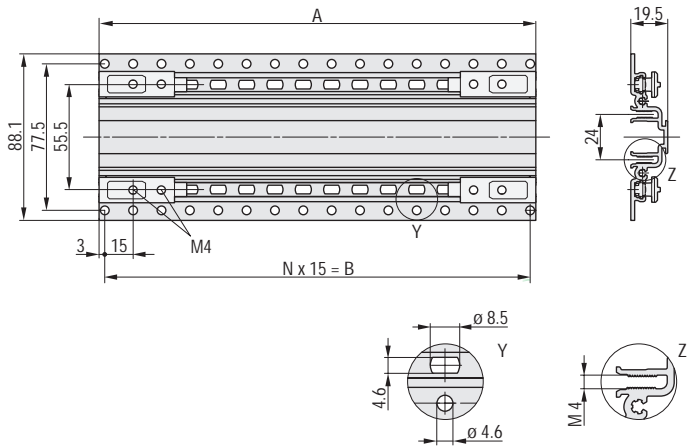

02004057

Extruded side panel 3 U

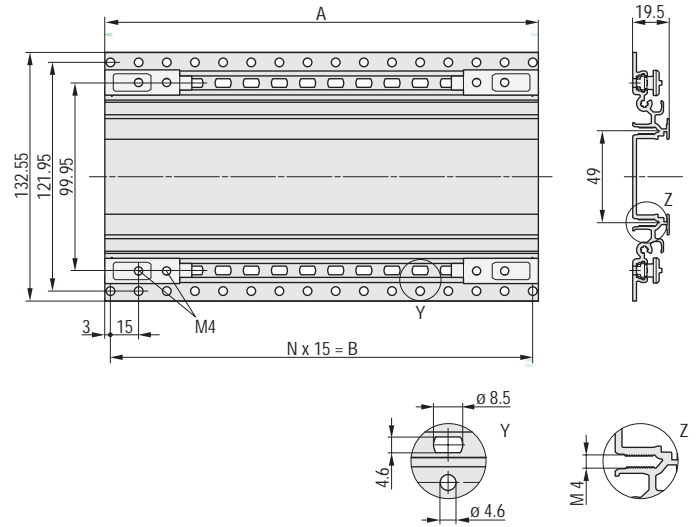

02004058

Extruded side panel 4 U

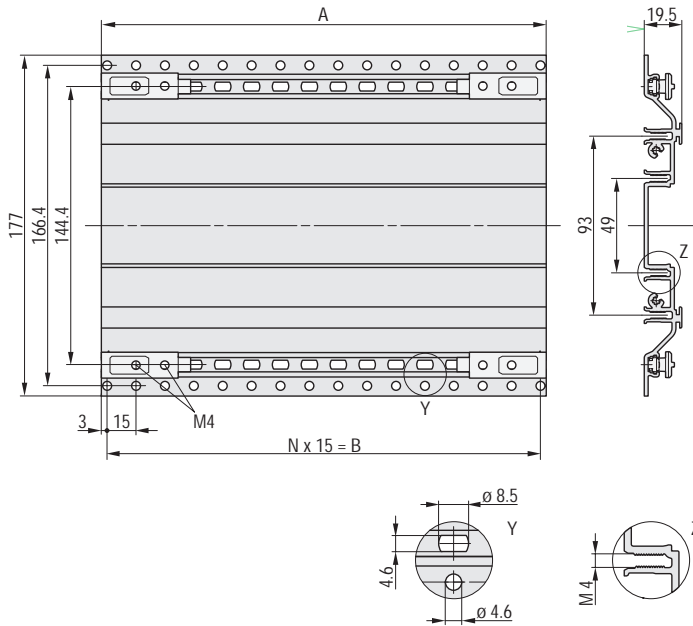

02004059

Extruded side panel 6 U

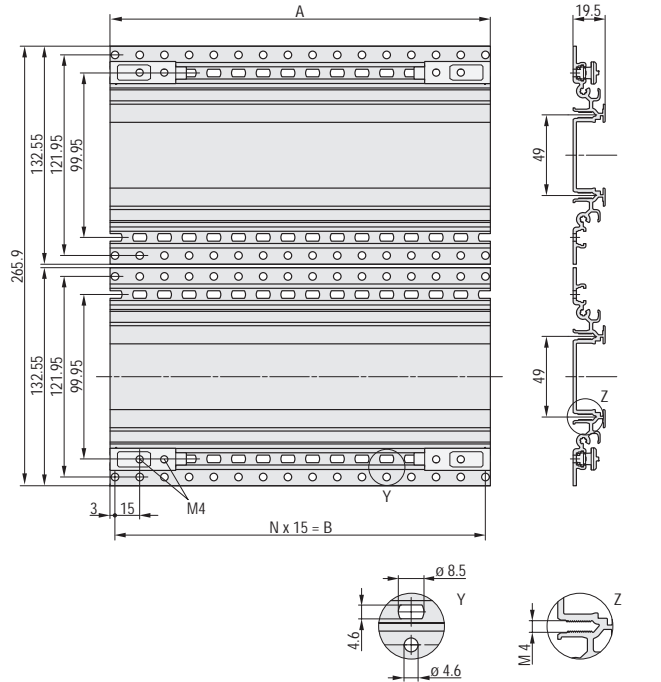

02004059

## Dimensions

For case depth	Max. mounting depth	Dimensions	
mm	mm	A in mm	B in mm
271	250	231	15 15 = 225
331	310	291	19 15 = 285
391	370	351	23 15 = 345
451	430	411	27 15 = 405
511	490	471	31 15 = 465

## Note

Side panel for 6 U case consists of two 3 U extruded side panels