

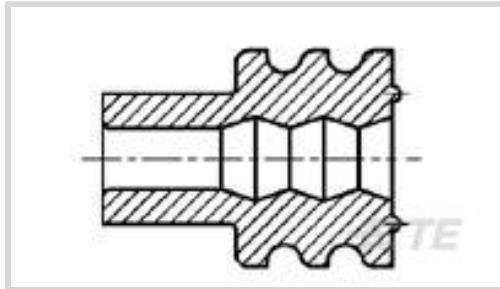

Connectors > Automotive Connectors > Seals & Cavity Plugs



Connector Seal Type: **Single Wire Seal (SWS)**

Cavity Diameter: **5.2 mm [.205 in]**

Accepts Cable Insulation Diameter Range: **2.7 – 3 mm [.106 – .118 in]**

Seal Material: **Silicone**

Resistance to Hydrocarbons: **Poor**

Features

Product Type Features

Connector Seal Type	Single Wire Seal (SWS)
---------------------	------------------------

Body Features

Seal Material	Silicone
Primary Product Color	Yellow

Dimensions

Cavity Diameter	5.2 mm[.205 in]
Accepts Cable Insulation Diameter Range	2.7 – 3 mm[.106 – .118 in]

Usage Conditions

Operating Temperature (Max)	65 °C, 70 °C, 75 °C, 80 °C, 85 °C, 90 °C, 100 °C, 105 °C, 110 °C, 120 °C, 125 °C, 130 °C [149 °F][158 °F][167 °F][176 °F][185 °F][194 °F][212 °F][221 °F][230 °F][248 °F][257 °F][266 °F]
Operating Temperature Range	-40 – 130 °C[-40 – 266 °F]

Industry Standards

UL Flammability Rating	None
------------------------	------

Other

Resistance to Hydrocarbons	Poor
Shore A Hardness	50



Contains Lubricant	Yes
--------------------	-----

Product Compliance

[For compliance documentation, visit the product page on TE.com>](#)

EU RoHS Directive 2011/65/EU	Compliant
EU ELV Directive 2000/53/EC	Compliant
China RoHS 2 Directive MIIT Order No 32, 2016	No Restricted Materials Above Threshold
EU REACH Regulation (EC) No. 1907/2006	Current ECHA Candidate List: JUNE 2022 (224) Candidate List Declared Against: JUNE 2022 (224) Does not contain REACH SVHC
Halogen Content	Low Halogen - Br, Cl, F, I < 900 ppm per homogenous material. Also BFR/CFR/PVC Free
Solder Process Capability	Not applicable for solder process capability

Product Compliance Disclaimer

This information is provided based on reasonable inquiry of our suppliers and represents our current actual knowledge based on the information they provided. This information is subject to change. The part numbers that TE has identified as EU RoHS compliant have a maximum concentration of 0.1% by weight in homogenous materials for lead, hexavalent chromium, mercury, PBB, PBDE, DBP, BBP, DEHP, DIBP, and 0.01% for cadmium, or qualify for an exemption to these limits as defined in the Annexes of Directive 2011/65/EU (RoHS2). Finished electrical and electronic equipment products will be CE marked as required by Directive 2011/65/EU. Components may not be CE marked. Additionally, the part numbers that TE has identified as EU ELV compliant have a maximum concentration of 0.1% by weight in homogenous materials for lead, hexavalent chromium, and mercury, and 0.01% for cadmium, or qualify for an exemption to these limits as defined in the Annexes of Directive 2000/53/EC (ELV). Regarding the REACH Regulation, the information TE provides on SVHC in articles for this part number is based on the latest European Chemicals Agency (ECHA) 'Guidance on requirements for substances in articles' posted at this URL: <https://echa.europa.eu/guidance-documents/guidance-on-reach>

Compatible Parts



TE Part # CAT-M8793-CH8172
MQS, CONNECTOR HOUSING



TE Part # CAT-AM705-CH8172
AMP MCP, SEALED CONNECTOR HOUSING



TE Part # 2138314-1
36P SEALED HYBRID (32X 1.2, 4X



TE Part # CAT-T4827-CH8172
TIMER, CONNECTOR HOUSING



TE Part # CAT-T4827-T273
TIMER, RECEPTACLE AND TAB



TE Part # CAT-AM705-T273
AMP MCP, RECEPTACLE AND TAB



TE Part # 1703661-1
6POS, MIXED, REC HSG, ASSY



TE Part # 3-2109313-2
060/110 HYB 8P SLD PLUG ASSY D



TE Part # 2209545-1
94P, MOS CB, REC HSG, ASSY, SEALED



TE Part # 1-284844-0
12 POS MCP HYBRID MALE CONNECTOR



TE Part # 2050225-1
66P ECU PLUG RECEPTACLE HOUSING



TE Part # 9-2368472-2
TYPE 2, CHARGE INLET ASSY, GENERAL



TE Part # 9-2368475-1
TYPE 1, CHARGE INLET ASSY, GENERAL



TE Part # 9-2368478-1
7POS, MIXED, SOCK HSG, INLET GB



TE Part # 1-2141876-3
TAB A 2.8x0.8 CONTACT CF SWS Au



TE Part # 1-929937-1
JPT REC 2.8 Contact SWS Au



TE Part # 2-2141876-2
TAB A 2.8x0.8 CONTACT CF SWS Ag



TE Part # 6-964296-6
TAB A 2.8x0.8 CONTACT SRC



TE Part # 6-964302-6
TAB A 2.8x0.8 CONTACT SWS

Also in the Series | Timer Connector System

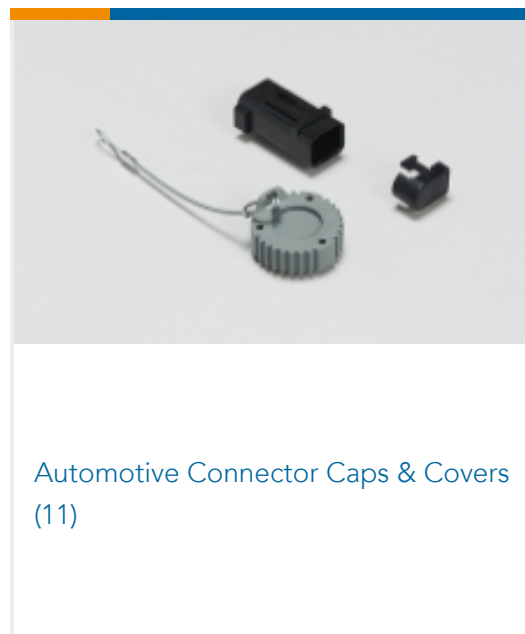

Automotive Connector Caps & Covers (11)



Automotive Connector Locks & Position Assurance (16)

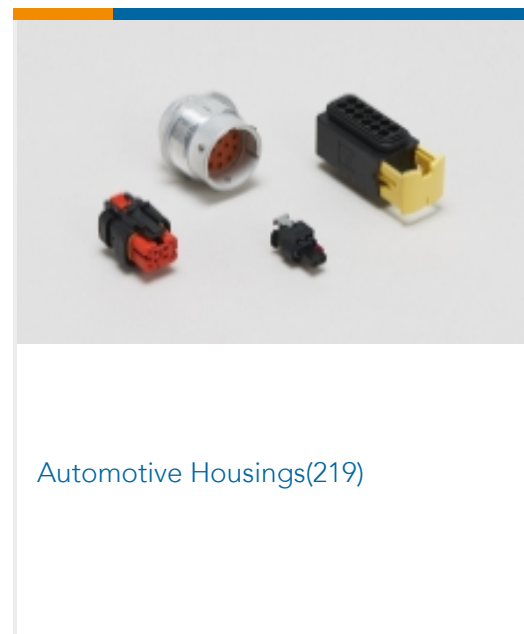

Automotive Housings (219)



Automotive Seals & Cavity Plugs (31)



Automotive Terminals(138)



Crimp Terminal Housings(13)



Insertion & Extraction Tools(20)



Other Automotive Connector Accessories(1)



PCB Headers & Receptacles(78)



Quick Disconnects(4)

Customers Also Bought



TE Part #2-1355200-2
MCP2,8REC HSG ASY2P

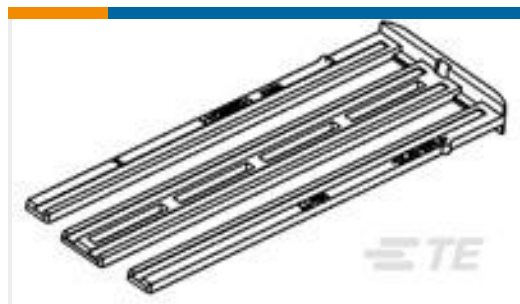

TE Part #1-1355134-1
RETAINER 94P



TE Part #1-968857-3
AMP MCP 2.8, CONTACT SWS



TE Part #7-1452665-3
MCON 1.2 LL REC SWS AG



TE Part #1437839-1
107322A=DBL XMAS TREE CLIP, BL

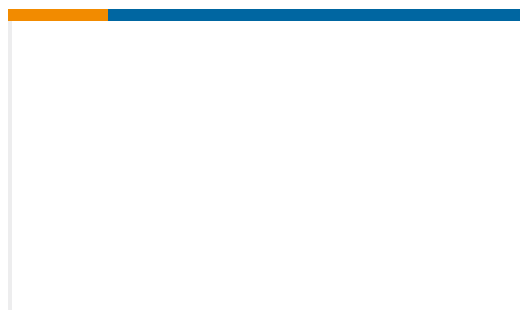

TE Part #206247P030
SCT-NO.4-E2-0-50MM



TE Part #1337101-1
BLANKING PLUG

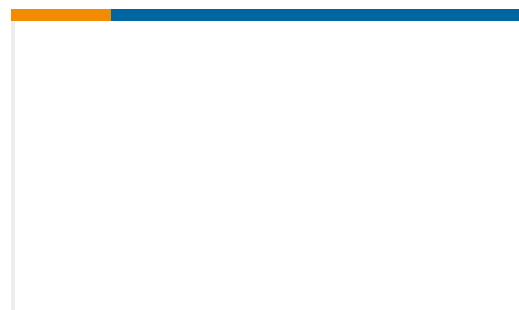

TE Part #1991218-1
4WAY SENSOR SKT ASSY, BLACK CODE A

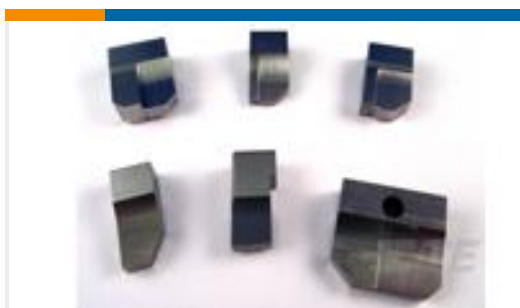

TE Part #3-879500-3
AMBOSS



TE Part #1337112-1
26 WAY RECPT. HSG. ASSY.

Documents



Product Drawings

WIRE SEALING 2,2

German

WIRE SEALING 2,2

English

CAD Files

Customer View Model

[ENG_CVM_963292-1_E2.3d_igs.zip](#)

English

Customer View Model

[ENG_CVM_963292-1_E2.3d_stp.zip](#)

English

Customer View Model

[ENG_CVM_963292-1_E2.2d_dxf.zip](#)

English

3D PDF

English

By downloading the CAD file I accept and agree to the [Terms and Conditions](#) of use.

Product Specifications

CAVITY PLUG (HYB 38P ISL PLUG)

English

Product Specification

Japanese

Product Specification

English

MQS CLEAN BODY PLUG ASSY 81P & 40P

Japanese

MQS CLEAN BODY PLUG ASSY 81P & 40P

Japanese

Product Specification

English

Product Environmental Compliance

[MD_963292-1_05032018328_dmtec](#)

English

[MD_963292-1_05032018328_dmtec](#)

English

Instruction Sheets

Instruction Sheet (non U.S.)

English

Instruction Sheet (non U.S.)

Japanese

963292-1

Automotive Seals & Cavity Plugs, Single Wire Seal (SWS), Cavity Diameter .205 in [5.2 mm], Silicone, Poor, 50, Timer Connector System

