

EAO – Your Expert Partner for Human Machine Interfaces

82-6561.1000 - Pushbutton 22 mm Aluminium

82-6561.1000 - Pushbutton 22 mm Aluminium



Attention: The preview is based on a sample product. This can differ from your current configuration.

Mounting

| | |
|------------------|-----------|
| Design | flush |
| Mounting cut-out | Ø 22,3 mm |

Front

| | |
|----------------------|-----------|
| Front shape | round |
| Front ring shape | flush |
| Front dimension | Ø 25 mm |
| Front bezel material | Aluminium |

Other Attributes

| | |
|--------|----------|
| Weight | 0,020 kg |
|--------|----------|

Operating-/Indication part

| | |
|-------------------|------------------|
| Lens optics | opaque |
| Lens material | Aluminium |
| Lens colour | natural anodized |
| Lens profile | flat |
| Lens illumination | non-illuminative |

IP-Rating

| | |
|------------------|------------|
| Front protection | IP65, IP67 |
|------------------|------------|

Connection Method

| | |
|----------|---------------------|
| Terminal | Solder 2.8 x 0.5 mm |
|----------|---------------------|

Actuator

| | |
|------------------|-----------|
| Switching action | Momentary |
|------------------|-----------|

Switching element

| | |
|-------------------|-------------------------------|
| Switching current | 3 A |
| Contact material | Silver |
| Contacts | 1 C |
| Switching system | Snap-action switching element |
| Switching voltage | 240 V AC/DC |

Function

| |
|------------|
| Pushbutton |
|------------|

EAO – Your Expert Partner for Human Machine Interfaces

82-6561.1000 - Pushbutton 22 mm Aluminium

Dimensions

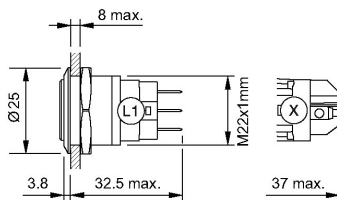

Mounting cut-outs

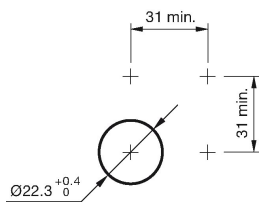

Wiring diagram

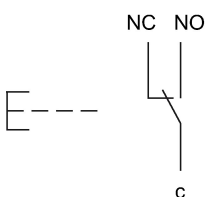

Component layout

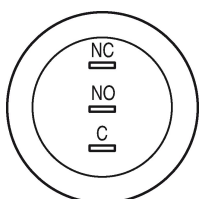

Legend

Switching action: B = Momentary
Contacts: C = Changeover