

# Data sheet Illuminated pushbutton Ø 22 mm silver contact.

Part No.: 82-6552.2133

## Technical data



|                       |  |
|-----------------------|--|
| Terminal              | Screw terminal                               |
| Shape of illumination | Ring   |
| Operating voltage     | 12 V AC/DC                                   |
| Operating Travel      | ca. 3 mm                                     |
| Lens illumination     | illuminative                                 |
| Lens colour           | Nature                                       |
| Lens shape            | flush  |
| Lens material         | Aluminium                                    |
| Lens surface          | anodised                                     |
| Lens optics           | opaque                                       |
| Front bezel shape     | flush  |
| Front bezel material  | Aluminium                                    |
| Weight                | 0.018 kg                                     |
| Contact material      | Silver                                       |
| Illumination colour   | Green  |
| Kind of illumination  | Single-LED                                   |
| Switching action      | Maintained                                   |
| Switching system      | Snap-action switching element                |
| Contacts              | 1 FS   |
| Operating temperature | - 30 °C ... + 70 °C                          |
| Approbations          | CB, CCC, C UL, UL                            |
| Operating force       | 4 ... 7 N                                    |
| Climate resistance    | Damp heat, 21 days according to IEC 60512-11 |

## Dimensions

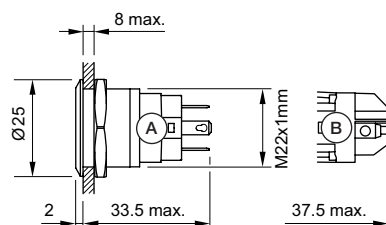

A = Solder terminal  
B = Screw terminal

## Mounting cut-outs

---

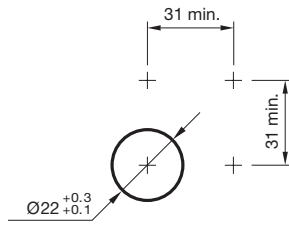

## Wiring diagrams

---

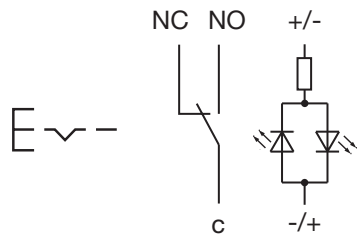

## Component layouts

---

