

# Data sheet Illuminated pushbutton Ø 22 mm silver contact.

Part No.: 82-6552.1124

## Technical data



Terminal	Screw terminal
Shape of illumination	Ring
Operating voltage	24 V AC/DC
Operating Travel	ca. 3 mm
Lens illumination	illuminative
Lens colour	Nature
Lens shape	flush
Lens material	Aluminium
Lens surface	anodised
Lens optics	opaque
Front bezel shape	flush
Front bezel material	Aluminium
Weight	0.018 kg
Contact material	Silver
Illumination colour	Blue
Kind of illumination	Single-LED
Switching action	Momentary
Switching system	Snap-action switching element
Contacts	1 FS
Operating temperature	- 30 °C ... + 70 °C
Approbations	CB, CCC, C UL, UL
Operating force	4 ... 7 N
Climate resistance	Damp heat, 21 days according to IEC 60512-11

## Dimensions

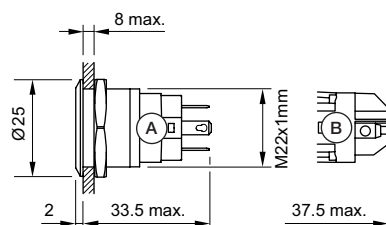

A = Solder terminal  
B = Screw terminal

## Mounting cut-outs

---

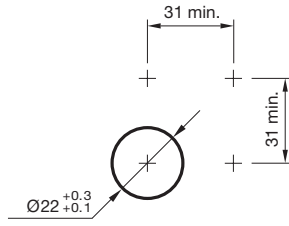

## Wiring diagrams

---

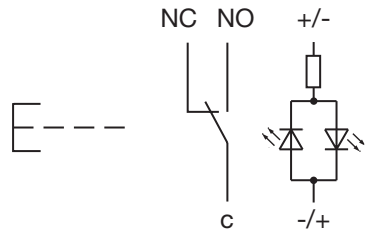

## Component layouts

---

