

Combination Insulated Tab - Solder Terminal Strips

401-LF | 12.00 mm (0.473 in) Spacing - 1-12 poles

PICTURES



401-LF

TECHNICAL INFORMATION

Description

Available in PA or PVC

Recommended mounting hardware: M3 pan head screw (#4-40 pan head screw) or similar sized sheet metal screw, self-tapping screw or rivet.

This version may also be used as a solder connector.

Technical Data

Center to Center Spacing: 12.000 mm (0.473 in)

Nominal Cross Section: 2.5 mm² (3875 mils²)

Bill of Materials

Pole Version : PVC

Molding : Plasticised PVC,

Color : Transparent

Temperature limits :

Short Time : 80°C (176°F)

Continuous : 70°C (158°F)

Temperature Limits : PVC version (minimum values)

Comparative Tracking Index : CTI ? 400 V

Pole Version : PA

Molding : Polyamide,

Color : Off-white

Temperature limits :

Short Time : 140°C (284°F)

Continuous : 105°C (221°F)

Low Limit : -40°C (-40°F)

Temperature Limits : PA version

Oxygen Index Rating : 25 %

Tabs: Tin plated copper alloy 2.8 mm (0.110 in.), 4.8 mm (0.187 in.) or 6.3 mm (0.250 in.)

APPROVAL INFORMATION

25A is related to 6.3 mm tab 4.8 mm tab current rating is 15A

International Approval Information

Rated Impulse Withstand Voltage : 4000 V

TECHNICAL DRAWING

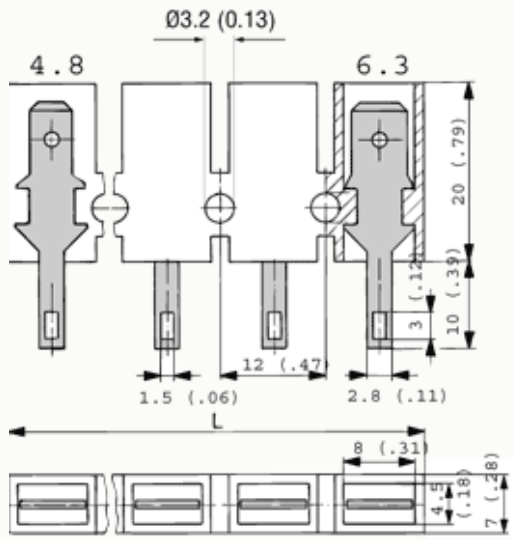

Description :

Length of Connector (L)

L = No. of Poles x Center to Center Spacing - 2 mm

SECTION D - SERIES 400-LF**Tab and Solder Connectors for Panel / Chassis Mounting**

The 400-LF Series provides a quick-connect tab on one side of the terminal strip and a solder tab on the other side. Tabs are available in the following sizes: 2.8 mm (0.11 in.), 4.8 mm (0.187 in.) and 6.3 mm (0.25 in.). Uninsulated female quick-on connectors must be used on the quick-connect side.

Each product has a "How To Order" area as well as a complete listing of UL and CSA approval specifications, available options and accessories.