

communication module PROFINET standard



Product brand name	SIRIUS
Product category	Communication modules
Product designation	Communication module
Design of the product	PROFINET Standard
Manufacturer's article number	
• of soft starter	3RW51
• of soft starter	3RW52
• of soft starter	3RW55

General technical data	
Protection class IP	IP20
Reference code acc. to DIN EN 81346-2	A

Installation/ mounting/ dimensions	
Mounting position	any
(mounting type)	screw fixing
Height	126 mm
Width	28 mm
Depth	82 mm
Installation altitude at height above sea level maximum	5 000 m; Derating as of 1000 m, see catalog

Weight without packaging	0.1 kg
--------------------------	--------

Ambient conditions

Ambient temperature	
<ul style="list-style-type: none"> during operation during storage and transport 	<p>-25 ... +60 °C; observe derating of basic unit above 40 °C</p> <p>-40 ... +80 °C</p>

Environmental category	
<ul style="list-style-type: none"> during operation acc. to IEC 60721 during storage acc. to IEC 60721 during transport acc. to IEC 60721 	<p>3K6 (no ice formation, only occasional condensation), 3C3 (no salt mist), 3S2 (sand must not get into the devices), 3M6</p> <p>1K6 (only occasional condensation), 1C2 (no salt mist), 1S2 (sand must not get inside the devices), 1M4</p> <p>2K2, 2C1, 2S1, 2M2 (max. height of fall 0.8 m)</p>

General Product Approval	Declaration of Conformity
---------------------------------	----------------------------------



[Miscellaneous](#)

Test Certificates	Marine / Shipping	other
--------------------------	--------------------------	--------------

[Type Test Certificates/Test Report](#)



[Confirmation](#)

[PROFINET-Certification](#)

Further information

Information- and Downloadcenter (Catalogs, Brochures,...)

<http://www.siemens.com/industrial-controls/catalogs>

Industry Mall (Online ordering system)

<https://mall.industry.siemens.com/mall/en/en/Catalog/product?mlfb=3RW5980-0CS00>

Cax online generator

<http://support.automation.siemens.com/WW/CAXorder/default.aspx?lang=en&mlfb=3RW5980-0CS00>

Service&Support (Manuals, Certificates, Characteristics, FAQs,...)

<https://support.industry.siemens.com/cs/ww/en/ps/3RW5980-0CS00>

Image database (product images, 2D dimension drawings, 3D models, device circuit diagrams, EPLAN macros, ...)

http://www.automation.siemens.com/bilddb/cax_de.aspx?mlfb=3RW5980-0CS00&lang=en

Characteristic: Tripping characteristics, I²t, Let-through current

<https://support.industry.siemens.com/cs/ww/en/ps/3RW5980-0CS00/char>

Characteristic: Installation altitude

<http://www.automation.siemens.com/bilddb/index.aspx?view=Search&mlfb=3RW5980-0CS00&objecttype=14&gridview=view1>

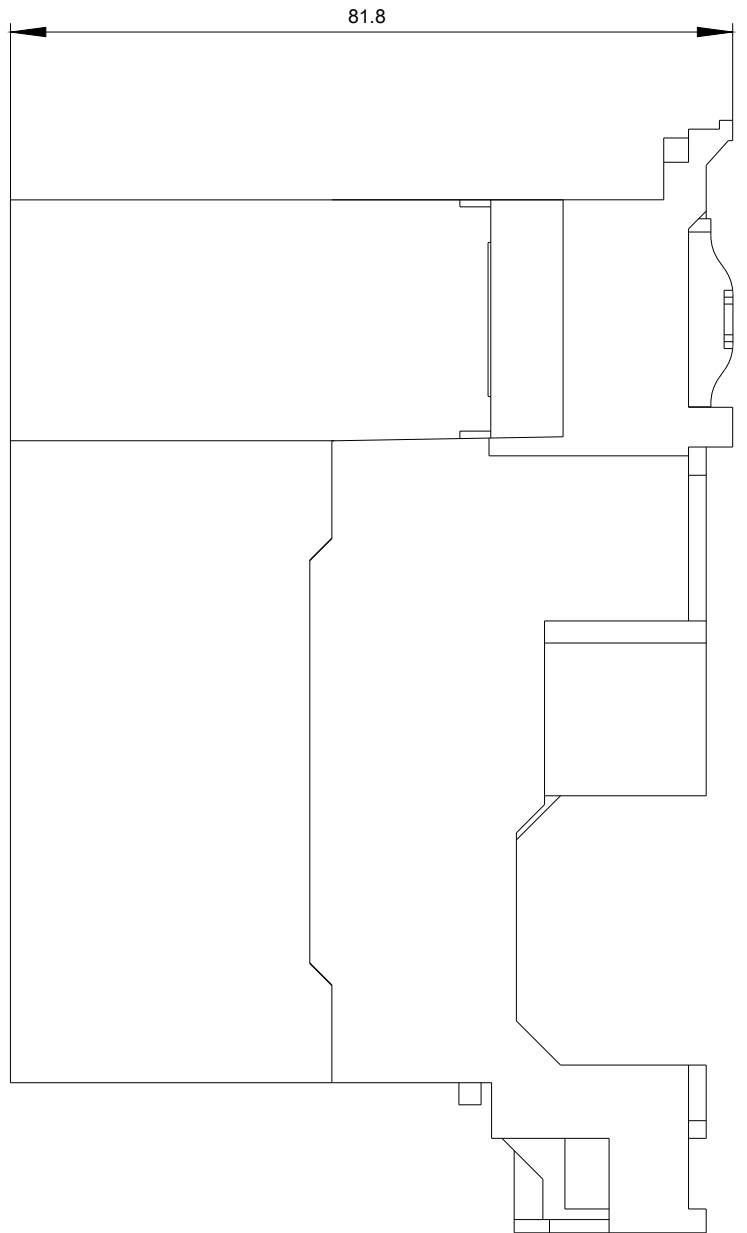
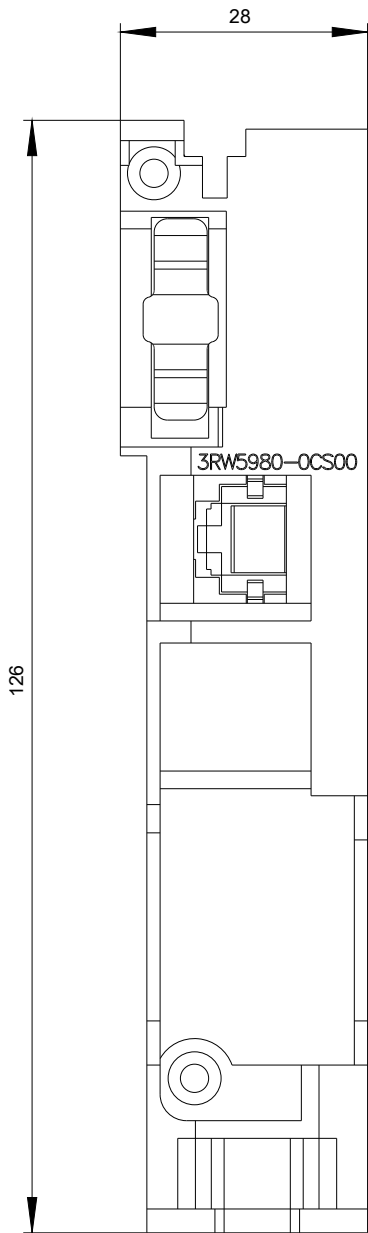

A

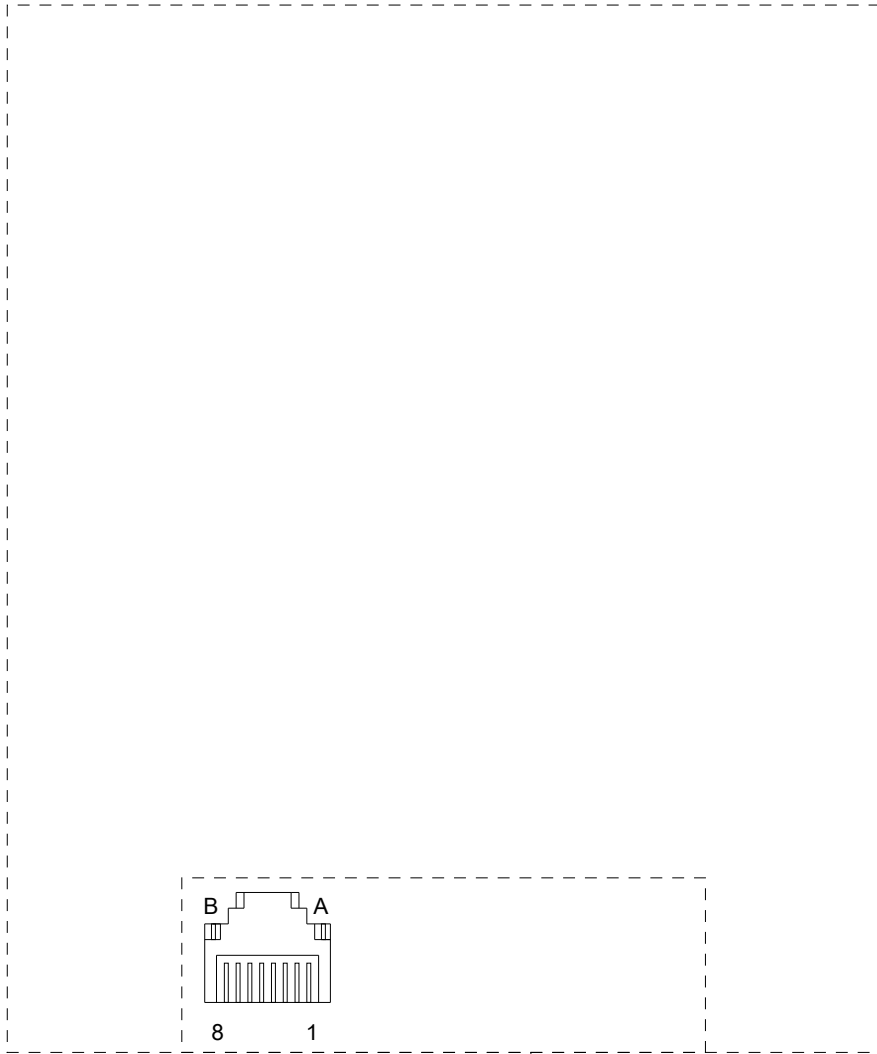

-X1:P1

last modified:

04/03/2019