

## BOURNS type 3214 (4mm square, surface mount)

Sealed, multiturn cermet trimming potentiometers in a range of values from 10Ω to 2MΩ. The devices are available in a choice of flush fitting top or side adjust orientations utilising an advanced drive/wiper mechanism and feature pick and place centering design.

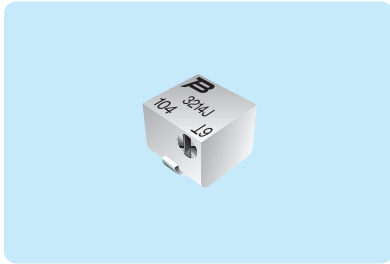

- ◆ 4mm square surface mount body
- ◆ Cermet element
- ◆ Sealed for board washing
- ◆ Multiturn (5 turns)
- ◆ Top or side adjust
- ◆ Supplied taped & reeled

### Specification

#### Electrical Characteristics

Resistance range .....	10Ω to 2MΩ
Resistance tolerance .....	±10%
Absolute minimum resistance .....	1% or 2Ω max. (whichever is greater)
Contact resistance variation .....	3% or 3Ω max. (whichever is greater)
Resolution .....	Infinite
Insulation resistance .....	100MΩ min. at 500Vdc
Dielectric strength .....	600Vac for 1 minute
Effective travel .....	5 turns nominal

#### Environmental Characteristics

Power rating .....	0.25W at 300V/85°C max.
Temperature range .....	-65°C to +150°C
Temperature coefficient .....	±100ppm/°C
Humidity .....	MIL-STD-202 method 106
total resistance shift .....	2% max./10MΩ insulation resistance
Vibration .....	20G
total resistance shift .....	1% max.
voltage ratio shift .....	1% max.
Shock .....	100G
total resistance shift .....	1% max.
voltage ratio shift .....	1% max.
Load life .....	1000 hours 0.25W at 85°C
total resistance shift .....	3Ω or 3% max. (whichever is greater)
Rotational life .....	200 cycles
total resistance shift .....	3Ω or 3% max. (whichever is greater)
Thermal shock .....	5 cycles
total resistance shift .....	2% max.
voltage ratio shift .....	1% max.

#### Physical Characteristics

Operating torque .....	180g/cm max.
Mechanical stops .....	Wiper idles (clutching action)
Wiper positioning .....	50% nominal
Flammability .....	UL94V-0

Value (Ω)	Manf. Part No. & Anglia Order Code	
	3214W	3214G
	Top adjust	Side adjust
10R	3214W-1-100E	3214G-1-100E
20R	3214W-1-200E	3214G-1-200E
50R	3214W-1-500E	3214G-1-500E
100R	3214W-1-101E	3214G-1-101E
200R	3214W-1-201E	3214G-1-201E
500R	3214W-1-501E	3214G-1-501E
1K	3214W-1-102E	3214G-1-102E
2K	3214W-1-202E	3214G-1-202E
5K	3214W-1-502E	3214G-1-502E
10K	3214W-1-103E	3214G-1-103E
20K	3214W-1-203E	3214G-1-203E
50K	3214W-1-503E	3214G-1-503E
100K	3214W-1-104E	3214G-1-104E
200K	3214W-1-204E	3214G-1-204E
500K	3214W-1-504E	3214G-1-504E
1M	3214W-1-105E	3214G-1-105E
2M	3214W-1-205E	3214G-1-205E



• Other styles available

Please contact our Sales Desk for details

### Dimensions (mm)

3214W (top adjust)

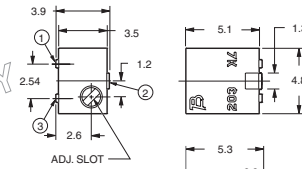

Pad Pattern

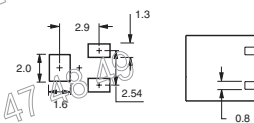

3214G (side adjust)

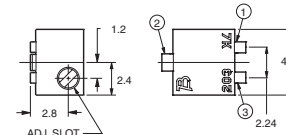

Pad Pattern

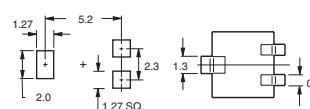

### Circuit Diagram

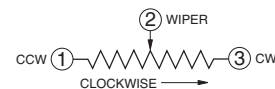

### Packaging

TAPE : 3214G - 12mm wide, 8mm pitch  
3214W - 16mm wide, 12mm pitch

REEL : 178mm dia.

## BOURNS type 3224 (4mm square, surface mount)

Sealed, multiturn cermet trimming potentiometers in a range of values from 10Ω to 2MΩ with low contact resistance variation. The devices are available in a choice of flush fitting top or side adjust orientations and feature pick and place centering design.

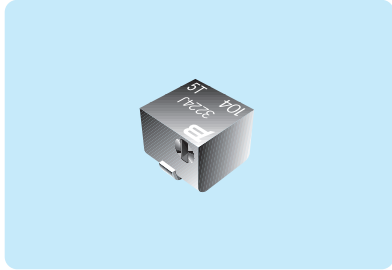

- ◆ 4mm square surface mount body
- ◆ Cermet element
- ◆ Sealed for board washing
- ◆ Multiturn (11 turns)
- ◆ Top or side adjust
- ◆ Low contact resistance variation
- ◆ Supplied taped & reeled



### Specification

#### Electrical Characteristics

Resistance range	10Ω to 2MΩ
Resistance tolerance	±10%
Absolute minimum resistance	1% or 2Ω max. (whichever is greater)
Contact resistance variation	1% or 3Ω max. (whichever is greater)
Resolution	Infinite
Insulation resistance	100MΩ min. at 500Vdc
Dielectric strength	600Vac for 1 minute
Effective travel	11 turns nominal

#### Environmental Characteristics

Power rating	0.25W at 300V/85°C max
Temperature range	-65°C to +150°C
Temperature coefficient	100ppm/°C
Humidity	MIL-STD-202 method 106
total resistance shift	2% max./10MΩ insulation resistance
Vibration	20G
total resistance shift	1% max.
voltage ratio shift	1% max.
Shock	100G
total resistance shift	1% max.
voltage ratio shift	1% max.
Load life	1000 hours 0.25W at 85°C
total resistance shift	3Ω or 3% max. (whichever is greater)
Rotational life	200 cycles
total resistance shift	3Ω or 3% max. (whichever is greater)
Thermal shock	5 cycles
total resistance shift	2% max.
voltage ratio shift	1% max.

#### Physical Characteristics

Operating torque	180g/cm max.
Mechanical stops	Wiper idles (clutching action)
Wiper positioning	50% nominal
Flammability	UL94V-0

### Dimensions (mm)

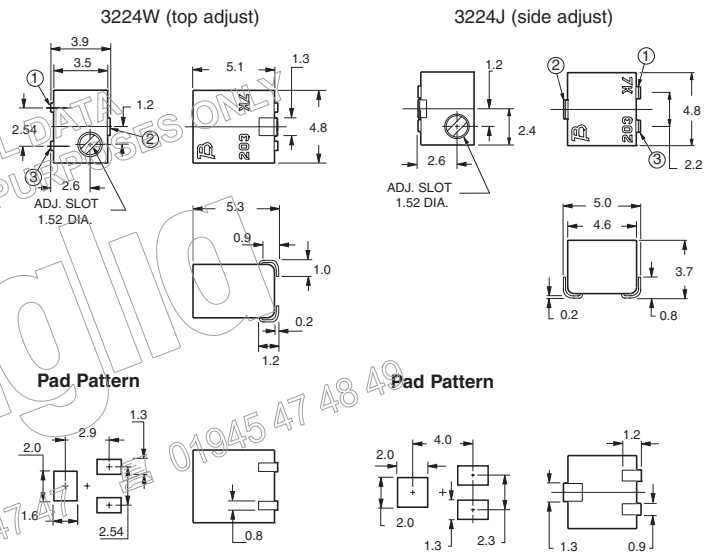

### Circuit Diagram

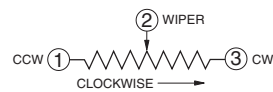

### Packaging

TAPE : 3224J - 12mm wide, 8mm pitch      REEL : 178mm dia.  
 3224W - 16mm wide, 12mm pitch

Value (Ω)	Manf. Part No. & anglia Order Code	
	3224W Top adjust	3224J Side adjust
10R	3224W-1-100E	3224J-1-100E
20R	3224W-1-200E	3224J-1-200E
50R	3224W-1-500E	3224J-1-500E
100R	3224W-1-101E	3224J-1-101E
200R	3224W-1-201E	3224J-1-201E
500R	3224W-1-501E	3224J-1-501E
1K	3224W-1-102E	3224J-1-102E
2K	3224W-1-202E	3224J-1-202E
5K	3224W-1-502E	3224J-1-502E
10K	3224W-1-103E	3224J-1-103E
20K	3224W-1-203E	3224J-1-203E
25K	3224W-1-253E	-
50K	3224W-1-503E	3224J-1-503E
100K	3224W-1-104E	3224J-1-104E
200K	3224W-1-204E	3224J-1-204E
250K	3224W-1-254E	-
500K	3224W-1-504E	3224J-1-504E
1M	3224W-1-105E	3224J-1-105E
2M	3224W-1-205E	3224J-1-205E

• Other styles available

Please contact our Sales Desk for details