

# EAO – Your Expert Partner for Human Machine Interfaces

## 31-423.036 - Illuminated pushbutton actuator

### 31-423.036 - Illuminated pushbutton actuator

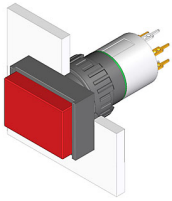

*Attention: The preview is based on a sample product. This can differ from your current configuration.*

#### Mounting

Mounting cut-out	Ø 16 mm
Design	raised

#### Front

Front shape	rectangular
Front dimension	18 mm x 24 mm
Front bezel colour	black
Front bezel material	Plastic

#### Other Attributes

Weight	0,007 kg
--------	----------

#### Operating-/Indication part

Lens illumination	illuminative
-------------------	--------------

#### IP-Rating

Front protection	IP40
------------------	------

#### Connection Method

Terminal	Universal 2.0 x 0.5 mm
----------	------------------------

#### Actuator

Switching action	Momentary
Housing colour	black
Housing material	Plastic

#### Switching element

Switching system	Low-level element
Contacts	1 NC + 1 NO
Switching voltage	42 V AC/DC
Switching current	0.1 A
Contact material	

#### Function

Illuminated pushbutton
------------------------

# EAO – Your Expert Partner for Human Machine Interfaces

31-423.036 - Illuminated pushbutton actuator

## Dimensions

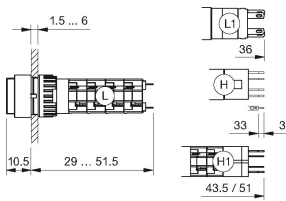

H = Universal terminal 2.0 x 0.5 mm

## Mounting cut-outs

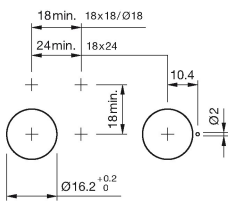

## Wiring diagram

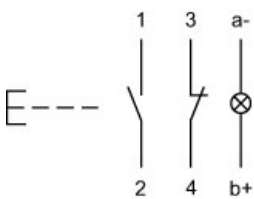

## Component layout

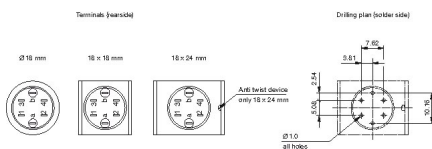

## Legend

Contacts: NC = Normally closed, NO = Normally open  
Switching action: B = Momentary