

### E-Box EB

Catalogue 33, page 37

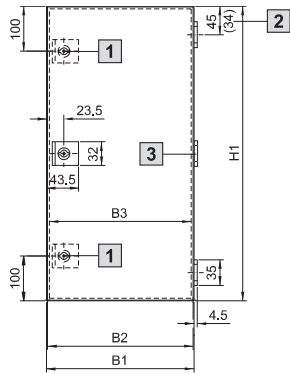

**1** For EB 1557.500/  
EB 1578.500/EB 1579.500  
two locks

**2** For EB 1551.500  
and EB 1553.500

**3** Only for EB 1579.500

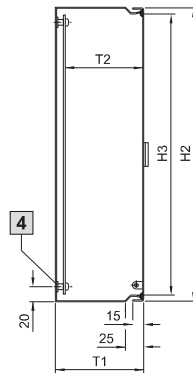

**4** View A

Mounting plate

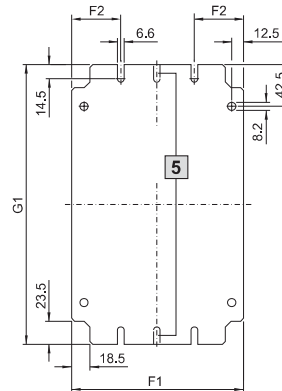

**5** For 125 mm wide  
mounting plates,  
attachment is in the  
centre only

View A  
for wall mounting

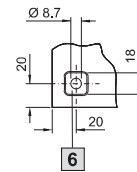

**6** 2 mm recessed

- B1 = Overall width
- B2 = Door width
- B3 = Clearance width
- H1 = Overall height
- H2 = Door height
- H3 = Clearance height
- T1 = Overall depth
- T2 = Clearance depth  
available for installation
- F1 = Mounting plate width
- F2 = Outer edge to centre  
mounting holes
- G1 = Mounting plate height

Model No. EB	Width dimensions mm			Height dimensions mm			Depth dimensions mm		Mounting plate dimensions mm		
	B1	B2	B3	H1	H2	H3	T1	T2	F1	F2	G1
<b>1551.500</b>	150	148	132	150	148	132	80	65	125	62.5	135
<b>1545.500</b>	150	148	132	300	298	282	80	65	125	62.5	285
<b>1546.500</b>	200	198	182	200	198	182	80	65	175	50	185
<b>1552.500</b>	200	198	182	300	298	282	80	65	175	50	285
<b>1547.500</b>	200	198	182	400	398	382	80	65	175	50	385
<b>1553.500</b>	150	148	132	150	148	132	120	105	125	62.5	135
<b>1548.500</b>	150	148	132	300	298	282	120	105	125	62.5	285
<b>1549.500</b>	200	198	182	200	198	182	120	105	175	50	185
<b>1554.500</b>	200	198	182	300	298	282	120	105	175	50	285
<b>1550.500</b>	200	198	182	400	398	382	120	105	175	50	385
<b>1555.500</b>	300	298	282	300	298	282	120	105	275	50	285
<b>1556.500</b>	300	298	282	400	398	382	120	105	275	50	385
<b>1557.500</b>	200	198	182	500	498	482	120	105	175	50	485
<b>1577.500</b>	300	298	282	400	398	382	155	140	275	50	385
<b>1578.500</b>	300	298	282	600	598	582	155	140	275	50	585
<b>1579.500</b>	300	298	282	800	798	782	155	140	275	50	785