

Electronic housing - UCS 195-145-H-GD 7035 - 2203338

Please be informed that the data shown in this PDF Document is generated from our Online Catalog. Please find the complete data in the user's documentation. Our General Terms of Use for Downloads are valid (<http://phoenixcontact.com/download>)



Complete housing for PCBs, can be positioned flexibly; includes housing half shells, side panels closed, adhesive domes for PCB attachment, screws for housing and PCB attachment; light gray housing with turquoise-green corner inlays

Why buy this product

- ✓ High degree of application flexibility, thanks to the modular housing design
- ✓ Flexible PCB attachment, adapts to virtually all form factors
- ✓ Practical customization options
- ✓ Reduced logistics outlay, thanks to components which are compatible with one another
- ✓ High degree of application flexibility, thanks to the modular housing design
- ✓ Flexible PCB attachment, adapts to virtually all form factors
- ✓ Practical customization options
- ✓ Reduced logistics outlay, thanks to components which are compatible with one another



Key Commercial Data

Packing unit	1 STK
GTIN	 4 055626 404509
GTIN	4055626404509
Weight per Piece (excluding packing)	343.160 g
Custom tariff number	85389099
Country of origin	Germany

Technical data

General

Housing type	Universal housings
Housing material	PC
Color (RAL)	gray (7035)

Ambient conditions

Ambient temperature (storage/transport)	-40 °C ... 70 °C
---	------------------

Electronic housing - UCS 195-145-H-GD 7035 - 2203338

Technical data

Ambient conditions

Ambient temperature (assembly)	-5 °C ... 100 °C
Ambient temperature (operation)	-40 °C ... 100 °C (depending on power dissipation)

Dimensions for the product

Height [h]	145 mm
Width [w]	195 mm
Depth [d]	67 mm

Standards and Regulations

Flammability rating according to UL 94	V0
--	----

Drawings

Dimensional drawing

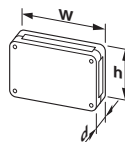

Classifications

eCl@ss

eCl@ss 5.1	27180506
eCl@ss 6.0	27180800
eCl@ss 7.0	27182702
eCl@ss 8.0	27182702
eCl@ss 9.0	27182702

ETIM

ETIM 5.0	EC001031
ETIM 6.0	EC001031

Accessories

Accessories

Screwdriver tools

Screwdriver - SF-TXH 10X80 - 1200149



Screwdriver, Torx® with bore hole, TX 10 x 80, two-component handle

