

**Industrial Ethernet  
IE-FCI-HDMI-FF**

**Weidmüller Interface GmbH & Co. KG**  
Klingenbergstraße 16  
D-32758 Detmold  
Germany  
Fon: +49 5231 1429-0  
Fax: +49 5231 14292083  
www.weidmueller.com



FrontCom® Vario integrates multiple functions in only one single frame. The system is easy to install and you can select from a wide range of data, signal and power modules. In addition to being extremely compact, FrontCom® Vario offers a number of unique product features that will make your project planning and work activities secure, fast and future-proof. Furthermore, the FrontCom® Vario system has an attractive housing design that, by the way, offers highest impact-resistance and fully meets the requirements of IP 65 protection class.

**General ordering data**

Type	IE-FCI-HDMI-FF
Order No.	<a href="#">2003390000</a>
Version	FrontCom, HDMI coupling, Signal insert HDMI, Socket / socket
GTIN (EAN)	4050118387414
Qty.	1 pc(s).

## Data sheet

### Industrial Ethernet IE-FCI-HDMI-FF

**Weidmüller Interface GmbH & Co. KG**  
 Klingenbergstraße 16  
 D-32758 Detmold  
 Germany  
 Fon: +49 5231 1429-0  
 Fax: +49 5231 14292083  
 www.weidmueller.com

## Technical data

### Dimensions and weights

Net weight	11 g
------------	------

### Temperatures

Operating temperature	-15 °C...50 °C	Storage temperature
Installation temperature		

### General data

Insert type	Signal insert HDMI	Product type	HDMI coupling
Protection degree	IP20		

### Classifications

ETIM 5.0	EC000456	ETIM 6.0	EC001121
UNSPSC	31-16-23-03	eClass 6.2	27-25-05-04
eClass 7.1	27-18-92-17	eClass 8.1	27-18-92-17
eClass 9.0	27-18-92-17	eClass 9.1	27-18-90-90

### Approvals

ROHS	Conform
------	---------

**Industrial Ethernet  
IE-FCI-HDMI-FF**

**Weidmüller Interface GmbH & Co. KG**  
Klingenbergstraße 16  
D-32758 Detmold  
Germany  
Fon: +49 5231 1429-0  
Fax: +49 5231 14292083  
www.weidmueller.com

**Drawings**

**Dimensioned drawing**

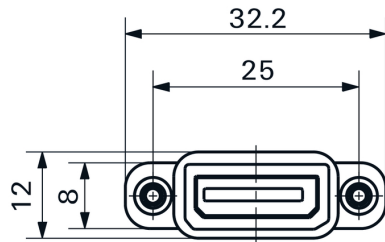

**Dimensioned drawing**

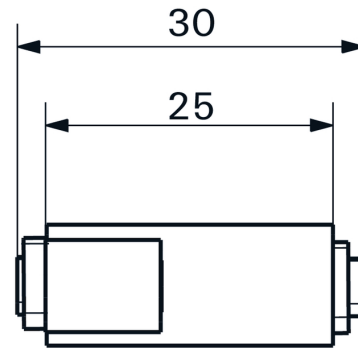

**Dimensioned drawing**

