



Interrupteur à incorporer 2p, rouge No. d'article 16 7546



Product data - type SR-13A

pattern no.	:	2
ratings	:	250 V~ : 8(8) A, 10(4) A, 10(6) A, 16(8) A, 20(3) A 400 V~ : 10(4) A
type reference	:	common type (C.T.)
type of switch	:	incorporated
circuit to be controlled	:	resistive and motor
contact opening	:	full disconnection
frequency of operation	:	- 10.000 operating cycles for 16(8) A, 20(3) A, 10(4) A (250 V~) - 50.000 operating cycles for 8(8) A, 10(4) A, 10(6) A (250 V~) - 10.000 operating cycles for 10(4) A (400 V~)
class	:	for class II appliances
degree of protection	:	IP40
degree of pollution	:	2
category to heat and fire	:	level 3
insulating material	:	tracking resistant (250 V)
rated impulse withstand voltage	:	2500 V
material group	:	IIIa
terminals	:	- tab terminals (6,3 x 0,8 mm) - solder terminals in different designs and PCB terminals
description	:	body and actuating member of thermoplastic material
markings	:	trade mark, type reference, electrical rating and temperature limit on the body

Additional information

Additional tests according to Clause 30 of the following standards are performed with positive results:

- IEC 60335-1:2001
- EN 60335-1:2002

Resistance to heat and fire: Insulation material around connections within an area of 3,0 mm.

- Glow-wire test 750°C; no flame.
- Glow-wire test 850°C; flame, if any, extinguished within 30 seconds after removal of the glow-wire.



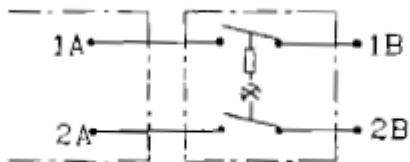
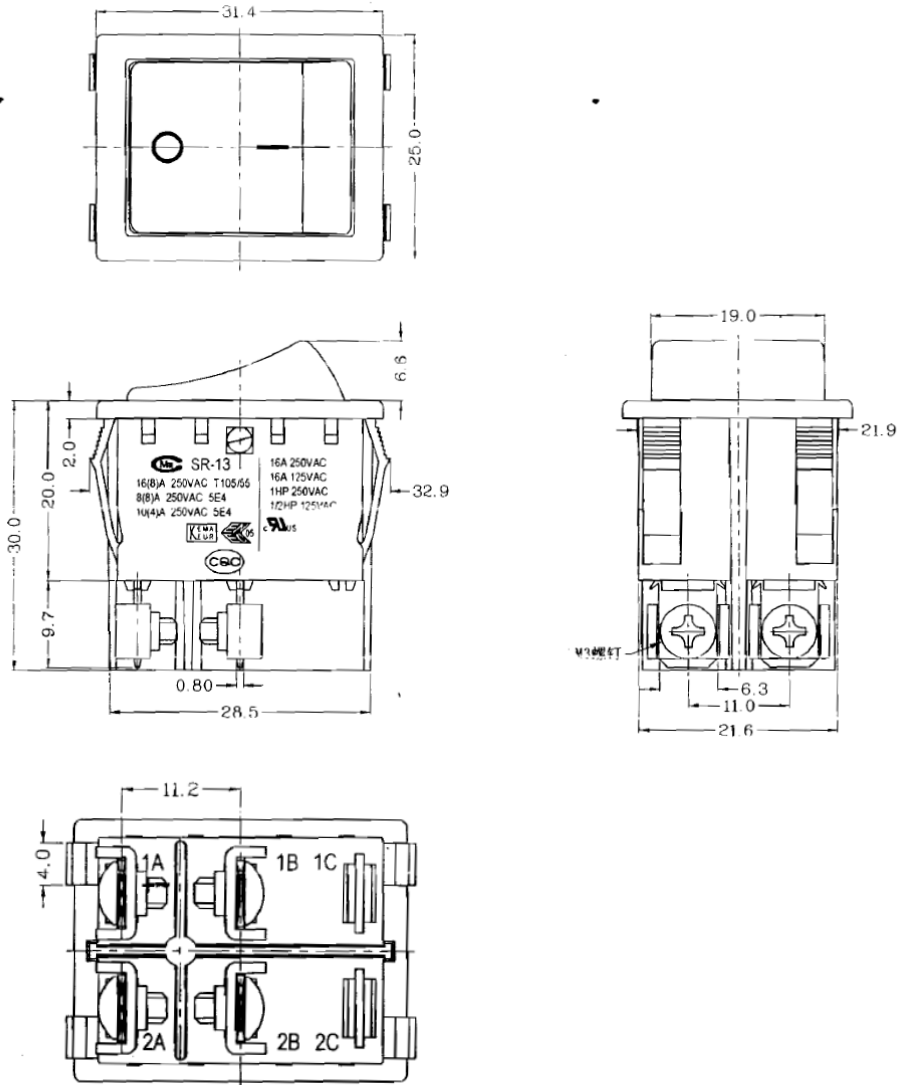

WIRING DIAGRAM

