

SERIES 1846 - SINGLE-POLE PUSHBUTTON SWITCHES

TO 2 (1) A 250 V AC



PRODUCT FEATURES

- ◆ Small, compact pushbutton switch
- ◆ Long life endurance with 500 000 mechanical switching cycles
- ◆ Special design for dust and water protection

ON REQUEST

- ◆ Other colors
- ◆ With printing
- ◆ Other terminal variants
- ◆ Cable assembly

Mechanical life endurance	50E4
Operating force	approx. 1 N ≤ 4.0 N (1846.0204)
Contact resistance (new condition)	< 100 mOhm (1 A 12 V DC)
Insulation resistance (new condition)	> 100 MOhm (500 V DC)
Proof tracking	250 PTI
Protection type	IP 40
Ambient temperature	terminal side -20 °C ... +85 °C actuating side -20 °C ... +55 °C
Flammability	UL 94 V-2
Glow wire test temperature	850 °C
Material	actuator PA housing PA terminals silver plated / tinned
Bearing terminal	silver plated tinned
Plug force of the terminals	≤ 80 N
Approval marks	
Suitable for appliances of protection class II	



ROCKER SWITCHES

PUSHBUTTON SWITCHES

TOGGLE SWITCHES

SLIDE SWITCHES

ROTARY SWITCHES

FOOT SWITCHES

FACT AND KEY SWITCHES













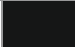

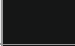

SNAP-ACTION SWITCHES

MICRO-SIGNAL SWITCHES

SENSORS

SERIES 1846 - SINGLE-POLE PUSHBUTTON SWITCHES

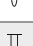
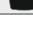
TO 2 (1) A 250 V AC

 single-pole	Actuator color / printing	Housing color	2 (1) A 250 V AC 5E4	30 mA 12 V DC 5E4	Terminal type	Terminal description	Contact distance in mm	Contact material	Miscellaneous	Stock version
Normally open contact (SPNO)										
1846.0201			●				< 3	Ag		●
1846.2201			●				< 3	Ag		
1846.3201			●			2.8 x 0.5	< 3	Ag		●
1846.3204			●			2.8 x 0.5	< 3	Ag		
1846.2251				●			< 3	Au	electrical life endurance: 500 000	
1846.0204							< 3	Ag	switch actuating force 4 N	



Basic type 1846

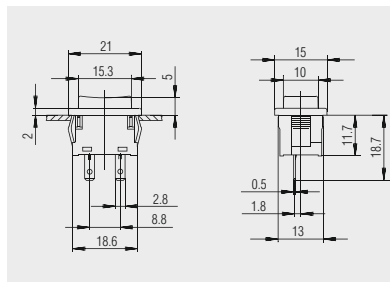

 Quick-connect terminal
2.8 x 0.5

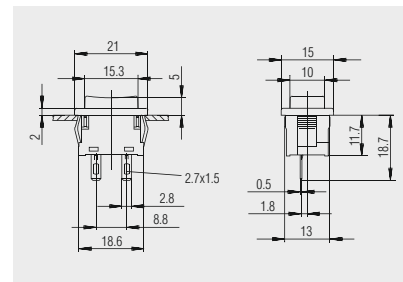

 Solder terminal

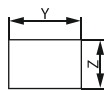

X = wall thickness

X	Y	Z
0.75 ... 1.25	19.2 ^{-0.1}	12.9 ^{+0.1}
1.25 ... 2	19.4 ^{-0.1}	12.9 ^{+0.1}
2 ... 3	19.8 ^{-0.1}	12.9 ^{+0.1}

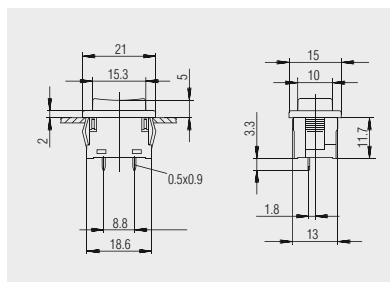

 PCB terminal



Protection cap
203.089.011

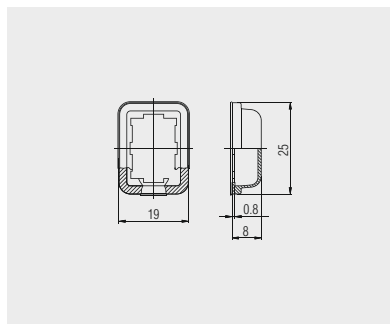

Transparent PVC - protection cap.
Serves as dust and water protection
of the actuation side.