

# SERIES 1683 - SINGLE AND DOUBLE-POLE PUSHBUTTON SWITCHES

TO 16 A 250 V AC

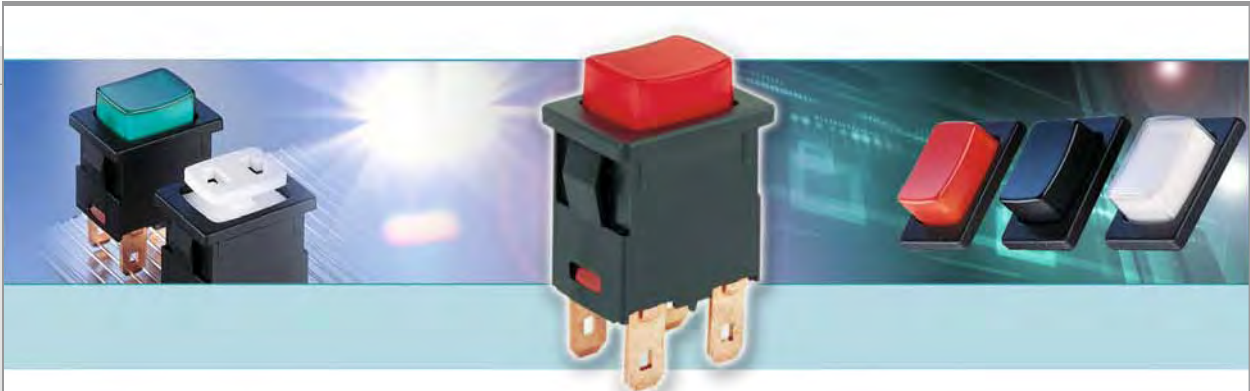



## PRODUCT FEATURES

- ◆ Million times proven, double lifting contact system
- ◆ High electrical rating up to 16 A
- ◆ High rating with 100 000 mechanical switching cycles
- ◆ Illuminated and non-illuminated variants
- ◆ Variant with dust and water protection IP 65/IP 67

## ON REQUEST



- ◆ Other colors
- ◆ Printing
- ◆ Other lamp variants
- ◆ Snap-on customized actuators
- ◆ Other terminal variants (e.g. 6.3 x 0.8 mm)
- ◆ Cable assembly

Mechanical life endurance	10E4
Operating force	ca. 12 N ca. 8 N (basic type 1683)
Contact resistance (new condition)	< 100 mOhm (1 A 12 V DC)
Insulation resistance (new condition)	> 100 MOhm (500 V DC)
Proof tracking	250 PTI
Protection type	IP 40 (IP 65/IP 67 product-dependent on request)
Ambient temperature	terminal side -20 °C ... +100 °C actuating side -20 °C ... +55 °C
Flammability	UL 94 (actuator: V-0, socket: V-1, housing: V-2)
Glow wire test temperature	850 °C
Material	actuator: PC housing: PA / PA glasfaserverstärkt terminals: silver plated / copper bare (product-dependent)
Plug force of the terminals	≤ 80 N
Approval marks	 /  / 
Suitable for appliances of protection class II	



# SERIES 1683 - SINGLE AND DOUBLE-POLE PUSHBUTTON SWITCHES

TO 16 A 250 V AC

 single-pole		Lighting voltage in V	Actuator color / printing	16 (4) A 250 V AC 1E4	12 (8) A 250 V AC 1E4	10 (8) A 250 V AC 5E4	12 A 125 - 250 V AC 1/2 HP	Terminal type	Terminal description	Contact distance in mm	Contact material	Free position (FP) max. in mm	Operating position (OP) in mm	Permissible total travel position (TP) in mm	Miscellaneous	Actuator description	Stock version
<b>ON / OFF switch (SPST)</b>																	
1686.1101	230		● ● ● ●	● ● ● ●	● ● ● ●	● ● ● ●	U	4.8	≈ 3	Ag	23.9	20.85	19.7				
1686.8104	230		● ● ● ●	● ● ● ●	● ● ● ●	● ● ● ●	U	4.8	≈ 3	Ag	23.9	20.85	19.7	IP 65/IP 67			
1683.1101			● ● ● ●	● ● ● ●	● ● ● ●	● ● ● ●	U	4.8	≈ 3	Ag	23.9	20.85	19.7				
1683.3101			● ● ● ●	● ● ● ●	● ● ● ●	● ● ● ●	U	4.8 horizontal	≈ 3	Ag	23.5	20.45	19.3				
1683.8101			● ● ● ●	● ● ● ●	● ● ● ●	● ● ● ●	U	4.8	≈ 3	Ag	23.9	20.85	19.7	IP 65/IP 67			
<b>Normally open contact (SPNO)</b>																	
1686.6155	24						U	4.8 / 2 x 2.8	≈ 3	Au	23.9	20.85	19.7	lamp terminal (2.8) external			
1683.1201			● ● ● ●	● ● ● ●	● ● ● ●	● ● ● ●	U	4.8	≈ 3	Ag	23.9	20.85	19.7				●
1683.1802			● ● ● ●	● ● ● ●	● ● ● ●	● ● ● ●	U	4.8	≈ 3	Ag	23.5	20.45	19.3				
1683.3601			● ● ● ●	● ● ● ●	● ● ● ●	● ● ● ●	U	4.8 horizontal	≈ 3	Ag	23.5	20.45	19.3	snap-on actuator			
 double-pole		Lighting voltage in V	Actuator color / printing	16 (4) A 250 V AC 1E4	12 (8) A 250 V AC 1E4	10 (8) A 250 V AC 5E4	12 A 125 - 250 V AC 1/2 HP	Terminal type	Terminal description	Contact distance in mm	Contact material	Free position (FP) max. in mm	Operating position (OP) in mm	Permissible total travel position (TP) in mm	Miscellaneous	Actuator description	Stock version
<b>ON / OFF switch (DPST)</b>																	
1687.1104	230		● ● ● ●	● ● ● ●	● ● ● ●	● ● ● ●	U	4.8	≈ 3	Ag	23.9	20.85	19.7				●
1684.1101			● ● ● ●	● ● ● ●	● ● ● ●	● ● ● ●	U	4.8	≈ 3	Ag	23.9	20.85	19.7				
1684.1104			● ● ● ●	● ● ● ●	● ● ● ●	● ● ● ●	U	4.8	≈ 3	Ag	23.9	20.85	19.7				
1684.1701			● ● ● ●	● ● ● ●	● ● ● ●	● ● ● ●	U	4.8	≈ 3	Ag	23.5	20.45	19.3	snap-on actuator			
1684.1801			● ● ● ●	● ● ● ●	● ● ● ●	● ● ● ●	U	4.8	≈ 3	Ag	23.5	20.45	19.3				
1684.2701			● ● ● ●	● ● ● ●	● ● ● ●	● ● ● ●	U	vertical	≈ 3	Ag	23.5	20.45	19.3	snap-on actuator			
<b>Normally open contact (DPNO)</b>																	
1684.1201			● ● ● ●	● ● ● ●	● ● ● ●	● ● ● ●	U	4.8	≈ 3	Ag	23.9	20.85	19.7				

ROCKER SWITCHES

PUSHBUTTON SWITCHES

TOGGLE SWITCHES

SLIDE SWITCHES

ROTARY SWITCHES

FOOT SWITCHES

FACT AND KEY SWITCHES

SNAP-ACTION SWITCHES

MICRO-SIGNAL SWITCHES

SENSORS

# SERIES 1683 - SINGLE AND DOUBLE-POLE PUSHBUTTON SWITCHES

TO 16 A 250 V AC

ROCKER SWITCHES

PUSHBUTTON SWITCHES

TOGGLE SWITCHES

SLIDE SWITCHES

ROTARY SWITCHES

FOOT SWITCHES

FACT AND KEY SWITCHES

SNAP-ACTION SWITCHES

MICRO-SIGNAL SWITCHES

SENSORS



Basic type 1683  
single-pole  
non-illuminated

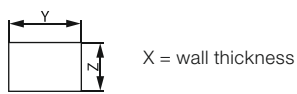

X	Y	Z
0.75 ... 1.25	19.2 <sup>-0.1</sup>	12.9 <sup>+0.1</sup>
1.25 ... 2	19.4 <sup>-0.1</sup>	12.9 <sup>+0.1</sup>
2 ... 3	19.8 <sup>-0.1</sup>	12.9 <sup>+0.1</sup>

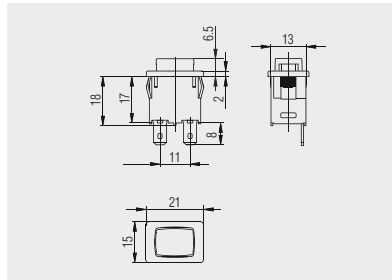

Quick-connect terminal 4.8 x 0.8

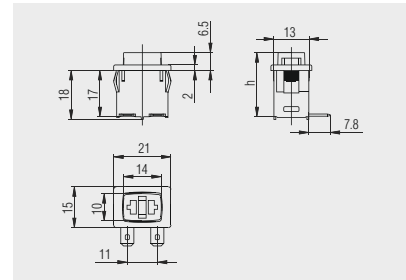

Quick-connect terminal 4.8 x 0.8  
horizontal

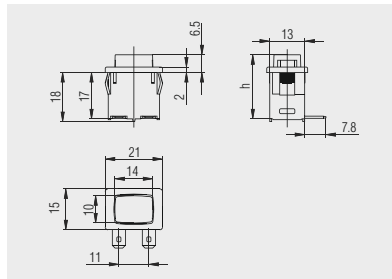

Quick-connect terminal 4.8 x 0.8  
horizontal



Basic types 1683, 1684, 1686  
and 1687  
single and double-pole  
illuminated / non-illuminated

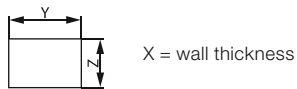

X	Y	Z
0.75 ... 1.25	19.2 <sup>-0.1</sup>	12.9 <sup>+0.1</sup>
1.25 ... 2	19.4 <sup>-0.1</sup>	12.9 <sup>+0.1</sup>
2 ... 3	19.8 <sup>-0.1</sup>	12.9 <sup>+0.1</sup>

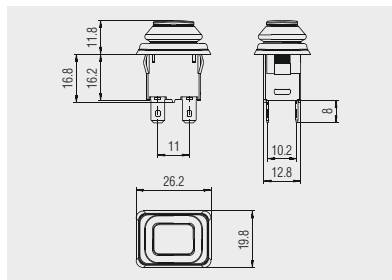

Quick-connect terminal 4.8 x 0.8  
1686.8101 and 1683.8104  
with bellows for IP 65/IP 67

# SERIES 1683 - SINGLE AND DOUBLE-POLE PUSHBUTTON SWITCHES

TO 16 A 250 V AC



Basic types 1684, 1686 and 1687  
single and double-pole  
illuminated / non-illuminated

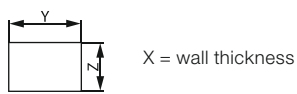

X	Y	Z
0.75 ... 1.25	19.2 <sup>-0.1</sup>	12.9 <sup>+0.1</sup>
1.25 ... 2	19.4 <sup>-0.1</sup>	12.9 <sup>+0.1</sup>
2 ... 3	19.8 <sup>-0.1</sup>	12.9 <sup>+0.1</sup>

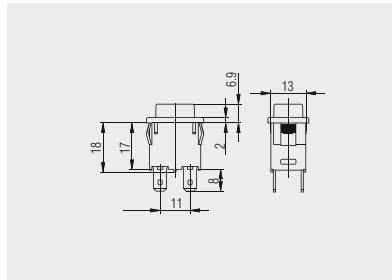

Quick-connect terminal 4.8 x 0.8  
1684.1101, 1684.1104, 1684.1201,  
basic types 1687 and 1686

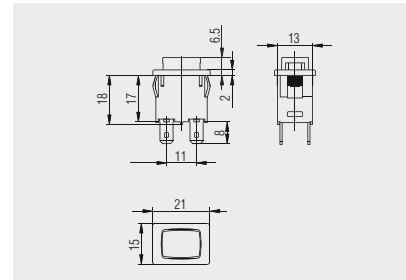

Quick-connect terminal 4.8 x 0.8  
basic type 1684

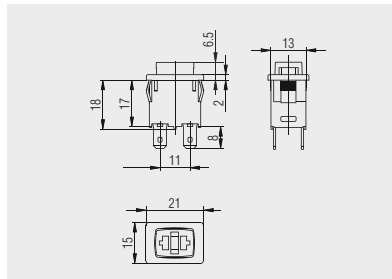

Quick-connect terminal 4.8 x 0.8  
basic type 1684

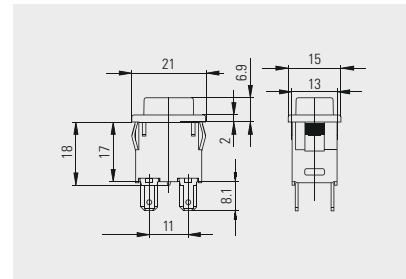

Quick-connect terminal 4.8 x 0.8 /  
2 x 2.8 x 0.8 with external lamp  
terminal  
1686.6155

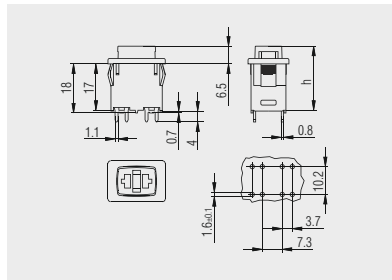

PCB terminal vertical  
1684.2701



Protection cap  
203.701.011

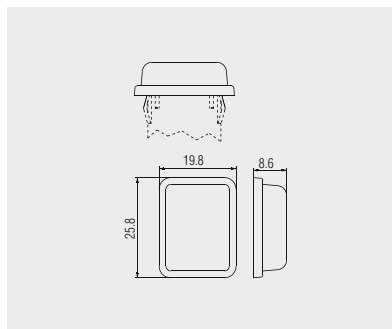

Transparent PVC - protection cap for  
dust and water protection from the  
actuation side

ROCKER SWITCHES

PUSHBUTTON SWITCHES

TOGGLE SWITCHES

SLIDE SWITCHES

ROTARY SWITCHES

FOOT SWITCHES

FACT AND KEY SWITCHES

SNAP-ACTION SWITCHES

MICRO-SIGNAL SWITCHES

SENSORS