

INFOBOX: Gegenstützen

2- und 3 schalige Innenauszieher, Baureihe 21

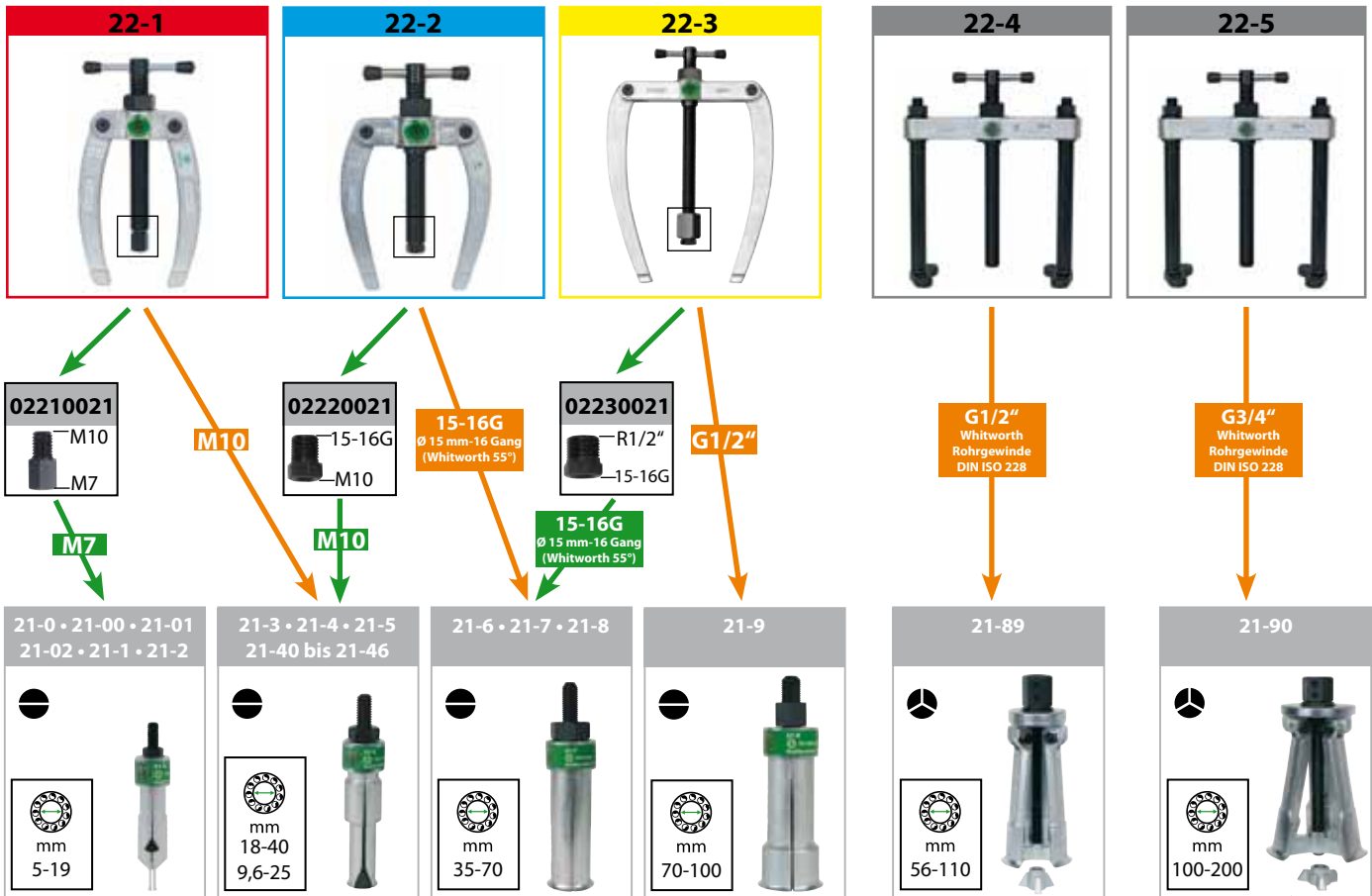

Innenauszieher mit segmentierten Greifflächen, Baureihe 21-x-E

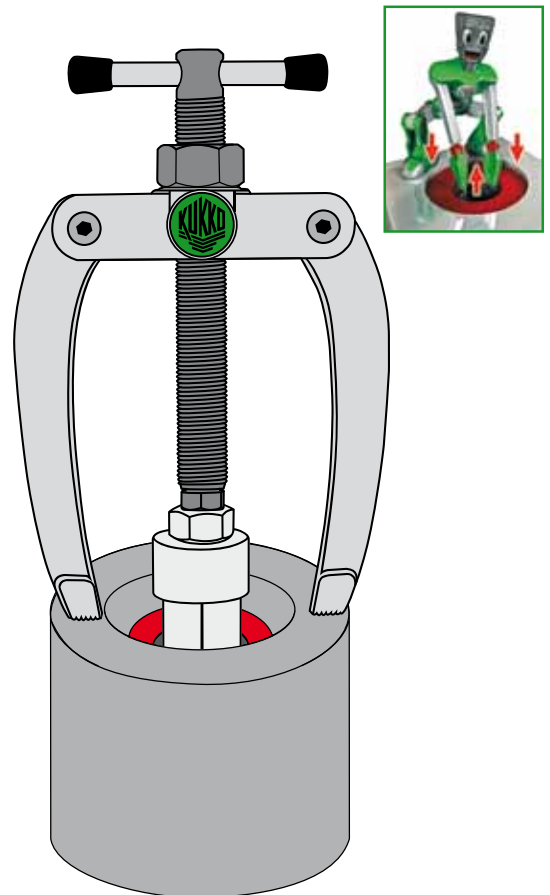
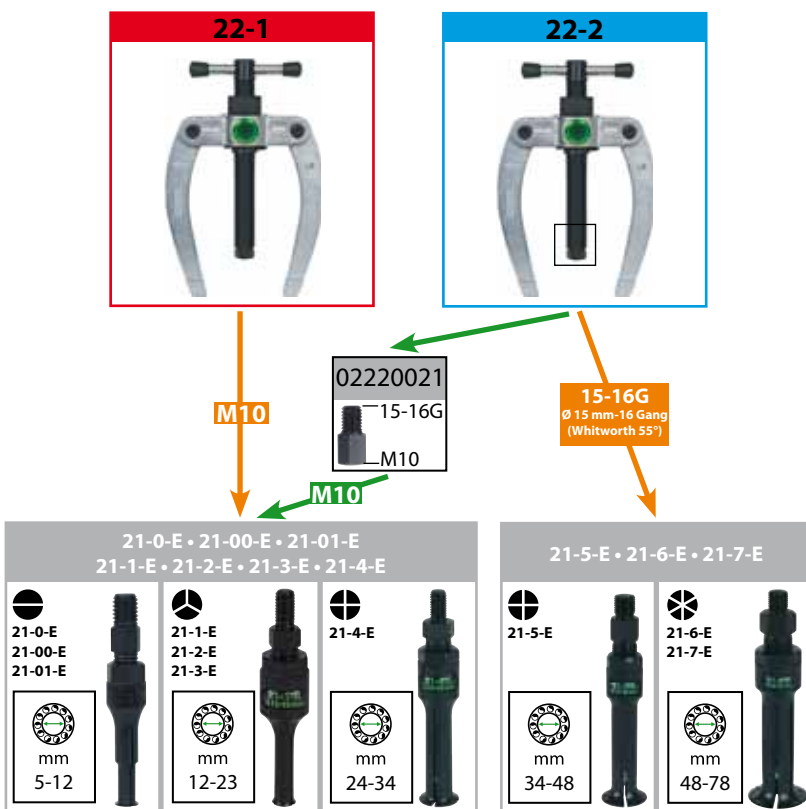

3 Gleithämmer für alle Anwendungen mit Innenausziehern

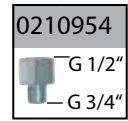
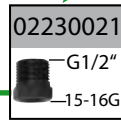
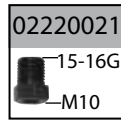
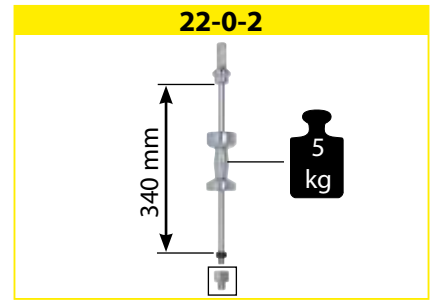
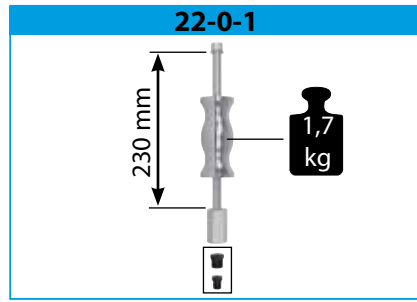
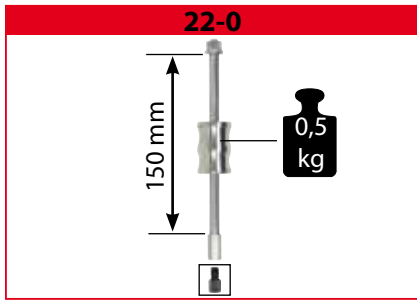

M10

G1/2"

G1/2"
Whitworth
Rohrgewinde
DIN ISO 228

G3/4"
Whitworth
Rohrgewinde
DIN ISO 228

M7

M10

15-16G
Ø 15 mm-16 Gang
(Whitworth 55°)

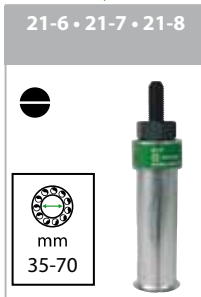
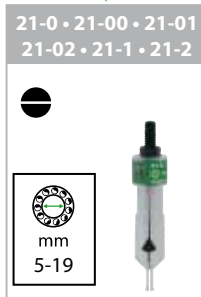

Innenauszieher mit segmentierten Greifflächen, Baureihe 21-x-E

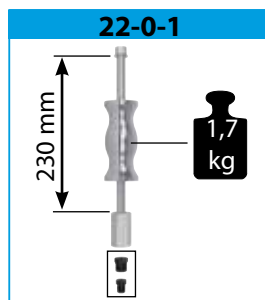
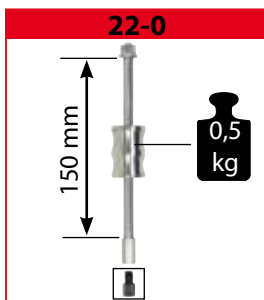

M10

M10



15-16G
Ø 15 mm-16 Gang
(Whitworth 55°)

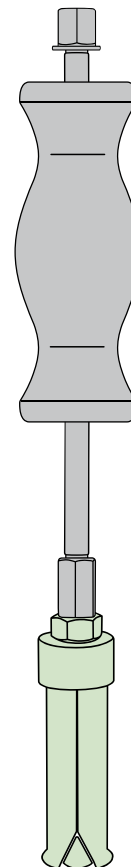

TIPP: 22-0-2

