

# Control cabinet feed-through - CUC-BH-M12D1PBK-S/R4BE - 1414398

Please be informed that the data shown in this PDF Document is generated from our Online Catalog. Please find the complete data in the user's documentation. Our General Terms of Use for Downloads are valid (<http://phoenixcontact.com/download>)



Control cabinet feed-through, M12, 8-pos., D-coded to RJ45 socket, socket entry: 180°, IP65/IP67

## Why buy this product

- 1 Gbps
- IP65/67
- 



Ethernet

## Key commercial data

Packing unit	1
GTIN	 4 055626 166759
Custom tariff number	85366990

## Technical data

Product type	Data plug
Approval	EAC
Pin connector pattern	Straight
Direction of the cable outlet	straight
Signal type	Ethernet Ethernet

## Approvals

### Approvals

Approvals

EAC

Ex Approvals

# Control cabinet feed-through - CUC-BH-M12D1PBK-S/R4BE - 1414398

## Approvals

Approvals submitted

Approval details

EAC

## Drawings

Explosion drawing

Dimensional drawing

Exploded drawing

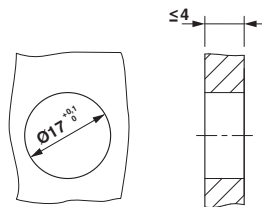

Panel cutout

Dimensional drawing

Circuit diagram

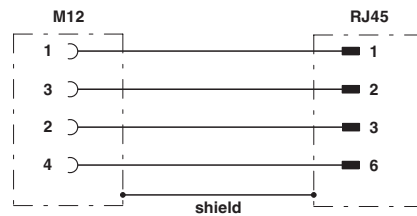
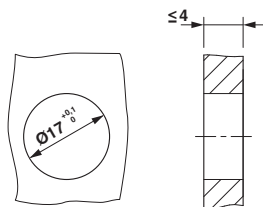

Panel cutout

Circuit diagram