

Control cabinet feed-through - CUC-BH-M12D1PBK-A/R4BE - 1414397

Please be informed that the data shown in this PDF Document is generated from our Online Catalog. Please find the complete data in the user's documentation. Our General Terms of Use for Downloads are valid (<http://phoenixcontact.com/download>)



Control cabinet feed-through, M12, 8-pos., D-coded to RJ45 socket, socket entry: 90°, IP65/IP67

Why buy this product

- 1 Gbps
- IP65/67
-



Key commercial data

Packing unit	1
GTIN	 4 055626 166742
Custom tariff number	85366990

Technical data

Product type	Data plug
Approval	EAC
Pin connector pattern	Angled
Direction of the cable outlet	angled
Signal type	Ethernet Ethernet CAT5 (IEC 11801:2002)

Approvals

Approvals

Approvals

EAC

Ex Approvals

Control cabinet feed-through - CUC-BH-M12D1PBK-A/R4BE - 1414397

Approvals

Approvals submitted

Approval details

EAC

Drawings

Explosion drawing

Dimensional drawing

Exploded drawing

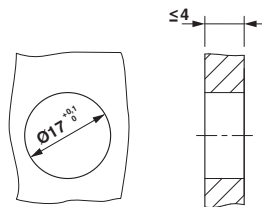

Panel cutout

Dimensional drawing

Circuit diagram

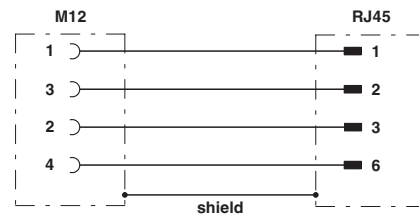
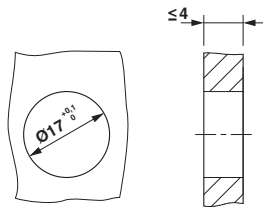

Panel cutout