

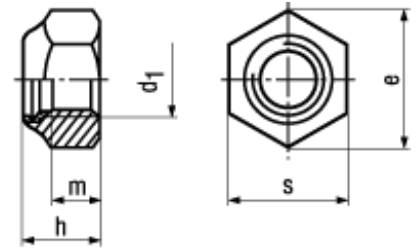

DIN 985

Standard withdrawn

6



## BN 161

## Prevailing torque type hex lock nuts

thin type, with polyamide insert

Steel 6

zinc plated blue

- ~UNI 7474

M2; M2,5; M3,5: not included in DIN 985, M10; M12; M14; M22: wrench size according to ISO on request

| Article# | d <sub>1</sub> | e min. | h max. | m    | s   |
|----------|----------------|--------|--------|------|-----|
| 1952935  | M2             | 4,32   | 2,8    | 1    | 4   |
| 1094882  | M2,5           | 5,45   | 3,7    | 2    | 5   |
| 1094904  | M3             | 6,01   | 4      | 2,4  | 5,5 |
| 1094912  | M3,5           | 6,58   | 4,5    | 2,6  | 6   |
| 1094920  | M4             | 7,66   | 5      | 2,9  | 7   |
| 1094939  | M5             | 8,79   | 5      | 3,2  | 8   |
| 1444921  | M6             | 11,05  | 6      | 4    | 10  |
| 2049058  | M7             | 12,12  | 7,5    | 4,7  | 11  |
| 1055550  | M8             | 14,38  | 8      | 5,5  | 13  |
| 1055569  | M10            | 18,9   | 10     | 6,5  | 17  |
| 1055577  | M12            | 21,1   | 12     | 8    | 19  |
| 1055585  | M14            | 24,49  | 14     | 9,5  | 22  |
| 1055593  | M16            | 26,75  | 16     | 10,5 | 24  |
| 1118730  | M18            | 29,56  | 18,5   | 13   | 27  |
| 1118811  | M20            | 32,95  | 20     | 14   | 30  |
| 1118862  | M22            | 35,03  | 22     | 15   | 32  |
| 1118900  | M24            | 39,55  | 24     | 15   | 36  |