

2002-05-03

ELFA

PRODUKTINFORMATION

Vi reserverar oss mot fel samt förbehåller oss rätten till ändringar utan föregående meddelande

ELFA artikelnr

69-420-07 Laddare NiCd 8314KL

8314

Max. 100 mA

CHARGERS FOR NIMH/NICD BATTERIES

- Konstantstrømlader for NiMH/NiCd-batterier
- For 50 mAh-1 Ah batterier
- Lineær
- Termosikring i transformator, polvendings- og kortslutningssikker
- Plugg-inn enhet
- Lysdiode indikerer lading
- Constant current charger for NiMH/NiCd batteries
- For 50 mAh-1 Ah batteries
- Linear
- Thermal fuse in transformer, protected against reversed polarity and short circuit proof
- Plug-in unit
- LED indicates charging

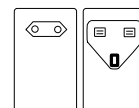

Tekniske data	Technical specifications	
Inngangsspenning:	<i>Input voltage:</i>	230 VAC +6/-10%, 50/60Hz
Ladespenning (1-12 celler samtidig):	<i>Charging voltage (1-12 cells simultaneously):</i>	Max. 30 V
Ladestrøm - konstant:	<i>Charge current - constant:</i>	60 mA
Temperaturområde:	<i>Temperature range:</i>	-10°C - +40°C
Strømbegrensning:	<i>Current limiting:</i>	Ja / Yes
Isolasjonsklasse:	<i>Insulation class:</i>	II
Elektrisk sikkerhetsstandard:	<i>Electrical safety standard:</i>	EN 60065, EN 60950
EMC standarder	<i>EMC standards</i>	
• Emisjon:	• <i>Emission:</i>	EN 50081-1
• Immunitet:	• <i>Immunity:</i>	EN 50082-1
Utgangsterminaler	<i>Output terminals</i>	
• Sek. ledning med/uten plugg:	• <i>Cord with/without plug:</i>	Tilbehør / Accessories
Mål uten plugg (LxBxH):	<i>Dimensions without plug (LxWxH):</i>	75 x 47 x 49 mm
Vekt:	<i>Weight:</i>	220 g

Versjoner <i>Versions</i>	14 t lading - batterikapasitet <i>14 h charging - battery capacity</i>
5 mA	50 mAh
10 mA	100 mAh
15 mA	150 mAh
25 mA	250 mAh
30 mA	300 mAh
35 mA	350 mAh
45 mA	450 mAh
50 mA	500 mAh
60 mA	600 mAh
80 mA	800 mAh
90 mA	900 mAh
100 mA	1 Ah