

No.MP-121WK
MINIATURE DC PLUG (3.4×1.3)
Net Weight: 1.5 gr

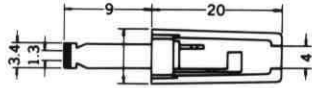

No.MP-121WH
MINIATURE DC PLUG (3.4×1.3)
w/cable protector
Net Weight: 1.5 gr

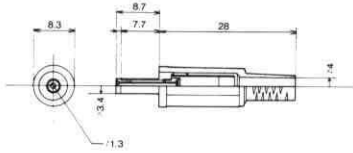

No.MP-121PS
MINIATURE DC PLUG (3.0×1.1)
w/cable protector
Net Weight: 1.5 gr

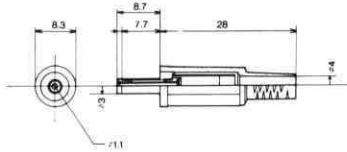

No.MP-121M (5.5×2.1)
No.MP-122M (5.5×2.5)
MOLDED DC PLUG.
Net Weight: 1.9 gr

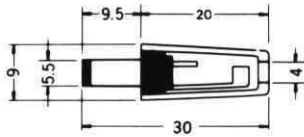

No.MP-136 (5.5×2.1)
No.MP-137 (5.5×2.5)
LONG TYPE DC PLUG.
Net Weight: 3 gr

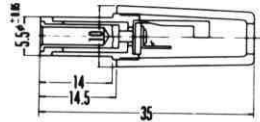

No.MP-136H (5.5×2.1)
No.MP-137H (5.5×2.5)
LONG TYPE DC PLUG.
Net Weight: 3 gr

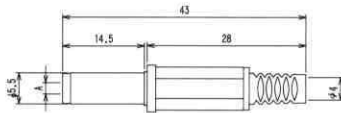

No.MP-112L (2.1)
Net Weight: 3 gr
No.MP-113L (2.5)
DC PLUG.
Net Weight: 3 gr

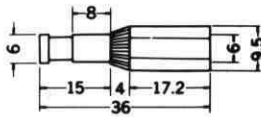

No.MP-065L
DC PLUG w/cable protector
JVC TYPE
Net Weight: 4 gr

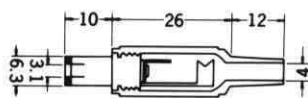

No.MP-121C (5.5×2.1)
No.MP-122C (5.5×2.5)
DC PLUG w/cable protector

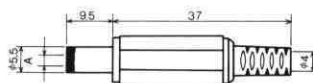

No.MP-136L (5.5×2.1)
No.MP-137L (5.5×2.5)
RIGHT ANGLE DC PLUG

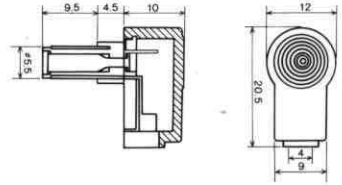

No.MP-121WL
RIGHT ANGLE DC PLUG
(3.4×1.3)

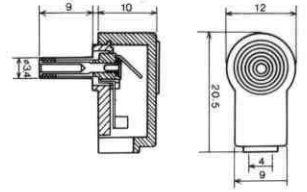

No.MP-121PL
RIGHT ANGLE DC PLUG
(3×1.1)

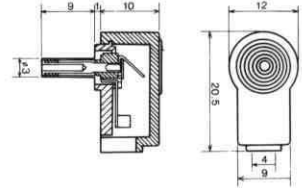

No.MP-135NK
DC PLUG(3.5×1.1) FOR BATTERY CHARGER
FOR CELLULAR PHONE

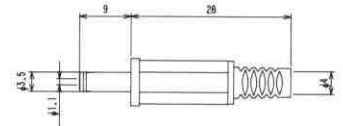

No.MP-138NK
DC PLUG(3.8×1.4) FOR BATTERY CHARGER
FOR CELLULAR PHONE

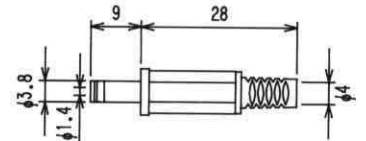

No.MP-139SF
DC PLUG(7.5×4.1 Center Pin : 1 φ mm)
FOR COMPUTER GAME

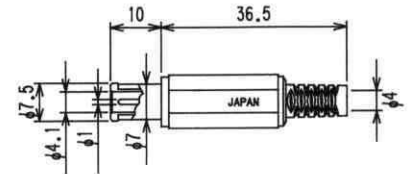

No.MP-F27
DC PLUG(3.4×1.3mm) FOR MOLDING

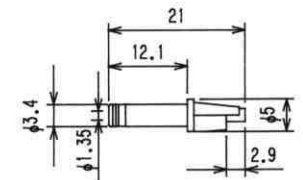

No.MP-F67
DC PLUG(3.8×1.4mm) FOR MOLDING

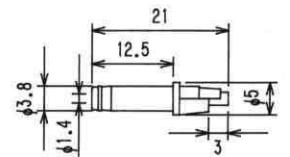

No.MP-F68
DC PLUG(3.4×1.4mm) FOR MOLDING

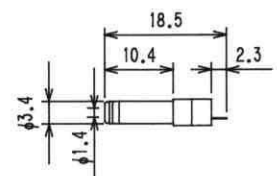

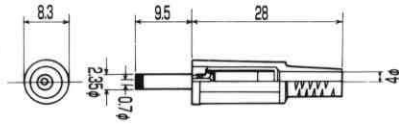
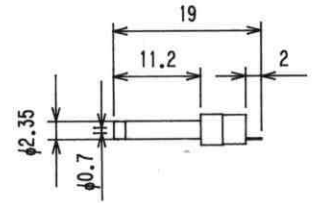
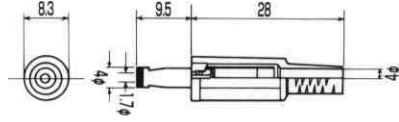
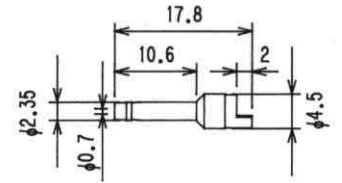
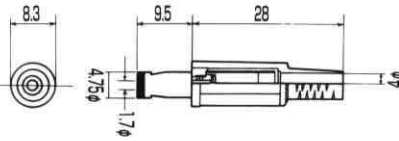
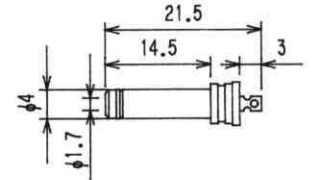
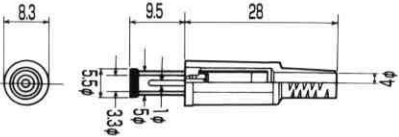
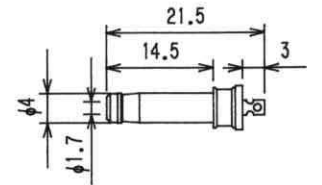
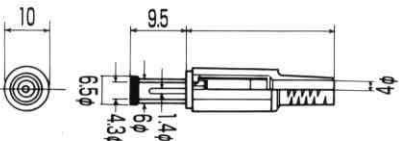
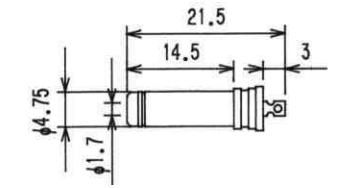
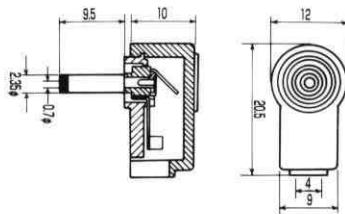
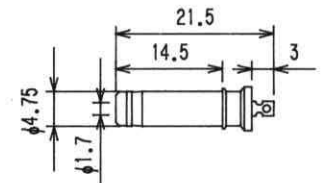
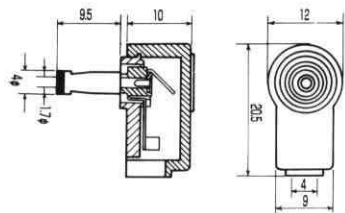
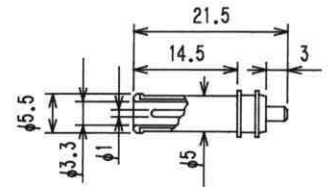
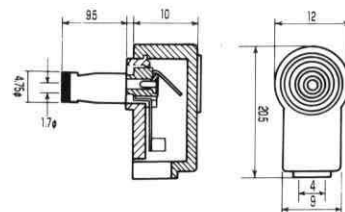
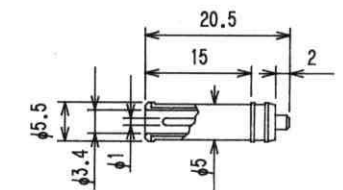
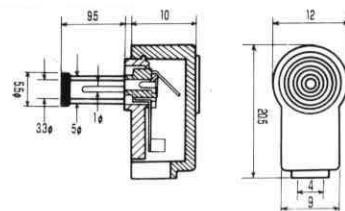
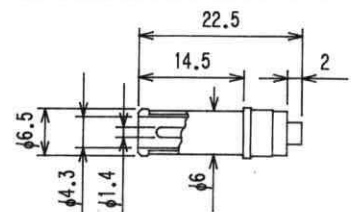
No.MP-201DC PLUG(0.7 φ × 2.35 φ mm)
JSAP 1 (DC 3.15V Max)**No.MP-F97**DC PLUG(0.7 φ × 2.35 φ mm)
JSAP 1 FOR MOLDING**No.MP-202**DC PLUG(1.7 φ × 4 φ mm)
JSAP 2 (DC 3.15V~6.3V)**No.MP-F97-2**DC PLUG(0.7 φ × 2.35 φ mm)
JSAP 1 FOR MOLDING**No.MP-203**DC PLUG(1.7 φ × 4.75 φ mm)
JSAP 3 (DC 6.3V~10.5V)**No.MP-F90-2**DC PLUG(1.7 φ × 4 φ mm)
JSAP 2 FOR MOLDING**No.MP-204**DC PLUG(3.3 φ × 5.5 φ mm Center pin: 1 φ mm)
JSBP 4 (DC 10.5V~13.5V)**No.MP-F90-3**DC PLUG(1.7 φ × 4 φ mm)
JSAP 2 FOR MOLDING**No.MP-205**DC PLUG(4.3 φ × 6.5 φ mm Center pin: 1.4 φ mm)
JSBP 5 (DC 13.5V~18V)**No.MP-F92-1**DC PLUG(1.7 φ × 4.75 φ mm)
JSAP 3 FOR MOLDING**No.MP-201L**DC RIGHT ANGLE PLUG (0.7 φ × 2.35 φ mm)
JSAP 1 (DC 3.15V Max)**No.MP-F92-2**DC PLUG(1.7 φ × 4.75 φ mm)
JSAP 3 FOR MOLDING**No.MP-202L**DC RIGHT ANGLE PLUG (1.7 φ × 4 φ mm)
JSAP 2 (DC 3.15V~6.3V)**No.MP-F101-1**DC PLUG(3.3 φ × 5.5 φ mm Center pin: 1 φ mm)
JSBP 4 FOR MOLDING**No.MP-203L**DC RIGHT ANGLE PLUG (1.7 φ × 4.75 φ mm)
JSAP 3 (DC 6.3V~10.5V)**No.MP-F101-2**DC PLUG(3.3 φ × 5.5 φ mm Center pin: 1 φ mm)
JSBP 4 FOR MOLDING**No.MP-204L**DC RIGHT ANGLE PLUG
(3.3 φ × 5.5 φ mm center pin: 1 φ mm)
JSBP 4 (DC 10.5V~13.5V)**No.MP-F114**DC PLUG(4.3 φ × 6.5 φ mm Center pin: 1.4 φ mm)
JSBP 5 FOR MOLDING

DC ADAPTOR CABLE W/STRAIGHT PLUG

L=1800mm



Available Product Line

MODEL No.	PLUG TYPE (mm)	RATING
MC-2374	$\phi 5.5 \times \phi 2.1$	12.0V DC 0.5A
MC-2375	$\phi 5.5 \times \phi 2.5$	12.0V DC 0.5A
MC-5321	$\phi 2.35 \times \phi 0.7$ JSAP1	3.15V DC 2A
MC-5322	$\phi 4.0 \times \phi 1.7$ JSAP2	6.3V DC 2A
MC-5323	$\phi 4.75 \times \phi 1.7$ JSAP3	10.5V DC 2A
MC-5324	$\phi 5.5 \times \phi 3.3$ JSBP4	13.5V DC 2A
MC-5325	$\phi 6.5 \times \phi 4.3$ JSBP5	18.0V DC 2A

DC ADAPTOR CABLE W/RIGHT ANGLE PLUG

L=1800mm



Available Product Line

MODEL No.	PLUG TYPE (mm)	RATING
MC-2374L	$\phi 5.5 \times \phi 2.1$	12.0V DC 0.5A
MC-2375L	$\phi 5.5 \times \phi 2.5$	12.0V DC 0.5A
MC-5321L	$\phi 2.35 \times \phi 0.7$ JSAP1	3.15V DC 2A
MC-5322L	$\phi 4.0 \times \phi 1.7$ JSAP2	6.3V DC 2A
MC-5323L	$\phi 4.75 \times \phi 1.7$ JSAP3	10.5V DC 2A
MC-5324L	$\phi 5.5 \times \phi 3.3$ JSBP4	13.5V DC 2A
MC-5325L	$\phi 6.5 \times \phi 4.3$ JSBP5	18.0V DC 2A