

## SPECIFICATIONS:

CONTACT RATING: Refer to "Contact Material Options" for more info.  
 ELECTRICAL LIFE: 50,000 make-and-break cycles at full load.  
 CONTACT RESISTANCE: 10mΩ max. initial @2-4VDC  
 100mA for both silver and gold plated contacts.  
 INSULATION RESISTANCE: 1,000M Ω Min.  
 DIELECTRIC STRENGTH: 1,500 V RMS @sea level.  
 OPERATING TEMPERATURE: -30°C ~ 85°C.

## MATERIALS:

CASE & BUSHING: Nylon 9T, flame retardant, heat stabilized (UL94V-0).  
 ACTUATOR: Brass chrome plated, internal o-ring sealed (100A).  
 ACTUATOR: Brass chrome plated (100C).  
 SWITCH SUPPORT: Brass, tin plated.  
 TERMINAL SEAL: Epoxy.

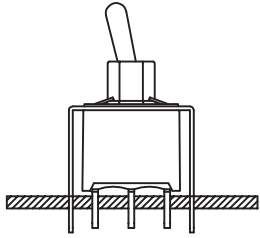
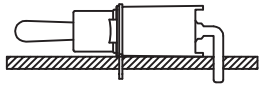

If your preferred product configuration is not shown, please contact our sales representative for custom design.

## HOW TO ORDER SYSTEM

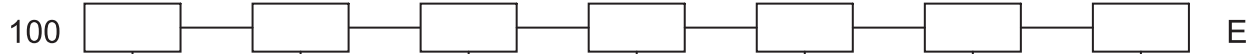

### Series

- A Sealed, red case
- C Miniature Toggle, gray case

### Switch Function

- WSP-1 On-None-On
- WSP-2 On-None-(On)
- WSP-3 On-Off-On
- WSP-4 (On)-Off-(On)
- WSP-5 On-Off-(On)
- WDP-1 On-None-On
- WDP-2 On-None-(On)
- WDP-3 On-Off-On
- WDP-4 (On)-Off-(On)
- WDP-5 On-Off-(On)
- WDP-6 On-On-On
- WDP-7 (On)-On-(On)
- WDP-8 On-On-(On)
- WDP-9 Off-On-(On)
- W3P-1 On-None-On
- W3P-2 On-None-(On)
- W3P-3 On-Off-On
- W3P-4 (On)-Off-(On)
- W3P-5 On-Off-(On)

### Actuator

- T1 12.60 (.496") high
- T2 7.60 (.299") high
- T9 Plastic, 19.40 (.764") high

### Cap Color

\* For T9 only

- 1 White
- 2 Black
- 3 Red
- 4 Orange
- 5 Yellow
- 6 Green
- 7 Blue
- 8 Brown
- 9 Gray

### Bushing

- B1 8.90 (.350") high, threaded
- B4 6.35 (.250") high, unthreaded

### Termination

- M1 Solder lug
- M2 PC thru-hole
- M3 Quick connect
- M5-1 Wire wrap, 19.05 (.750") long
- M5-2 Wire wrap, 24.48 (.964") long
- M5-3 Wire wrap, 10.80 (.425") long
- M5-4 Wire wrap, 26.97 (1.062") long
- M6 Right angle, PC thru-hole
- M61 Right angle, snap-in
- M7 Vertical, right angle PC thru-hole
- M71 Vertical, right angle snap-in
- VS2 Vertical mount, 11.70 (.461") high
- VS21 Vertical mount, snap-in 11.70 (.461") high
- U2 Vertical mount, 14.00 (.551") high
- VS3 Vertical mount, 16.00 (.630") high
- VS31 Vertical mount, snap-in 6.00 (.630") high
- VS4 Vertical mount, 11.70 (.461") high
- VS41 Vertical mount, snap-in 11.70 (.461") high
- U4 Vertical mount, 14.00 (.551") high
- VS5 Vertical mount, 16.00 (.630") high
- VS51 Vertical mount, snap-in 16.00 (.630") high

### Contact Material

- Q Silver
- P Silver (tin plated term.)
- R Gold
- K Gold (tin plated term.)
- G Silver (gold over silver term.)

### Note:

100A must be epoxy sealed.  
 Q plating not available with 100A.

# Series 100A/C

# (Sealed) Miniature Toggle Switches

## SPDT



Model No.	Switching Position		
WSP-1	ON	NONE	ON
WSP-2	ON	NONE	(ON)
WSP-3	ON	OFF	ON
WSP-4	(ON)	OFF	(ON)
WSP-5	ON	OFF	(ON)
Term. Comm.	2-3	OPEN	2-1

Schematic

O2Comm.

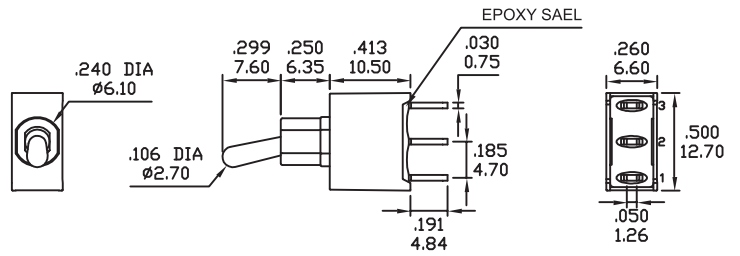

## DPDT



Model No.	Switching Position		
WDP-1	ON	NONE	ON
WDP-2	ON	NONE	(ON)
WDP-3	ON	OFF	ON
WDP-4	(ON)	OFF	(ON)
WDP-5	ON	OFF	(ON)
Term. Comm.	2-3,5-6	OPEN	2-1,5-4

Schematic

O2Comm. O5Comm.

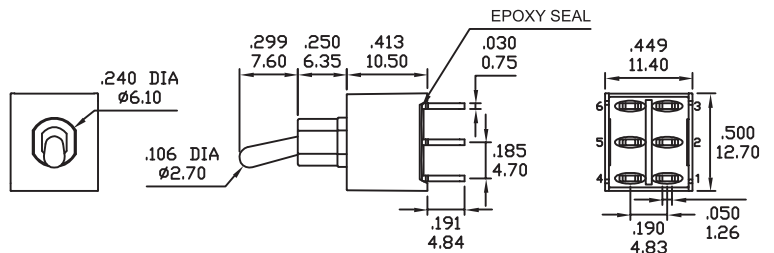

### WIRING FOR ON-ON-ON (3-WAY) FUNCTION

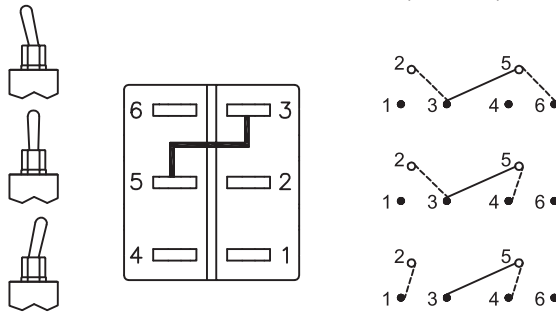

## 3PDT



Model No.	Switching Position		
W3P-1	ON	NONE	ON
W3P-2	ON	NONE	(ON)
W3P-3	ON	OFF	ON
W3P-4	(ON)	OFF	(ON)
W3P-5	ON	OFF	(ON)
Term. Comm.	2-3,5-6 8-9	OPEN	2-1,5-4 8-7

Schematic

O2Comm. O5Comm. O8Comm.

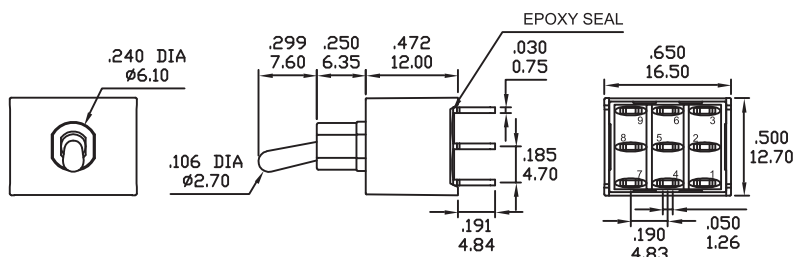
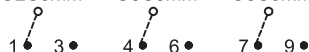

ACTUATOR OPTIONS

T1

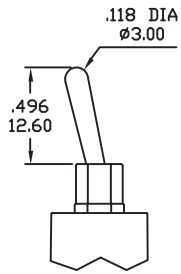

\* Subtract 2.00 from actuator height for B1 bushing

T2

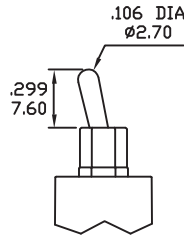

\* Subtract 2.10 from actuator height for B1 bushing

T9 PLASTIC

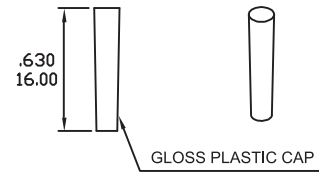
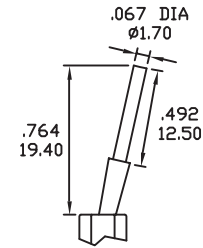

NO.	COLOR
1	White
2	Black(std.)
3	Red
4	Orange
5	Yellow
6	Green
7	Blue
8	Brown
9	Gray

BUSHING OPTIONS

B1

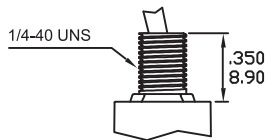

B4

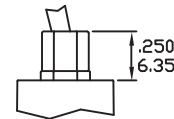

TERMINATION OPTIONS

M1 STD. SOLDER LUG

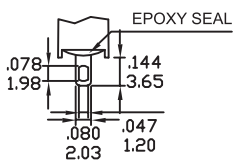

THK .030 (0.75)

M2 PC THRU-HOLE

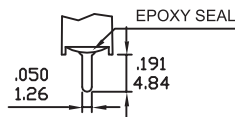

THK .030 (0.75)

M3 QUICK CONNECT

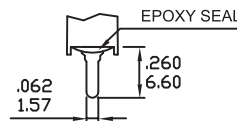

THK .030 (0.75)

M5 WIRE WRAP

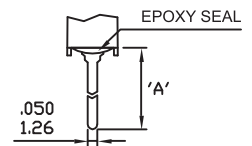

THK .030 (0.75)

OPTION CODE	DIM.'A'
M5-1	.750(19.05)
M5-2	.964(24.48)
M5-3	.425(10.80)
M5-4	1.062(26.97)

## TERMINATION OPTIONS

M6

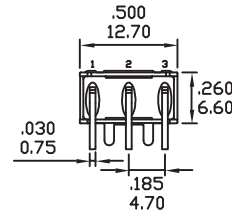
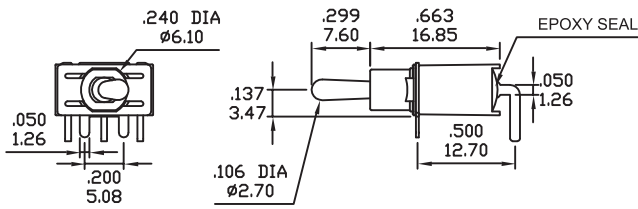

P.C.MOUNTING

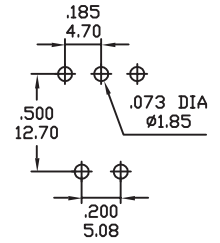

SPDT

M6

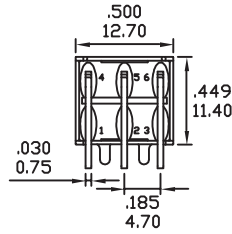
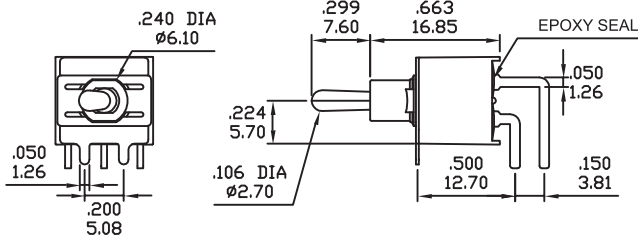

P.C.MOUNTING

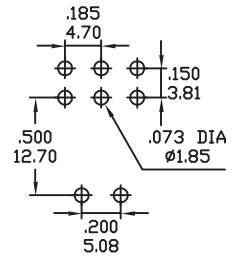

DPDT

M6

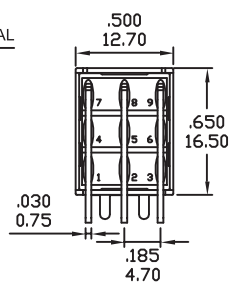
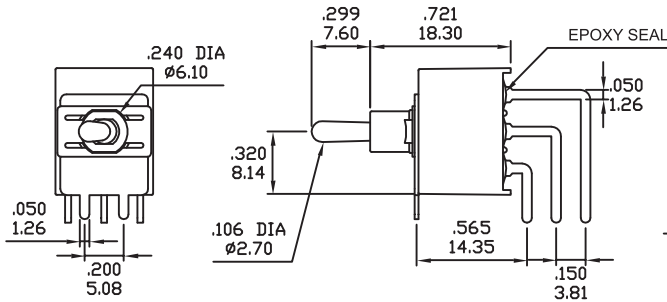
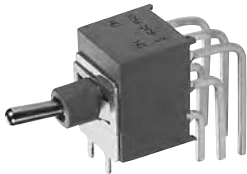

P.C.MOUNTING

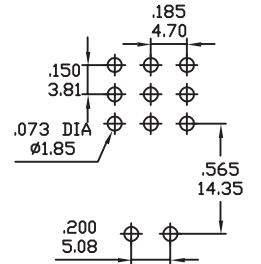

3PDT

M7

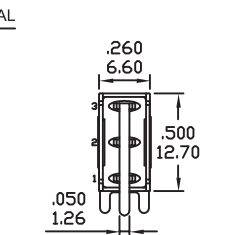
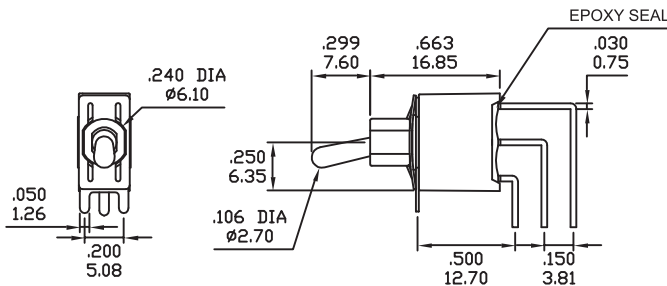

P.C.MOUNTING

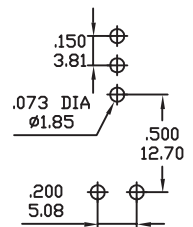

SPDT

M7

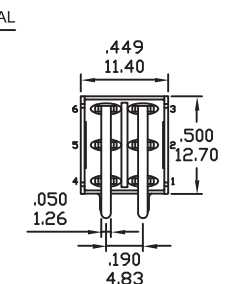
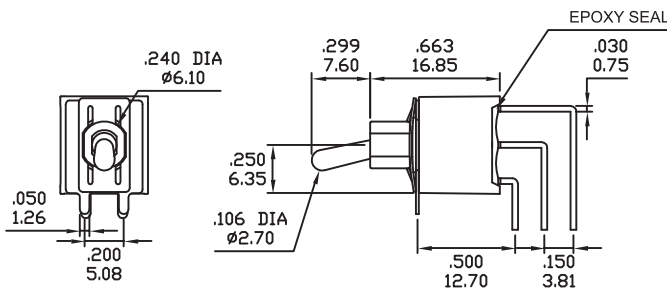

P.C.MOUNTING

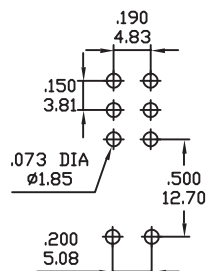

DPDT

## TERMINATION OPTIONS

M7



3PDT

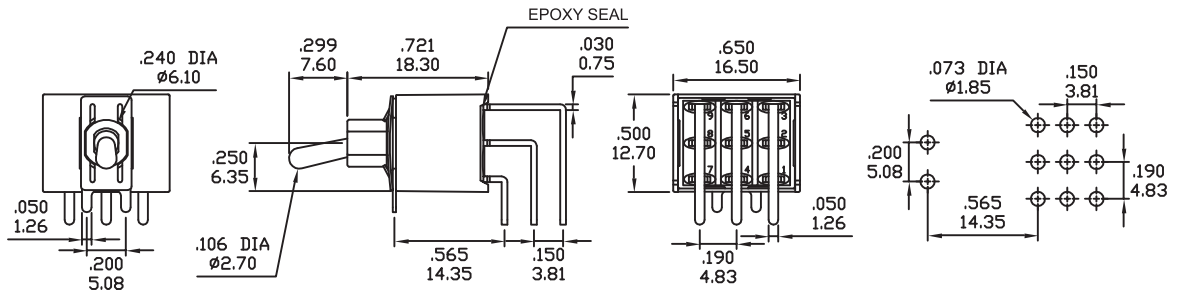

P.C.MOUNTING

VS2-VS3



SPDT

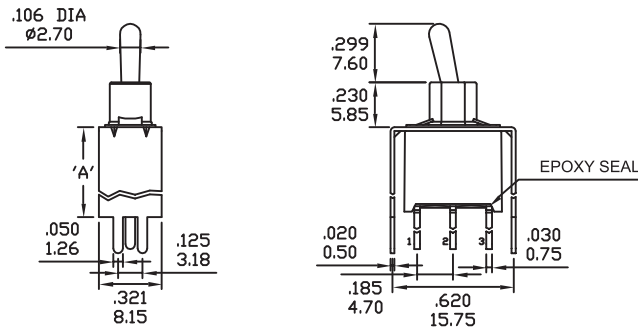

P.C.MOUNTING

OPTION CODE	DIM. 'A'
VS2	.461 11.70
VS3	.630 16.00

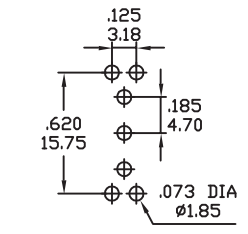

VS2-VS3



DPDT

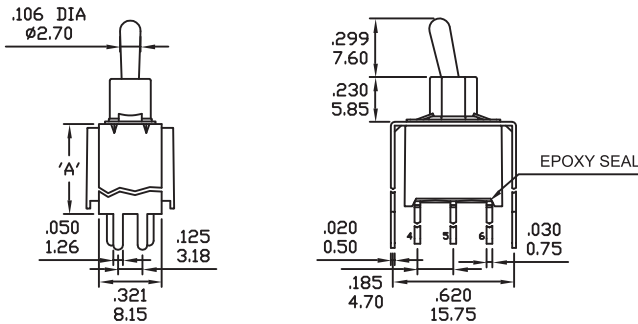

P.C.MOUNTING

OPTION CODE	DIM. 'A'
VS2	.461 11.70
VS3	.630 16.00

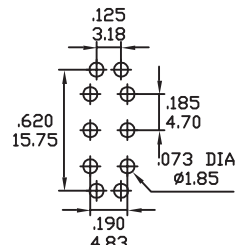

U2-VS3



3PDT

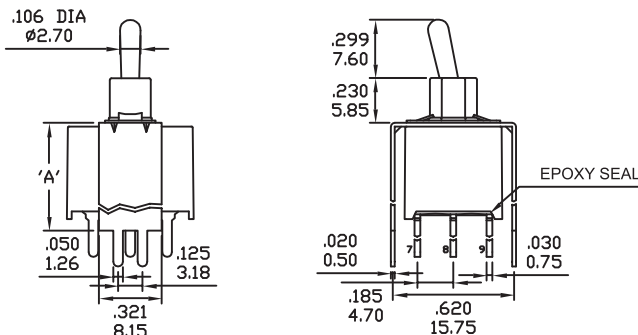

P.C.MOUNTING

OPTION CODE	DIM. 'A'
U2	.551 14.00
VS3	.630 16.00

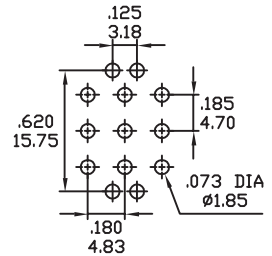

VS4-VS5



SPDT

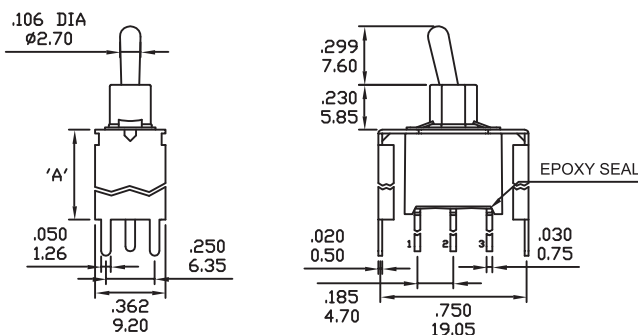

P.C.MOUNTING

OPTION CODE	DIM. 'A'
VS4	.461 11.70
VS5	.630 16.00

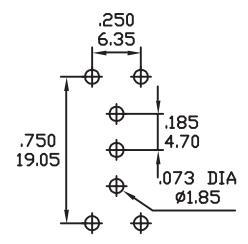

## TERMINATION OPTIONS

### VS4-VS5

### P.C.MOUNTING

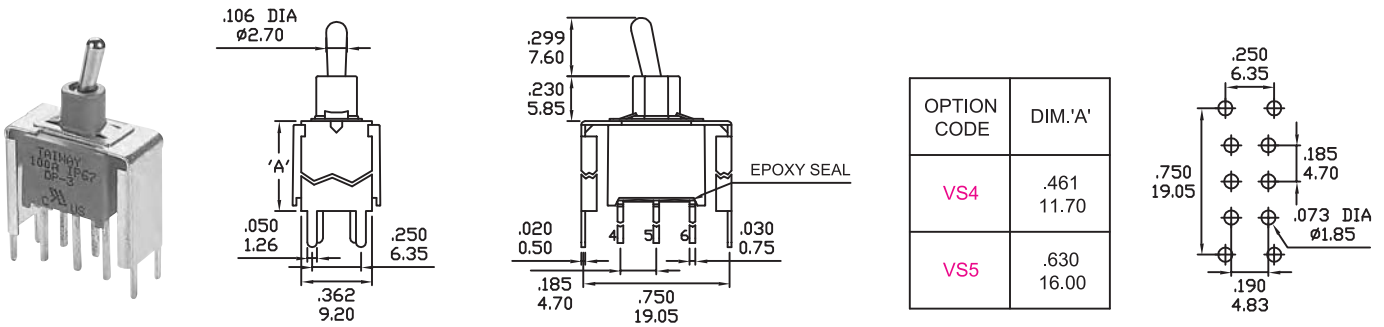

### DPDT

### U4-VS5

### P.C.MOUNTING

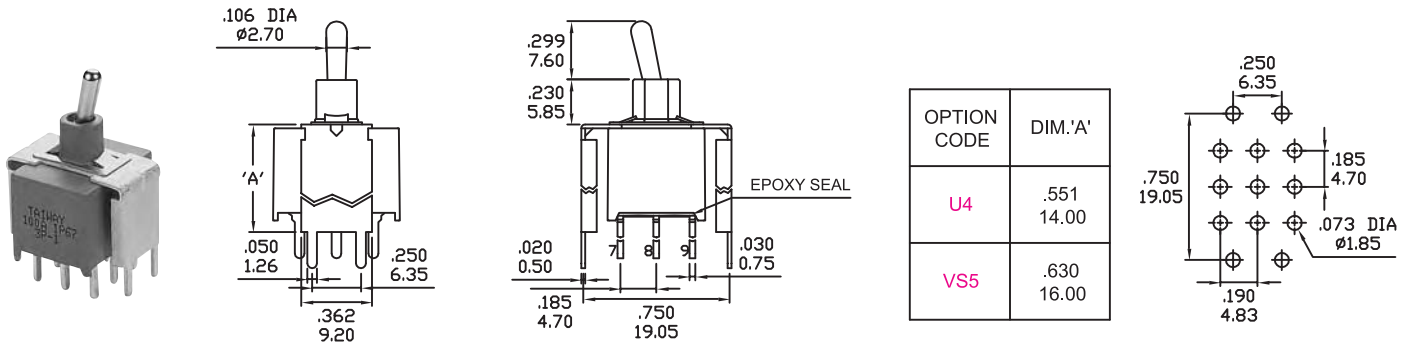

### 3PDT

## SNAP-IN TERMINATION OPTIONS

### M61

### VS21,VS31

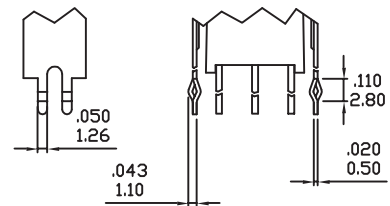
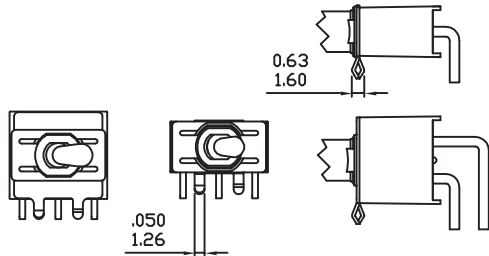

### M71

### VS41,VS51

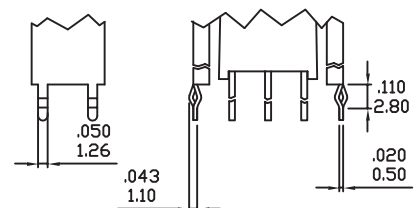
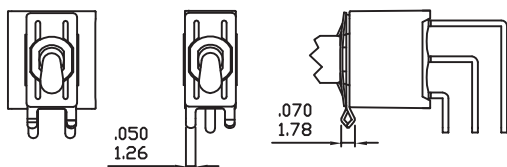

\* PC Mounting for M61,M71,VS21,VS31,VS41,VS51 refer to M6,M7,VS2,VS3,VS4,VS5 respectively.

HARDWARE

NUT

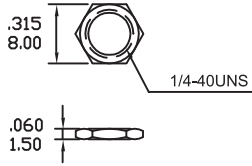

LOCKING RING

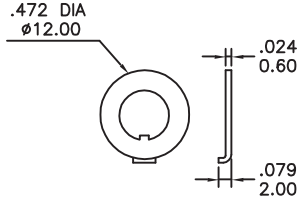

LOCK WASHER

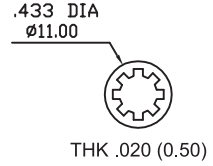

\* Nut, locking ring and lock washer supplied standard with threaded bushings.  
 \* Consult us for optional nut, locking ring and lock washer styles.

CONTACT MATERIAL OPTIONS

Coding	Contact Material	Terminal Plating	Rating	Agency Approvals
G	Silver <sup>1</sup>	Gold over silver <sup>3</sup>	5Amps @ 125VAC or 28VDC 2Amps @ 250VAC	 IP67
P		Tin plated <sup>5</sup> <sup>7</sup>		
R	Gold <sup>2</sup>	Gold plated <sup>4</sup>	0.4VA max @ 20V max (AC or DC)	IP67
K		Tin plated <sup>5</sup> <sup>6</sup>		

\* Standard G plating for sealed product.

1. Movable Contact: Copper alloy, silver plated.
2. Movable Contact: Copper alloy with gold plated over nickel plated.
3. Terminals: Silver plated with outer layer in gold plating.
4. Terminals: Copper alloy, with gold plated over nickel plated.
5. Outer Terminals: Copper alloy with pure tin plated.
6. Terminal Contact: Gold plated over nickel plated.
7. Terminal Contact: Palladium nickel alloy (or Silver) plated.

\* P, K not available with M1 and M3 terminals.

\* 6Amps (Movable Contact: coin silver, silver plated) available to model ON-NONE-ON without UL approval

\* IP67 protection for 100A series only.