

SMSC

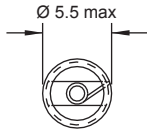
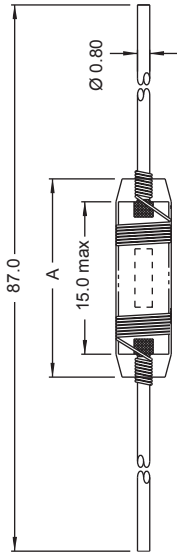
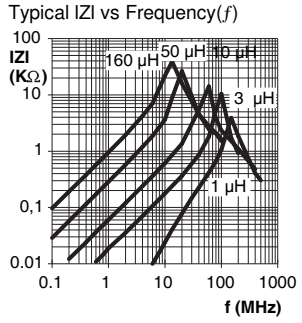

L (μH)	A (max)
1 - 23	17
50 - 160	19

Part No	Inductance L (μH)	f _L (kHz)	Tol ± (%)	DCR max (mΩ)	Rated DC Current (A)
SMSC-1R0M-YY	1	1000	20	14	6
SMSC-2R0M-YY	2	1000	20	24	4
SMSC-3R0M-YY	3	1000	20	46	3
SMSC-6R0M-YY	6	1000	20	144	2
SMSC-100M-YY	10	1000	20	276	1.5
SMSC-230M-YY	23	100	20	876	0.7
SMSC-500M-YY	50	100	20	3600	0.4
SMSC-700M-YY	70	100	20	5400	0.3
SMSC-161M-YY	160	100	20	21600	0.15

Material : Iron Dust

SPQ :

Packing Form	Reel
Axial	1500 [-01]

Remark : - Available also without insulating material (SMSC/B)
- Loose packing [-00] available on request

All dimensions in mm

Suppression Coils