

		PART NUMBERS	A	B	∅ min.	∅ max.
16A	2P+⊕	PE 16x3 PV	146	74,5	7	16
	3P+⊕	PE 16x4 PV	146	84,5	7	16
	3P+N+⊕	PE 16x5 PV	146	92,5	8	24
32A	2P+⊕	PE 32x3 PV	163	102	8	24
	3P+⊕	PE 32x4 PV	163	102	8	24
	3P+N+⊕	PE 32x5 PV	163	105	8	24

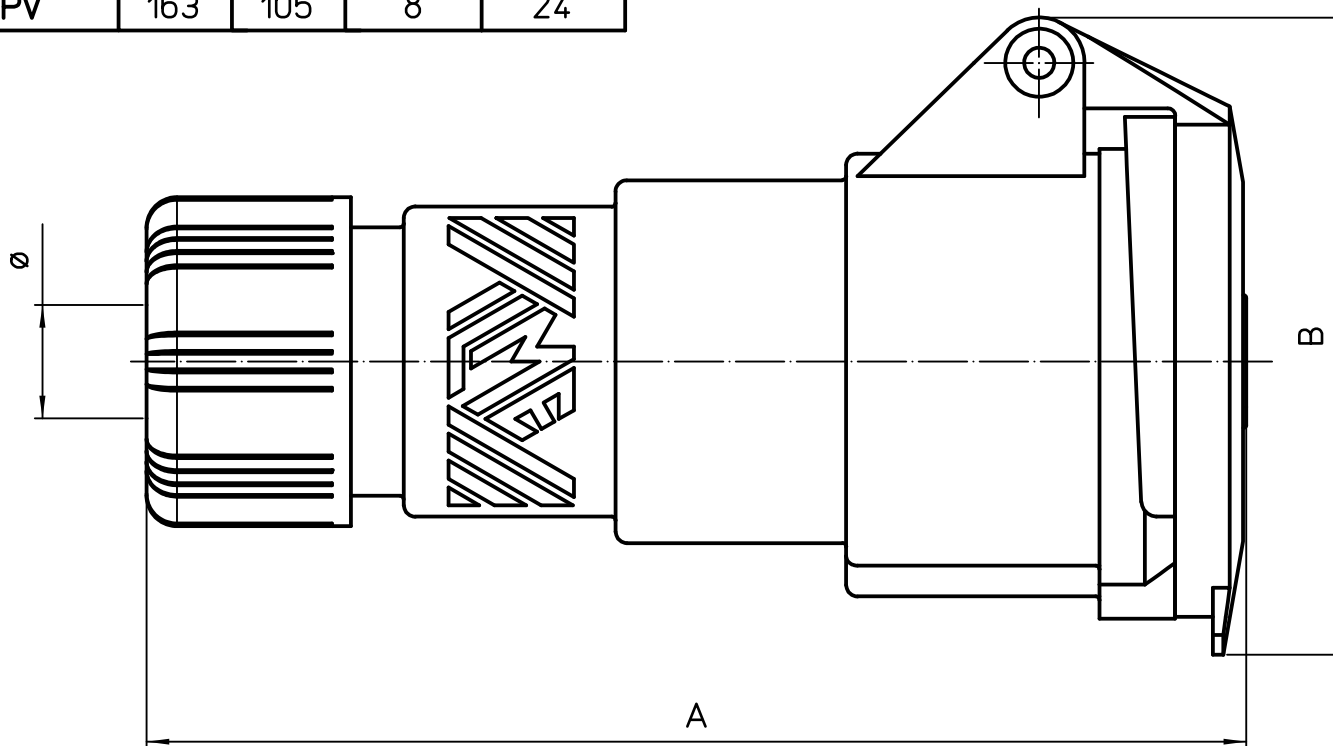

dimensions in mm		PE PV		Scale	
Date 23/04/10		socket 16/32A			
Sign. Visentin				