

Series 1075 • 1075/G

- For use in burn-in and run-in test
- Transmission of high currents
- Low contact resistance

Mechanical Data

| | |
|--------------------------------|---------------------------|
| Center | 5.00 mm/197 mil |
| Full Travel | 5.50 (10.00 byCLX) mm |
| Working Travel | 4.40 (8.00 byCLX) mm |
| Pre-loaded Spring Force | 0.80/ 1.50/ 1.50/ 2.50 N |
| Spring Force at Working Travel | 3.00/ 3.00/ 5.00/ 10.00 N |

Electrical Data

| | |
|-------------------------------|-----------|
| Max. Current Rating | 50.0 A |
| Typical Continuity Resistance | <= 5 mOhm |

Materials

| | |
|------------|--------------------------------|
| Barrel | Brass, gold plated |
| Spring | Stainless Steel, silver plated |
| Plunger | CuBe, gold plated/Silver Cap |
| Receptacle | Brass, gold plated |

Recommended Diameter of Drill

| mit Receptacle | |
|----------------------|----------------|
| HP 2361.1 (Trolitax) | 3.98...3.99 mm |
| HGW 2372 | 3.49...3.50 mm |

Tip style - Diameter - Plating



| AX | A6X | CLX | CX | DNX |
|----------|----------|----------|----------------------|----------|
| 4.00C Au | 3.00C Au | 4.00C Au | 3.00C Au 4.00C Au | 4.00C Ag |

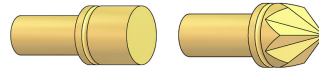

| FX | KX |
|----------|----------|
| 4.00C Au | 3.00C Au |

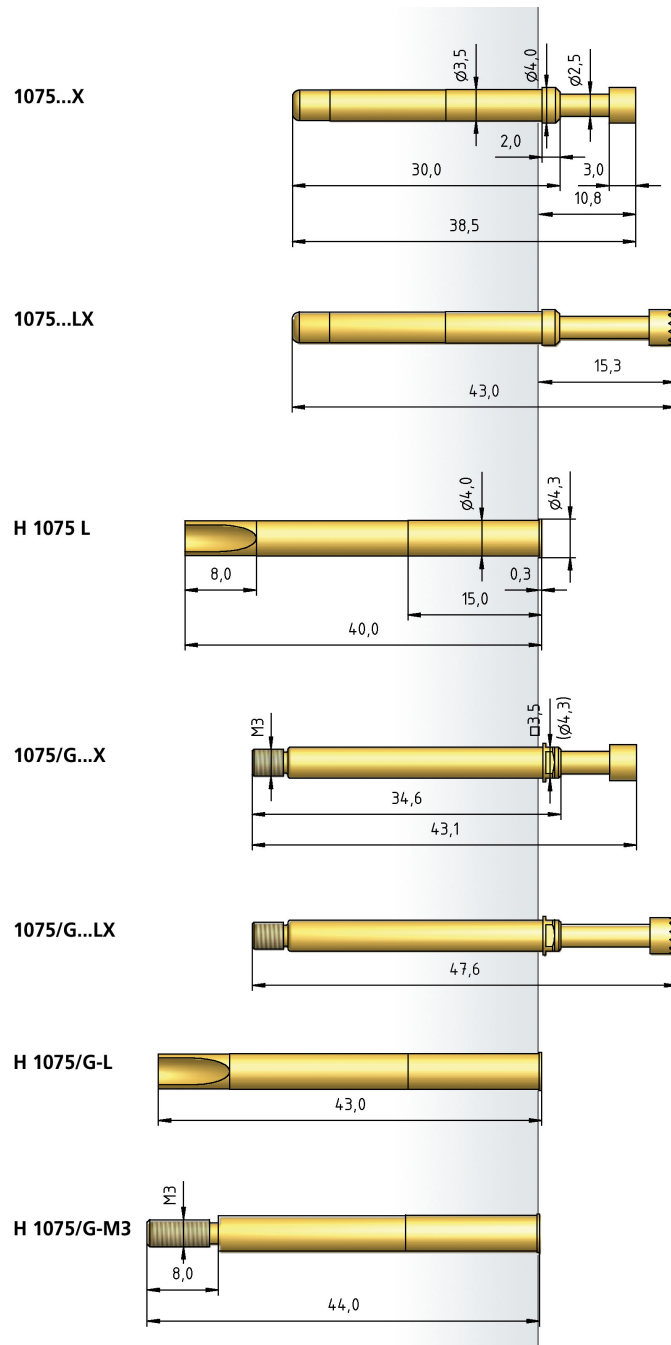

How to Order

| 1075/ | G | FX | 3.0 N | Au | 4.0 | C |
|-------|---|----|-------|----|-----|---|
| 1 | 2 | 3 | 4 | 5 | 6 | 7 |

1. Series 2. Threaded Design 3. Tip Style
4. Spring Force 5. Tip Plating 6. Tip Diameter
7. Tip Material (only for CuBe)